

CROFTS 40 AND 33 LONEMORE CROFTING TOWNSHIP.

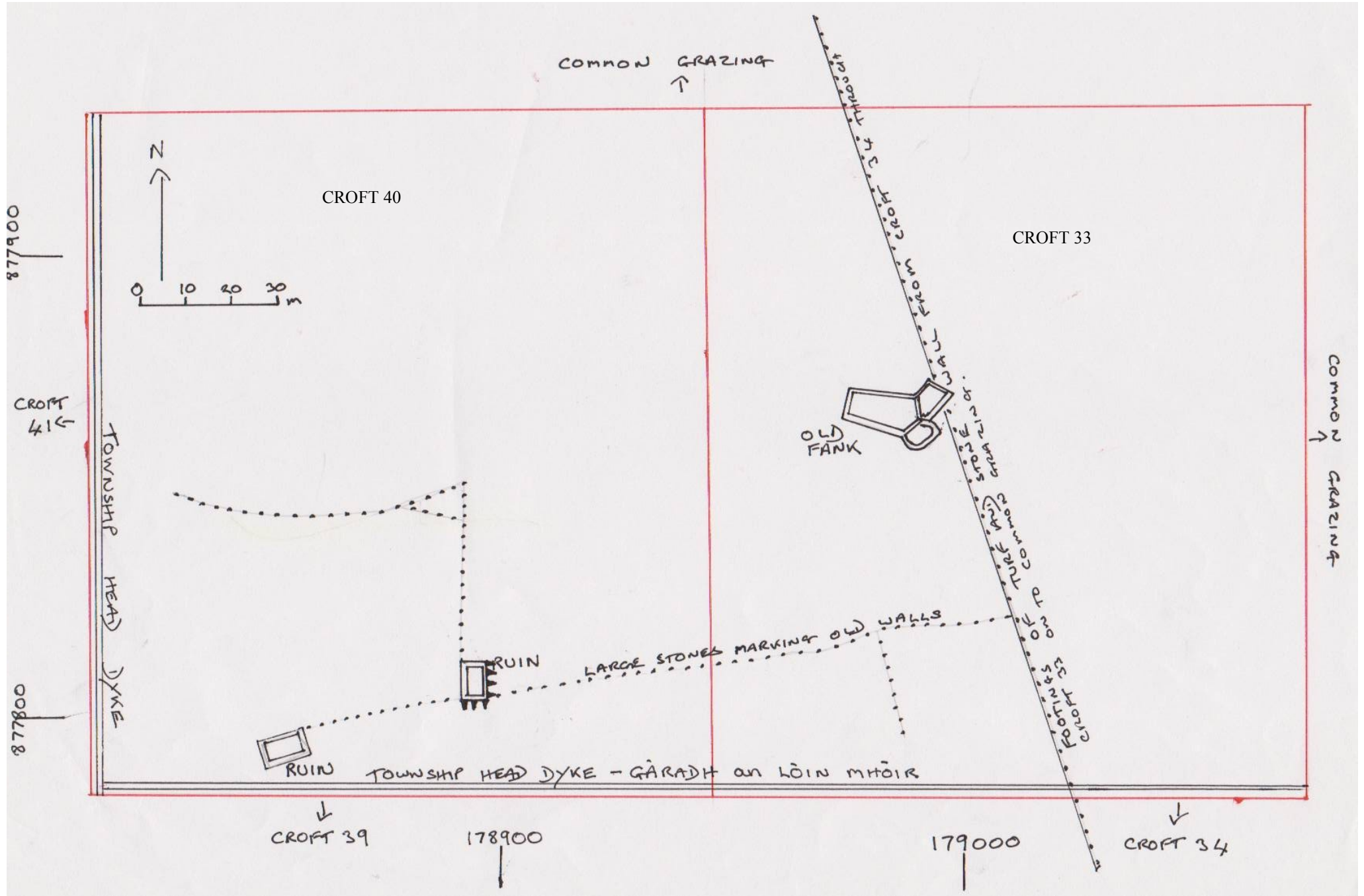

CROFTS 40 AND 33 LONEMORE TOWNSHIP.

These two crofts ,although designated and given a total acreage of 11 acres on the estate map ,were not included inside the township head dyke probably due to the extremely poor quality of the ground considered to be unsuitable for either good grazing or arable use.

There are lines of large stones/boulders marking pre crofting walls and the visible line of an old turf and stone dyke stretching through the crofts up onto the common grazing (see plan) To the W side of croft 40 and along the S boundary of both crofts runs the township head dyke.

On croft 33 lie the ruins of the old sheep fank, which contain the robbed ruins of a house and some footings of a circular structure with very large boulders and smaller boulders making a curved structure. (see plan)

On croft 40 are the ruins of two precrofting buildings. One lies just N of the dyke and is shown as unroofed on both the first and second OS.(see description). The other, from its structure, is a much older building and is un-

marked on either map.

(see description).
Only sheep graze the land now.



OLD WALLS ON CROFTS 40 AND 33

RUIN ON CROFT 40. NG 78889 77796
FUNCTION: PRE CROFTING BUILDING
ELEVATION 62M
SURVEYED ON 26-07-08

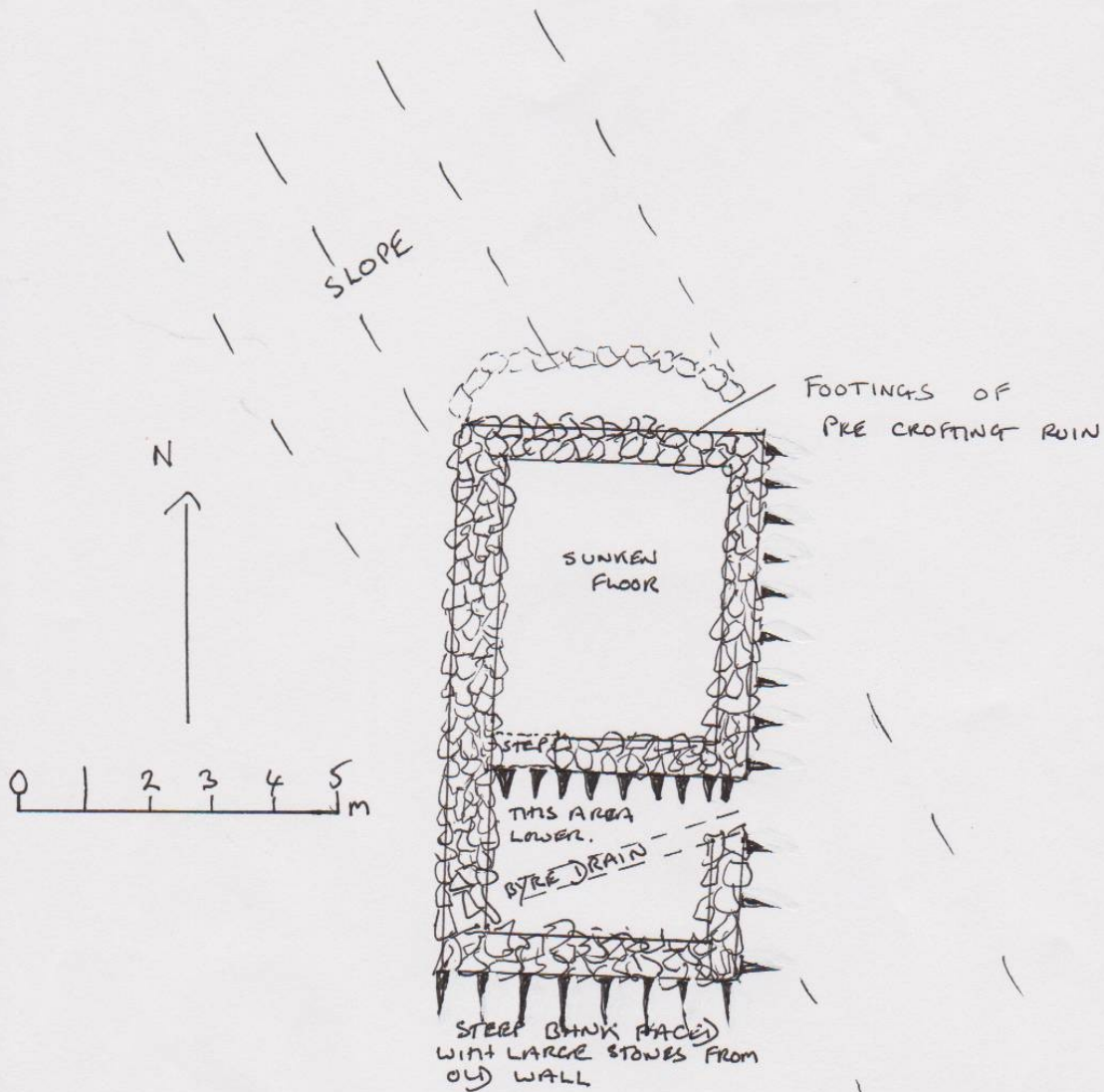

RUIN ON CROFT 40 LONEMORE TOWNSHIP

This ruin is situated on a slope with man made steep banks on its S and E sides. It has a southerly aspect overlooking Loch Gairloch.

All that remains are the footings of the walls and therefore no evidence of windows or doors although there is an opening on the E side. Into this opening runs a drain from the lower part of the building. The S half of the building is on a lower level than the N side.

There are small boulders marking the footings of an internal division with a gap for a step on the W side.

There are no selected or dressed stones evident just a selection of boulders.

The floor level is lower than the walls in both parts of the building.

Large boulders run along the S bank and these are part of a precrofting wall that runs through crofts 40 and 33.

This building is not shown on any OS map, but is shown on the estate map, so predates the crofts.



S edge of building with old wall extending into distance

S edge of building showing large boulders



RUIN JUST BEYOND TOWNSHIP HEAD DYKE, LONEMORE GAIRLOCH.
 NG 78852 77782 GPS ELEVATION 53M FUNCTION NOT KNOWN
 SURVEYED ON 26-07-2008

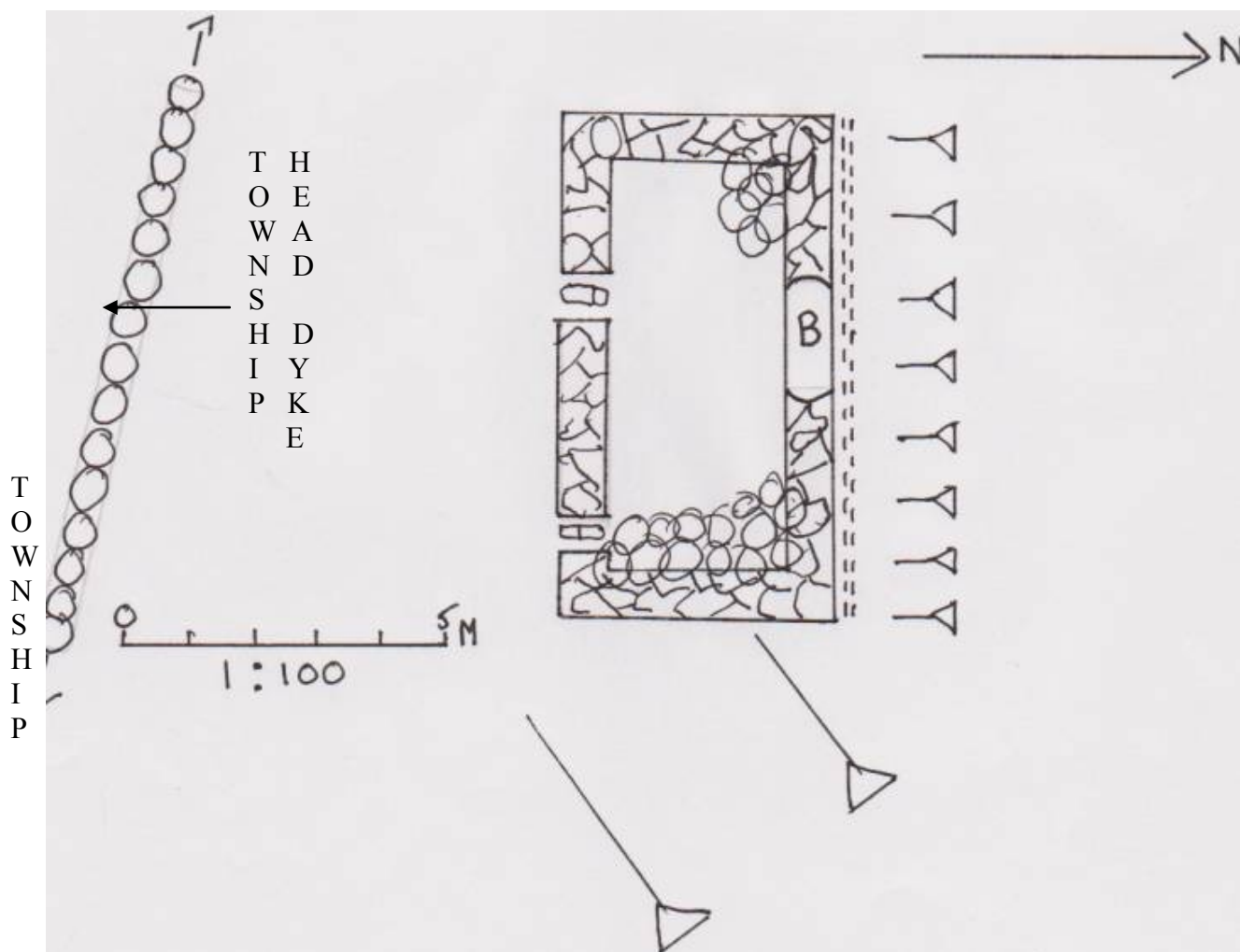

This ruin shown as unroofed on both the first and second OS maps lies just outside the Township Head Dyke. It has a southerly aspect on a gentle N to S slope. Just behind the N wall of the ruin is a ditch.

The remaining walls are constructed of boulders and some selected stone with smaller stones as infill.

On the N wall, and spanning the full width of the wall is a large boulder measuring 1.75mx0.75m which is part of a pre crofting wall which runs on a W to E axis ,extending in both directions from the ruin. There are other similar walls on this croft.

The walls in the ruin are up to 0.75m in height, and there are two possible openings on the S wall. No evidence of windows can be seen in the ruin, and there is tumble inside the walls at both the NW corner and along its E wall.

Floor level inside the ruin is the same as the external ground.

LARGE BOULDER IN NORTHERN WALL OF RUIN NG78852 77782 GPS



SAME RUIN SHOWING ITS PROXIMITY TO TOWNSHIP HEAD DYKE



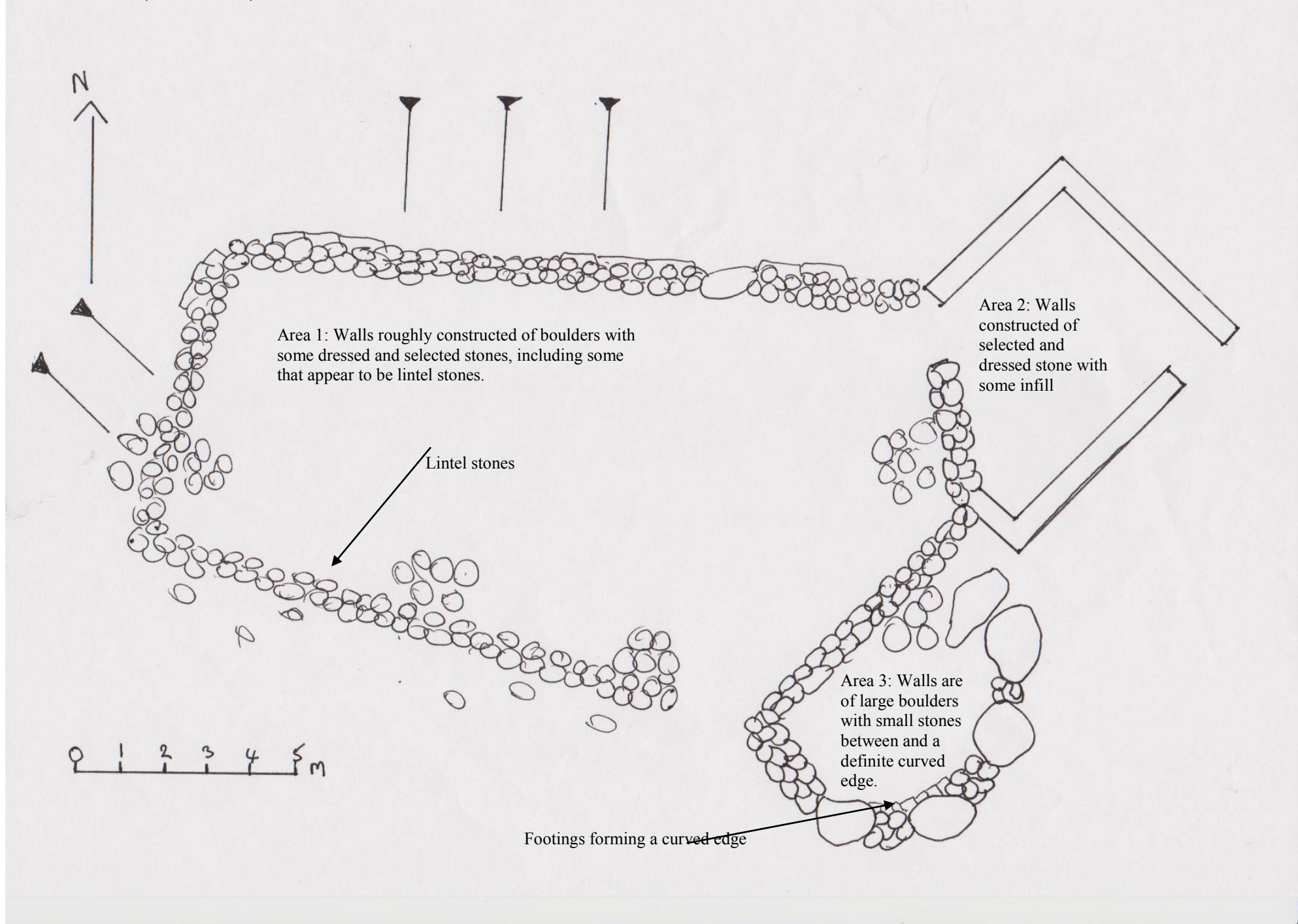

OLD SHEEP FANK CROFT 33 LONEMORE CROFTING TOWNSHIP. NG 78987 77855 GPS.

The old sheep fank is situated on what was designated croft 33, although the croft was not included within the head dyke as the ground was unsuitable for cultivation. consisting of heather, moss and rough grass. It is shown on both the first and second OS as a circular structure unlike its present construction (see plan) It is situated on a drier piece of ground that slopes gently from N to S at an elevation of 64m. There is no adjacent water supply to the fank, the nearest being two wells/springs lying 320m to the NW.



Photo and aerial photo showing old sheep fank.

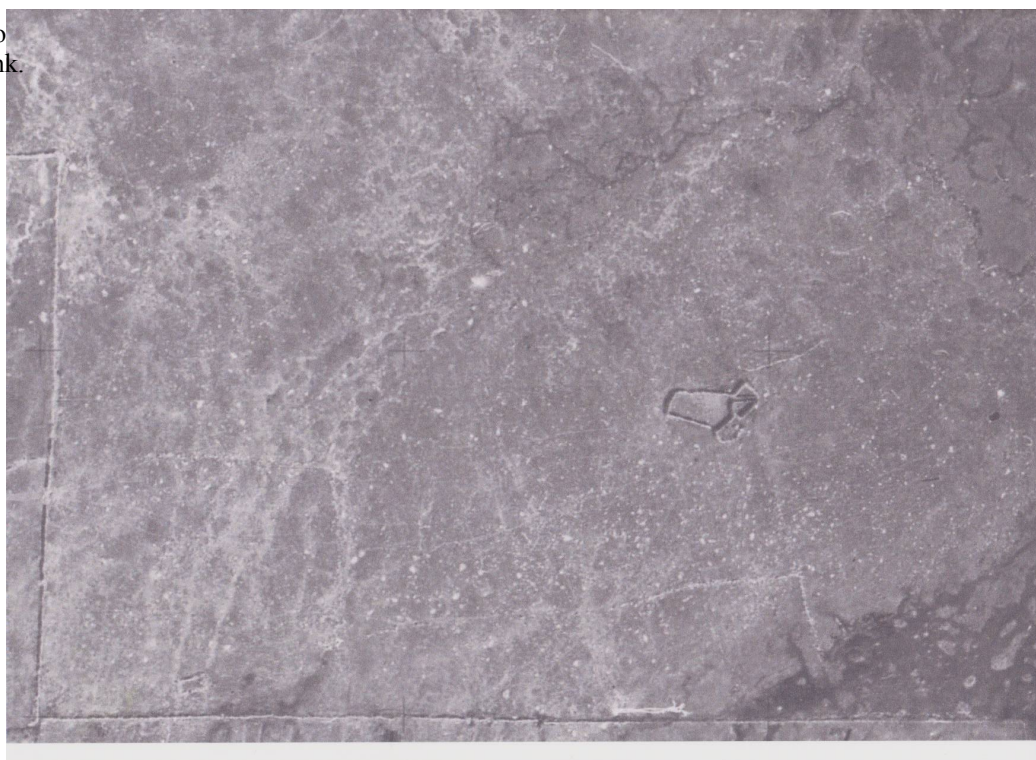

OLD SHEEP FANK CROFT 33 LONEMORE TOWNSHIP

The fank comprises three adjoining but different areas of construction.

Area 1 is roughly constructed of boulders with occasional selected and dressed stones including what appears to be lintels amongst them. The walls are broken down and range in height from 0.5m to 1.5m with an average width of 0.40m.

Area 2 has walls that are constructed with dressed and selected stones with infill. They range in height from 1.0m to 1.40m, with an average width of 0.55m.

Area 3 has walls consisting of large boulders with diameters up to 1.5m with smaller stones in between these. These are arranged in a circular pattern and there is a definite line of edging footings on the S side of the area, emphasising the curve.

Showing apparent lintel stones in boulder wall area 1



Showing contrast between boulder wall Area 1

And

Selected and dressed stone in area 2



Showing areas of boulder wall in area 1, wall in area 2, and boulder circle in area 3

OLD SHEEP FANK CROFT 33 LONEMORE TOWNSHIP.

The census and estate records record a family paying rent for croft 33 from 1841 to 1871 and living on the croft in 1861 and 1871. As there is no evidence of any other buildings on this croft it is possible that area 2 was part of a house that was later robbed to form part of the walls in area 1. Area 3 although a definite circular shape, does not have any obvious function. It may have been used for storing fleeces, or as a spring time henhouse, or may have even been part of a stone circle that was used as the circular sheep fank shown on early OS, and later altered when the house and newer fank were constructed.

Local knowledge indicates that the fank was not used for dipping sheep after the 1940's due to the lack of water, with the sheep being taken to a newer fank on Mihol Township. However it continued to be used for dosing, and shearing sheep until the 1970's, and still proves a useful shelter for the occasional lambing.