

CROFT 34 LONEMORE CROFTING TOWNSHIP.
CENTERED ON NG 179010 877710

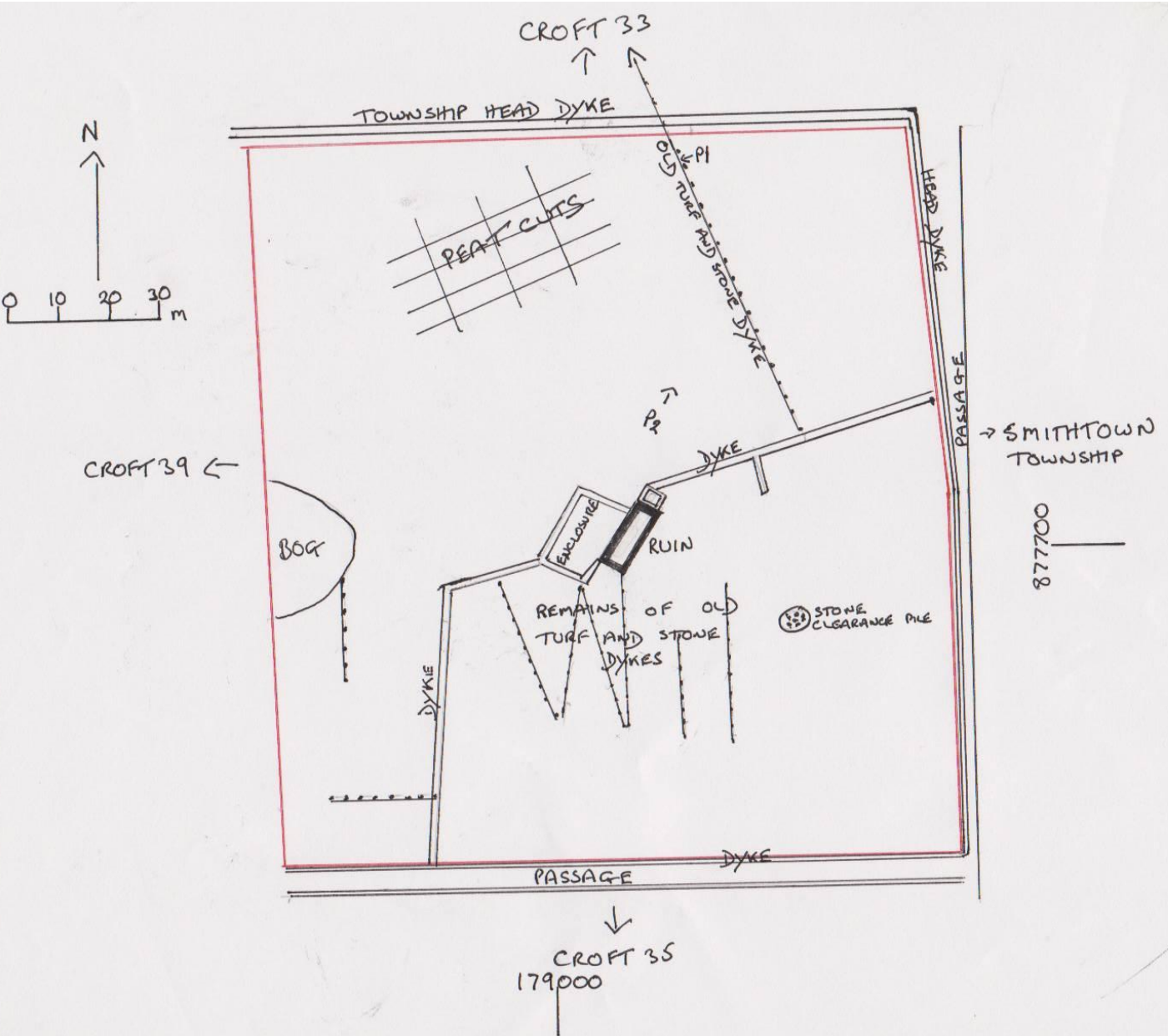

CROFT 34 LONEMORE TOWNSHIP

Croft 34 is no longer used for either pasture or arable cultivation. The ground is very boggy, made worse by old peat cuts, and covered with rushes and moss. (picture 1)

There is the substantial ruin of an old croft house, shown as roofed on both the first and second edition OS which has an enclosure to the rear and a smaller building to the side. (separate description)

Running from these buildings to the S and E boundaries of the croft are croft dykes comprising boulders and stones of varying sizes up to a height of 1.5m. There are also some footings of older turf and stone dykes as marked on the plan. (picture 2)

The croft has an acreage of approximately 4.5 acres according to the estate map

The township head dyke runs along the N and E boundaries of the croft and there is a passage to the S. And E of the croft.



Old peat cuts on croft 34



Footings of older turf and stone dyke croft 34

RUIN ON CROFT 34 LONEMORE TOWNSHIP
 NG 79020 77697 GPS.ELEVATION 55M
 FUNCTION HOUSE WITH SHED/BYRE
 SURVEYED 08-08-2008

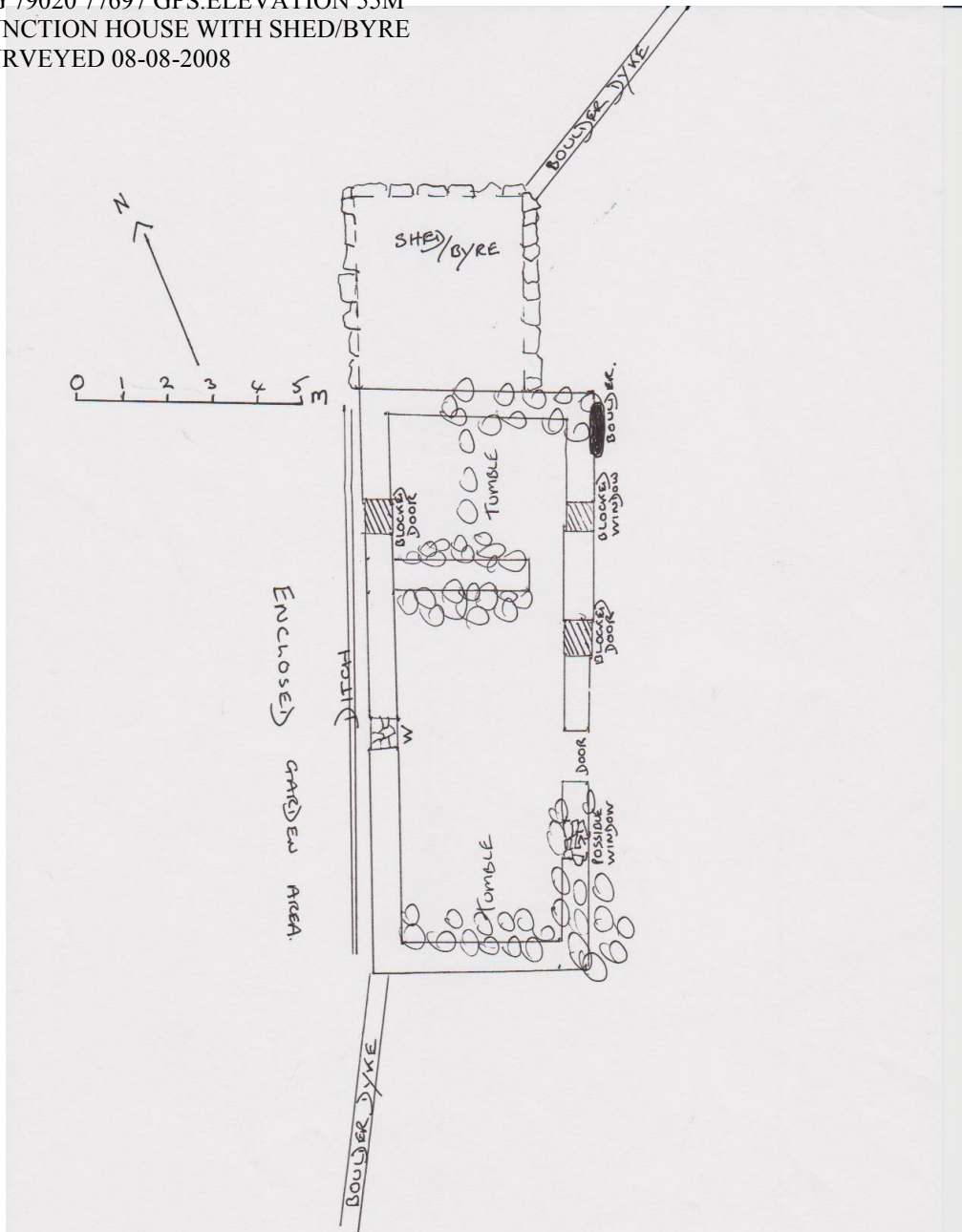

This unroofed ruin is situated on a flat area of ground with an open aspect to the SE. It is shown as roofed on both the first and second OS.

The walls show evidence of being well constructed with dressed and selected stone, and infill, with some snecking, although they are now ruinous with a lot of tumble. They range in height from 0.9 to 1.64m with an average thickness of 0.60m. There is a large grounded boulder at the base of the NE wall. There is one dividing wall within the ruin with a window and blocked doorway on the W wall and one blocked doorway and window, an open doorway and a ruinous window on the E wall.

The walls of the shed/byre attached to the N end of the building are made of selected stone and boulders, and very broken down. No entrance is visible under the tumble.

Behind the W wall is a ditch.

Inside the ruin is a lintel stone, and an interior wall which is tumbled, but is thick which could indicate that the building was extended at some time, making this the original exterior wall.

Behind the ruin is an enclosure/garden area measuring 12x17m. The walls are made with boulders, some covered with turf and up to 1m high.

Running from the shed/byre in a NE direction to the croft boundary is another boulder wall. There is no visible evidence of any fireplace, drains, or lowered floor areas within the ruin, although the tumbled S wall would be the probable site of any chimney.

RUIN ON CROFT 34 LONEMORE CROFTING TOWNSHIP NG 79020 77697 GPS



LOOKING DOWN ON RUIN FROM SW CORNER SHOWING GOOD WALL CONSTRUCTION.



ILLUSTRATION OF DETAIL IN SNECKING IN WALLS

RUIN ON CROFT 34 LONEMORE CROFTING TOWNSHIP NG 79020 77697 GPS



WALL EXTENDING N TOWARDS CROFT BOUNDARY



WALLS BEHIND THE RUIN ENCLOSING GARDEN AREA.