

CROFT 41 LONEMORE CROFTING TOWNSHIP

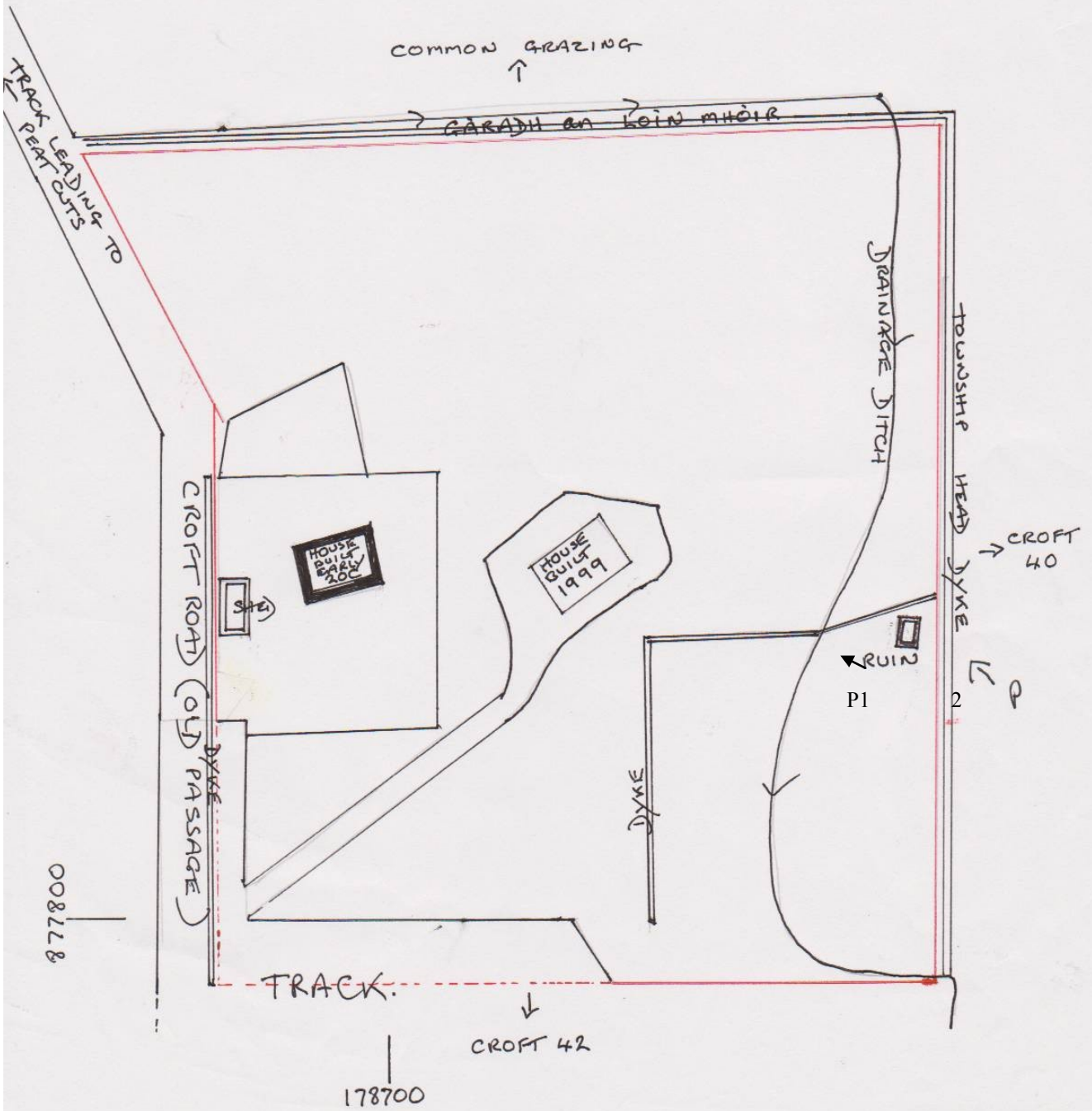
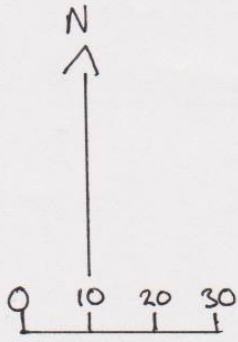

CROFT 41 LONEMORE TOWNSHIP.

This croft is shown on the estate map as having 5.5 acres. There is no crofting now as the croft is under mainly rough garden ground.

Three buildings are shown as roofed on both the first and second OS. The two larger ones are still in use today, as a house that has been modernised and is used as a holiday home, and as a shed. (see plan). The third one has disappeared under a modern house built in 1999.

Within the croft there is a stone dyke that is shown on both editions of the OS (see picture)



STONE DYKE SHOWN ON FIRST AND SECOND EDITIONS OF OS MAPS MARKED ON PLAN

At the E side of the croft is a small ruinous building 4x5m and 1m high. This is not marked on any OS map.



SMALL RUIN ON E SIDE OF CROFT

CROFT 41 LONEMORE TOWNSHIP

The N and E boundaries of the croft are marked by the township head dyke, which is most intact on the E side (see picture)



TOWNSHIP HEAD DYKE ON E BOUNDARY OF CROFT

To the W of the croft runs a passage now upgraded to a croft road which leads out to the old peat cuts on the common grazing. The S boundary is marked by a track leading to other housing. There was no evidence of the well marked on the second OS, however a large drainage ditch has been dug, running N to S, at the time of the new house construction and this probably includes the well.