

CROFT 42 LONEMORE CROFTING TOWNSHIP.

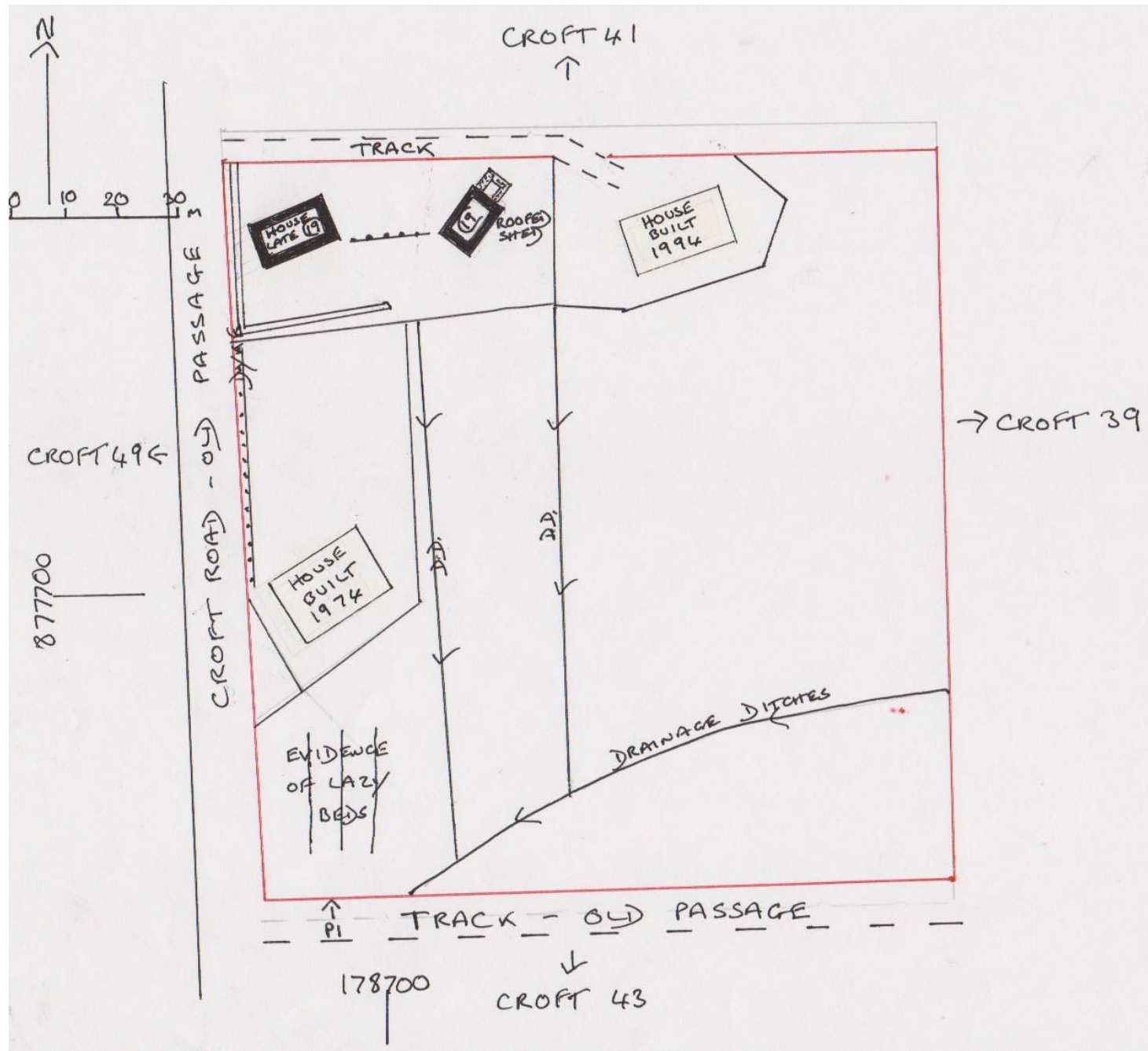

## CROFT 42 LONEMORE TOWNSHIP.

The ground on croft 42 is mainly grass used for occasionally grazing sheep. It is well drained with large drainage ditches to carry away the excess water. (see plan).

The first OS shows 2 roofed buildings on the croft of which one (78730 77770) is still roofed and used as a shed, and the other having disappeared under a house built in 1994. On the second OS another roofed building (78680 77770) is marked and this is still an occupied dwelling house for holiday lets. There is a further modern house (78690 77700) built in 1974.

The croft is marked on estate records as being 4.5 acres.

There is visible evidence of lazy beds in the SW corner of the croft (picture 1)

There was no definite sign of the well marked on the second OS map.

The W and S boundaries of the croft run parallel with access passages of the township. The W passage is now one of the roads through the township, and the S one a track providing access to other houses.



Evidence of lazy beds on croft 42. In the distance can be seen the 19th century building now used as a shed.