

CROFT 43, LONEMORE CROFTING TOWNSHIP.

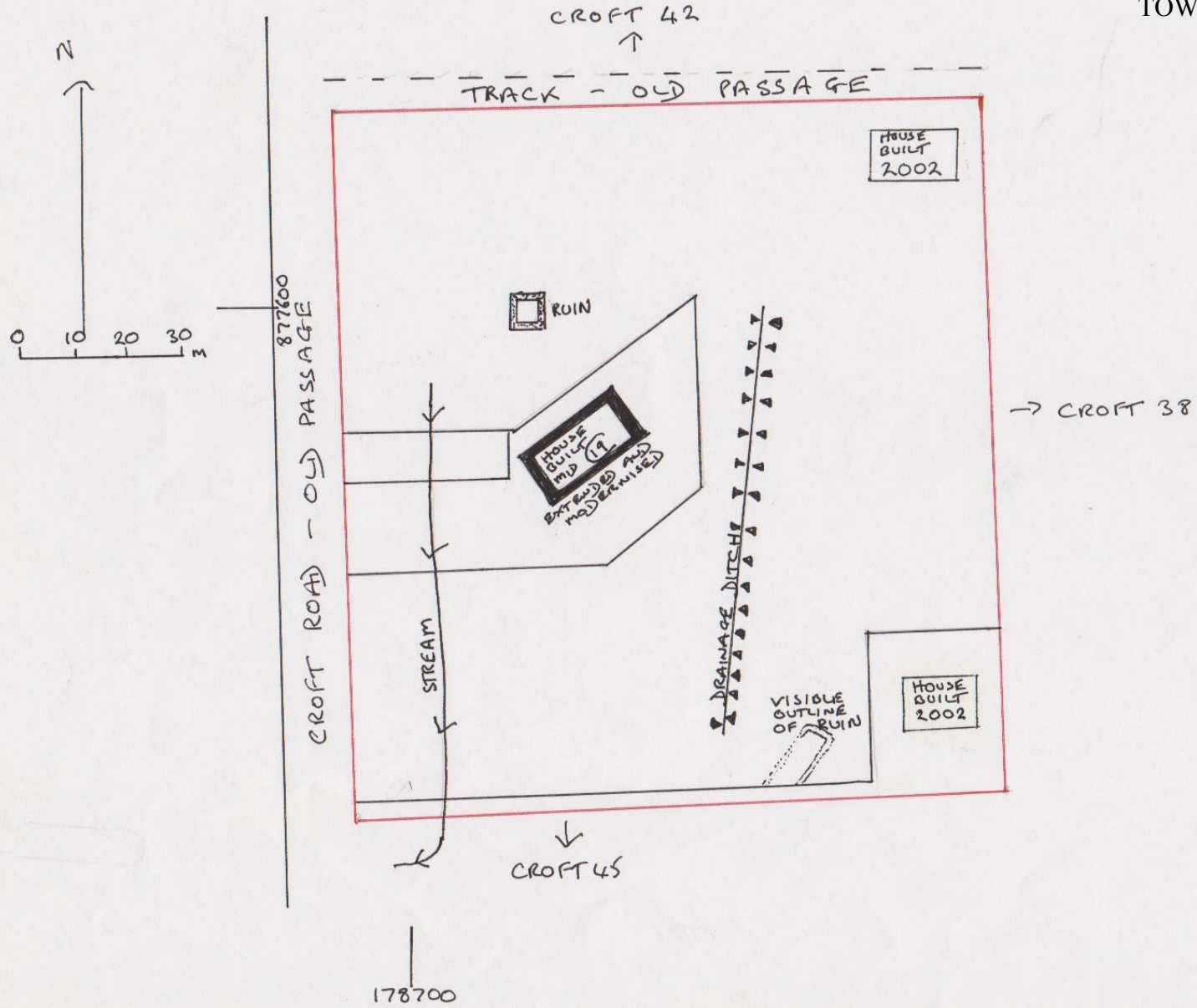

CROFT 43 LONEMORE CROFTING TOWNSHIP

To day the croft is a mixture of grass and rushes that are grazed occasionally by sheep and cattle, A large drainage ditch helps to drain the land.

In the centre of the croft and shown as roofed on both the first and second OS, is a stone built croft house. This has now been harled, extended, and modernised and is still permanently occupied.

To the N of this house is a small ruin, also shown as roofed on both OS maps. It is built of boulders and selected stones with remaining walls up to 0.75m in height.

The well shown on the OS maps was not found but the ground in that area and around the small ruin is extremely boggy.

In the SE corner of the croft is a modern house built in 2002, There is also the faint outline of a building marked as roofed on the first and second editions of the OS. This was demolished and the stone used in a new house in Smithstown township. In the NE of the croft is another modern house built in 2002.

Along the W edge of the croft runs an old passage now made up to a croft road. Along the N edge is another passage which is a track running to houses.