

CROFT 49, LONEMORE CROFTING TOWNSHIP

49

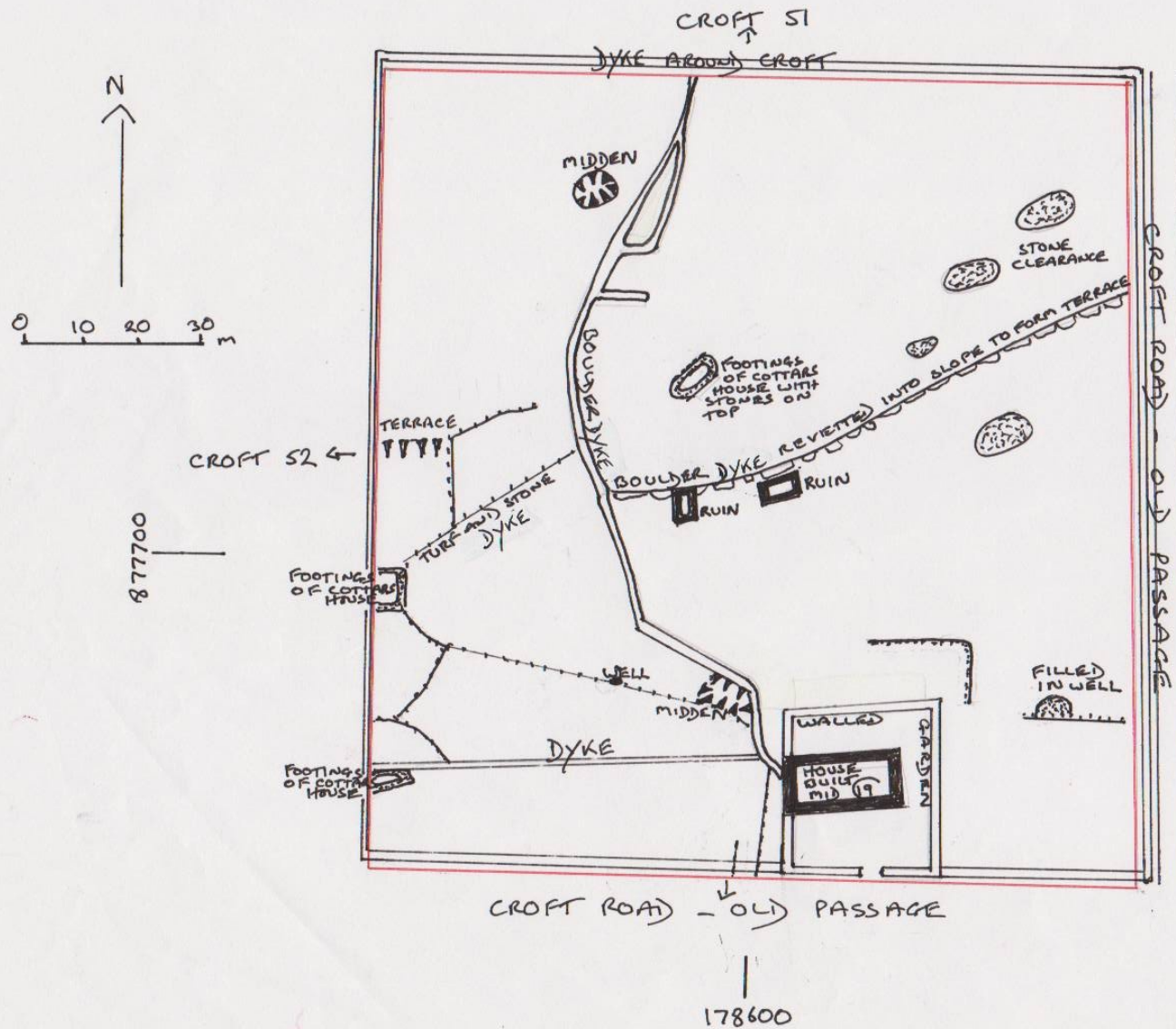

CROFT 49 LONEMORE CROFTING TOWNSHIP

This croft is given an acreage of 4.5 on the estate map. It is on a slope and fairly well drained except in the SE corner where there is a filled in well. (78656 77768). There is another well at (78574 77678) which still has a structure and contains water (see picture)



This was a well worked croft as is evident from all the remaining stone dykes and footings of turf and stone dykes. There are also two circular hollows which may have been middens. (see plan)



POSSIBLE MIDDEN

CROFT 49 LONEMORE CROFTING TOWNSHIP.

On the croft there are several footings of older, small cottars houses which have been covered with field clearance stones. There are also some piles of stone clearance. Two ruins below the stone dyke that runs NE to SW are described in separate descriptions. The larger of these is shown as roofed on both the first and second OS, with the other unmarked on any OS. The dyke is also shown on the OS maps.

A stone house built in the mid 19th century, that is surrounded by a walled garden is still occupied. On the first and second OS there is a building just N of this but it is on the wrong axis so it must have been demolished, and another built.

These are all shown on the plan.

The croft has croft roads which were passages on its S and E boundaries.

The croft is used for occasionally grazing sheep.

RUINS ON CROFT 49 LONEMORE TOWNSHIP. 78597 77700 AND 78606 77706 GPS. FUNCTION HENHOUSE AND SHED
ELEVATION 46 AND 49 M SURVEYED ON 06-12-08.

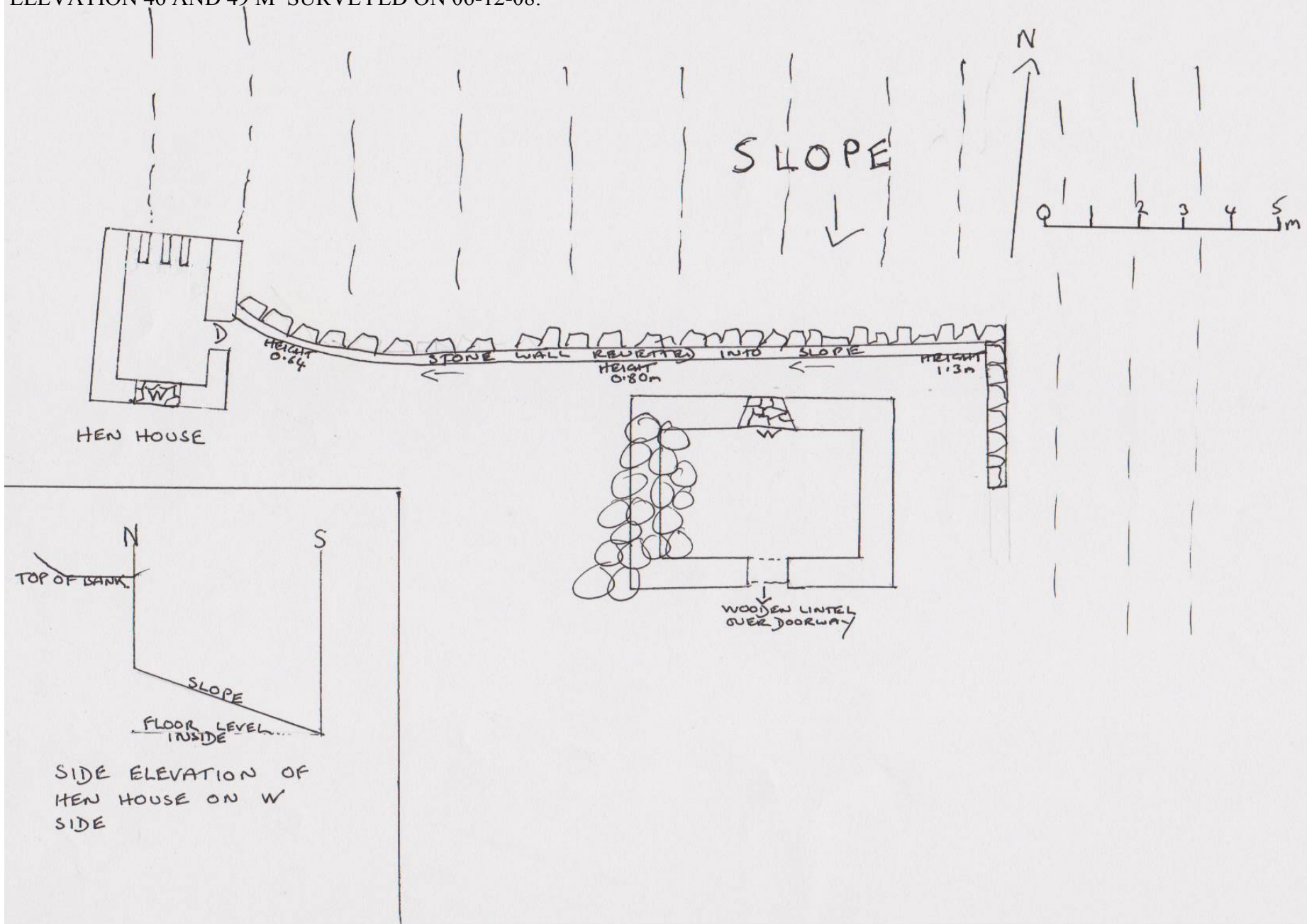

RUINS ON CROFT 49 LONEMORE TOWNSHIP

These two ruins have a southerly aspect and are situated on a level area of ground immediately S of a substantial stone wall that is revetted into the hillside, to stop the slope from collapsing onto the buildings and forming a terrace behind them.



THE RETAINING WALL BEHIND THE SHED WITH THE HENHOUSE IN THE BACKGROUND.

The wall ranges in height from 1.3m to 0.64m, sloping towards the henhouse. It is made of small boulders and selected stones and is shown on both the first and second OS maps.

The E ruin was known to have been a shed where walking sticks were made. It is well made of dressed stone that has been layered, with snecking, and has been partially harled. The walls are 0.60m thick and up to 2.30m high on the N wall. There is a doorway on the S wall with a wooden lintel, and a window in the N. wall facing onto the stone wall. The shed is unroofed but must have had a flat roof as the walls slope from N to S (see picture), with no gables. It is still in very sound condition except for the W wall which is broken down with a lot of tumble. This ruin is shown as roofed on both the first and second OS

The W ruin is a henhouse, unroofed, but still in very good condition with no tumble. It is made of dressed and selected stone with walls 0.50m thick. The height of the walls on the W and E walls is 1.40m and on the gable ends at N and S 2.22m. The henhouse is built into the natural slope, with part of the external sides of the W and N wall being covered by the bank. (picture) The 4 nesting boxes are situated in the structure of the rear N wall. (picture) They have a depth of 0.40m, a height of 0.30m, and are 0.60m off the floor. There is an entrance on the E wall, and a window on the S wall. This ruin is not shown on any OS map.

RUINS ON CROFT 49 LONEMORE TOWNSHIP

RUIN OF SHED CROFT 49



DOORWAY WITH WOODEN LINTEL



TUMBLE ON W WALL OF SHED

RUINS ON CROFT 49 LONEMORE TOWNSHIP



THE HENHOUSE SHOWING S AND E WALLS



THE HENHOUSE SHOWING W AND S WALLS



THE NESTING BOXES