

CROFT 53 LONEMORE CROFTING TOWNSHIP

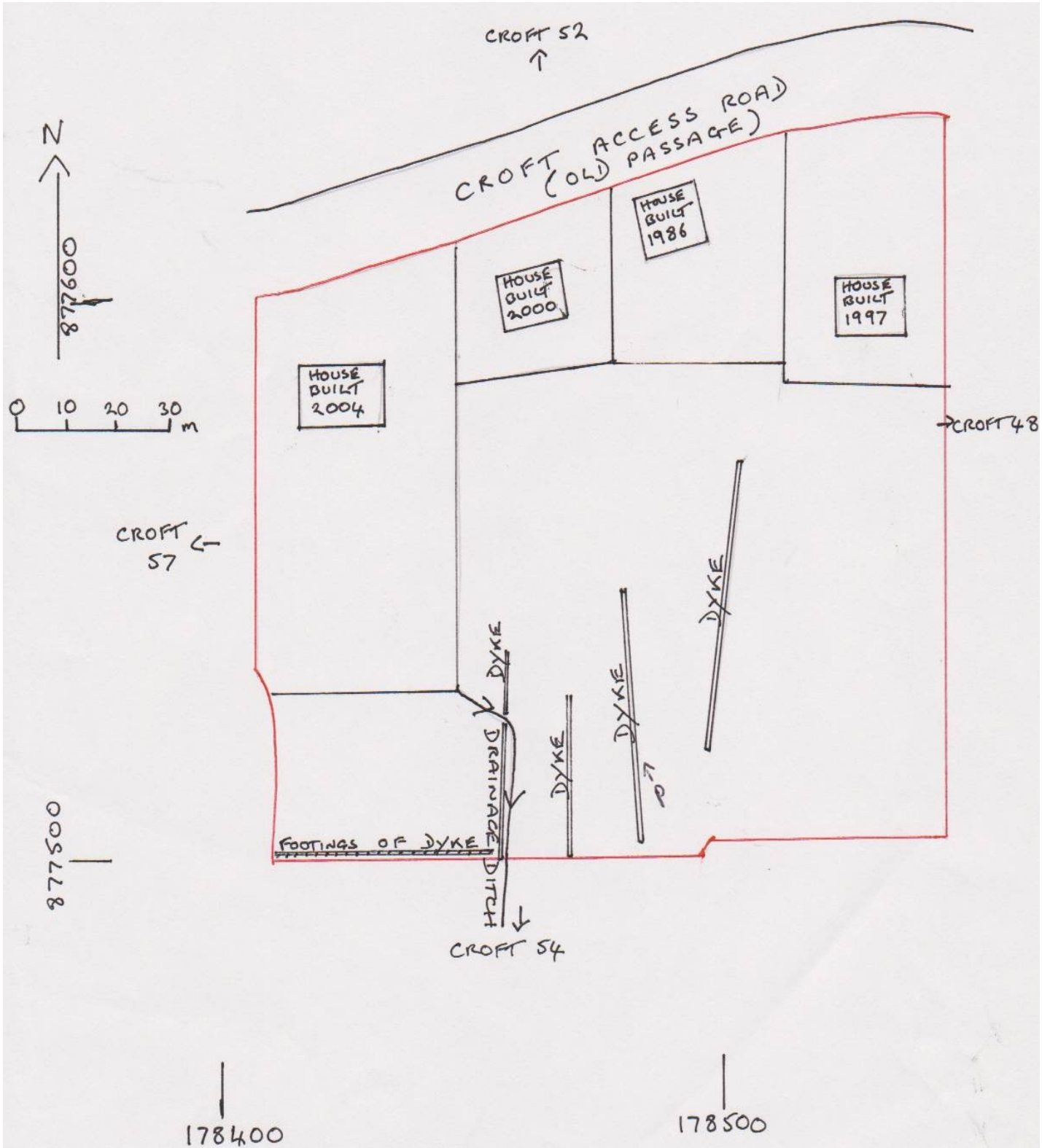

## CROFT 53 LONEMORE TOWNSHIP

The estate map shows that croft 53 had an acreage of 4.5 .Today most of the croft is included in the garden areas of the 4 new houses built in 1986,1997,2000,and 2004 ( see plan).The rest of the croft is covered with bracken and rushes.It is occasionally grazed by a few sheep.

The roofed buildings shown on the first and second OS maps have disappeared under the new builds

There are the remains of several stone dykes and footings of dykes (see plan and photo)



Stone dyke on croft 53 that is typical of the croft walls on the township.

To the N of the croft lies one of the passages now upgraded to a croft road.