

54.

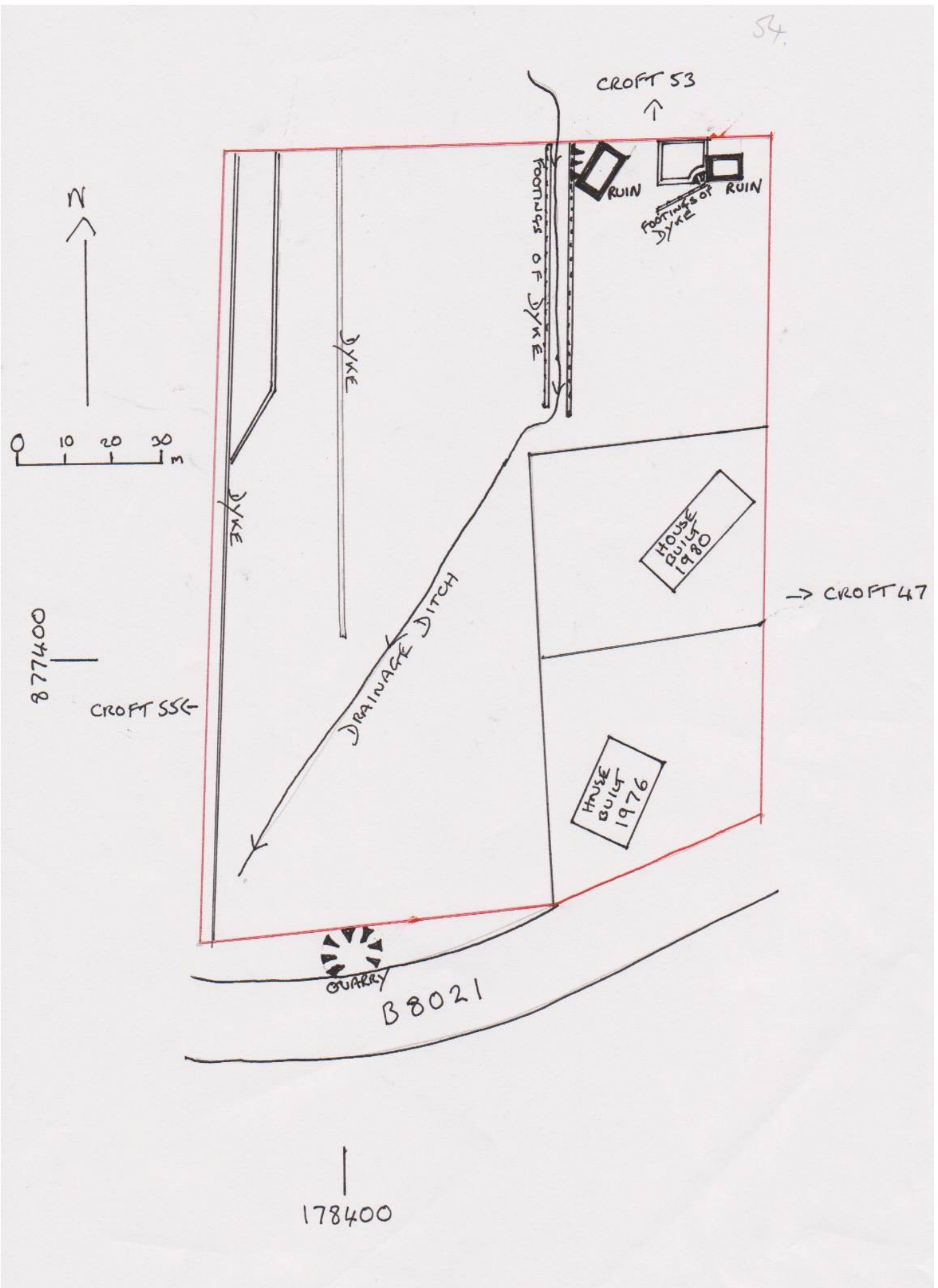

CROFT 54 LONEMORE TOWNSHIP.

Croft 54 is shown as having 3.75 acres on the estate map. Apart from the area taken up by the gardens of the new houses built in 1976 and 1980 (see plan), it is mainly grass used for grazing sheep. A large drainage ditch crosses the croft to help keep it clear of bog.

There are several stone dykes and footings of others remaining (see plan)

In the NE corner of the croft are the ruins of two buildings and an enclosure shown on the first and second OS maps (see separate description).

On the S boundary of the croft runs the B8021, and there is a small quarry or borrow pit that was used to provide hardcore for the road construction.

Several old agricultural implements can be seen lying on the croft.



SOME AGRICULTURAL IMPLEMENTS ON CROFT 54



LOWER RUIN CROFT 54 LONEMORE GAIRLOCH. NG 78488 77487 GPS
 ELEVATION 29 METRES
 SURVEYED ON 12-11-08
 BUILDING FUNCTION POSSIBLE BYRE

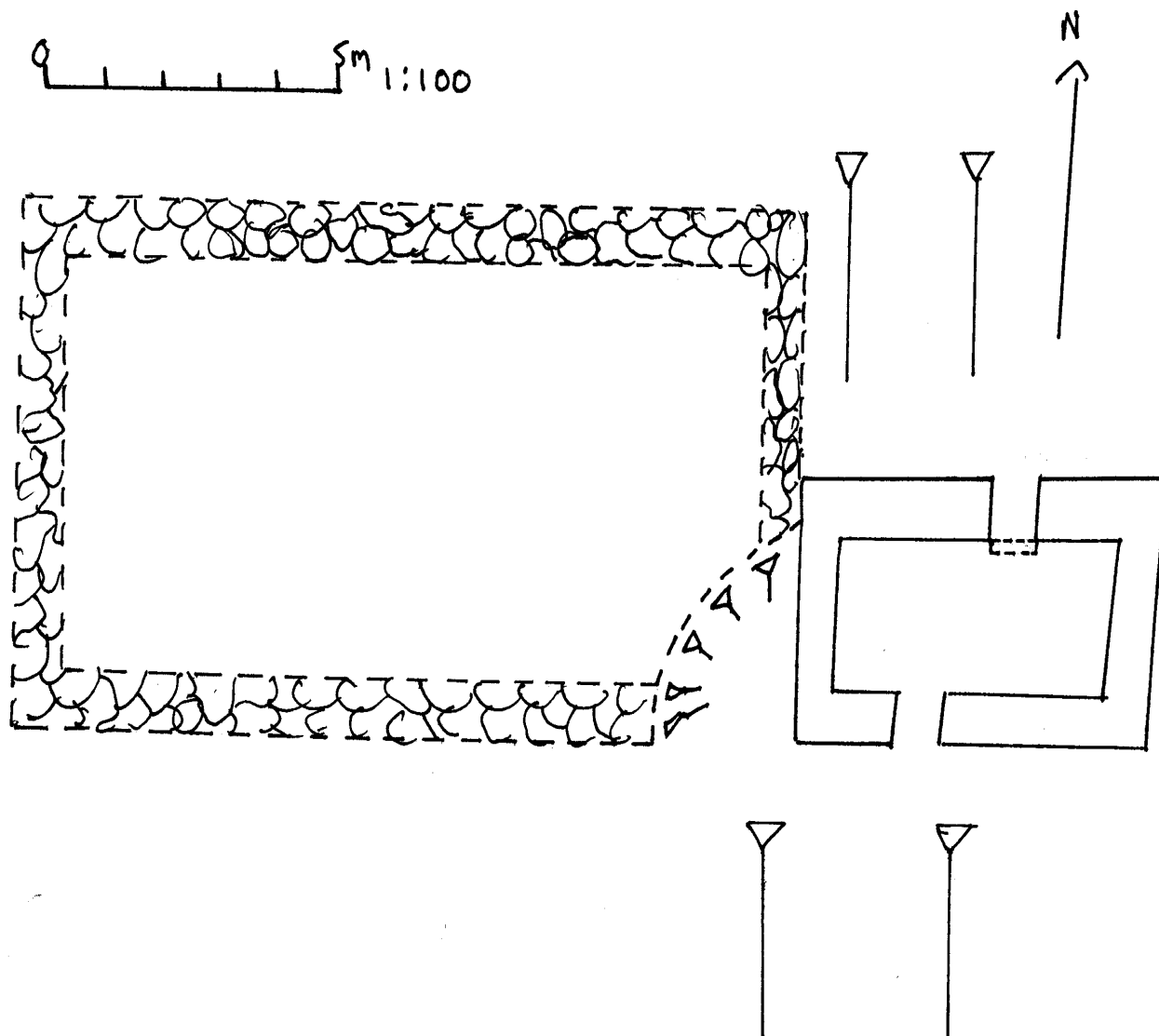

Unroofed ruin shown as unroofed on both 1st and 2nd OS

It has a southerly aspect on a gentle N to S slope.

The walls consist of boulders with a few selected stones and range in height from 0.60 to 1.75 m. There is little tumble and on the rear wall the thickness is still 1m.

No evidence of any windows but 2 doorways on the N. and S walls. The S. doorway has its lintel in place at a height of 1.45m. And the N. doorway has a step just inside the wall.

The ground is lower inside the ruin than on the ground outside indicating possible mucking out of a byre.

To the west of the ruin and attached is a boulder wall enclosure with no definite entrance, but the wall is broken down and has been reconstructed in places It is 0.50m in height. In the SW corner of this enclosure is a semi circular hollow which could be a midden.

LOWER RUIN CROFT 54 LONEMORE GAIRLOCH. NG 78488 77487 GPS
SHOWING RUIN WITH ATTACHED ENCLOSURE AND TWO DOORWAYS



UPPER RUIN CROFT 54 LONEMORE GAIRLOCH.NG 78462 77487 GPS
 ELEVATION 31 METRES
 SURVEYED ON 12-11-08
 BUILDING FUNCTION HOUSE WITH BYRE /SHED ATTACHED

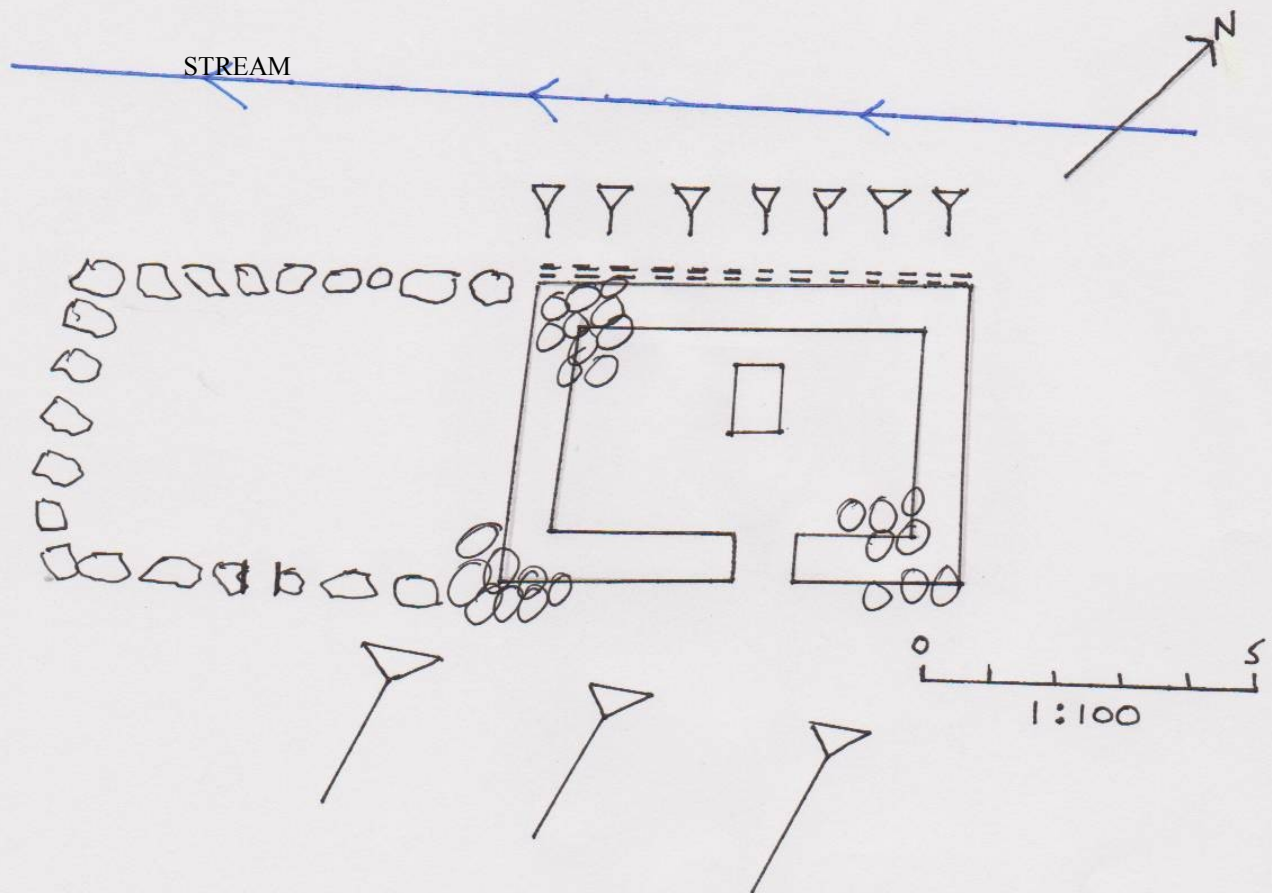

This unroofed ruin shown as roofed on both the 1st and 2nd edition os was known to have been a house before the family moved to croft 46.

The ruin has a southerly aspect which is typical of buildings in lonemore.

The basic outline of the building is shown although there are areas of tumble in 3 corners.the walls are constructed of chosen and dressed stone with some snecking and also infill in the center of the walls.the height varies from 2.59m(w.gable) to 0.50m and the most intact walls are 0.80m thick.

There was no visible evidence of a chimney or any windows but there is a doorway on the southeren wall with a large lintel still in place at a height of 1.55m.lying on the ground inside the ruin is another lintel which would indicate a window had existed.

The ground inside the ruin is at the same level as the ground outside.

Attached to the W edge of the ruin are visible footings of another building with a possible opening on the S side. Behind the N.wall of the ruin is a steep manmade slope leading to a ditch immediately behind the wall. Beyond this there is a stream at a distance of 2m.

The ground to the S. side of the ruin slopes gently to the S it is mainly grass and rushes and is still used for grazing sheep.

UPPER RUIN CROFT 54 LONEMORE GAIRLOCH. NG 78462 77487 GPS
SHOWING STONEMWORK AND LINTEL ABOVE DOORWAY.

