

Plan of An Sguman, Port Henderson. Centred on NGR NG 7482 7382

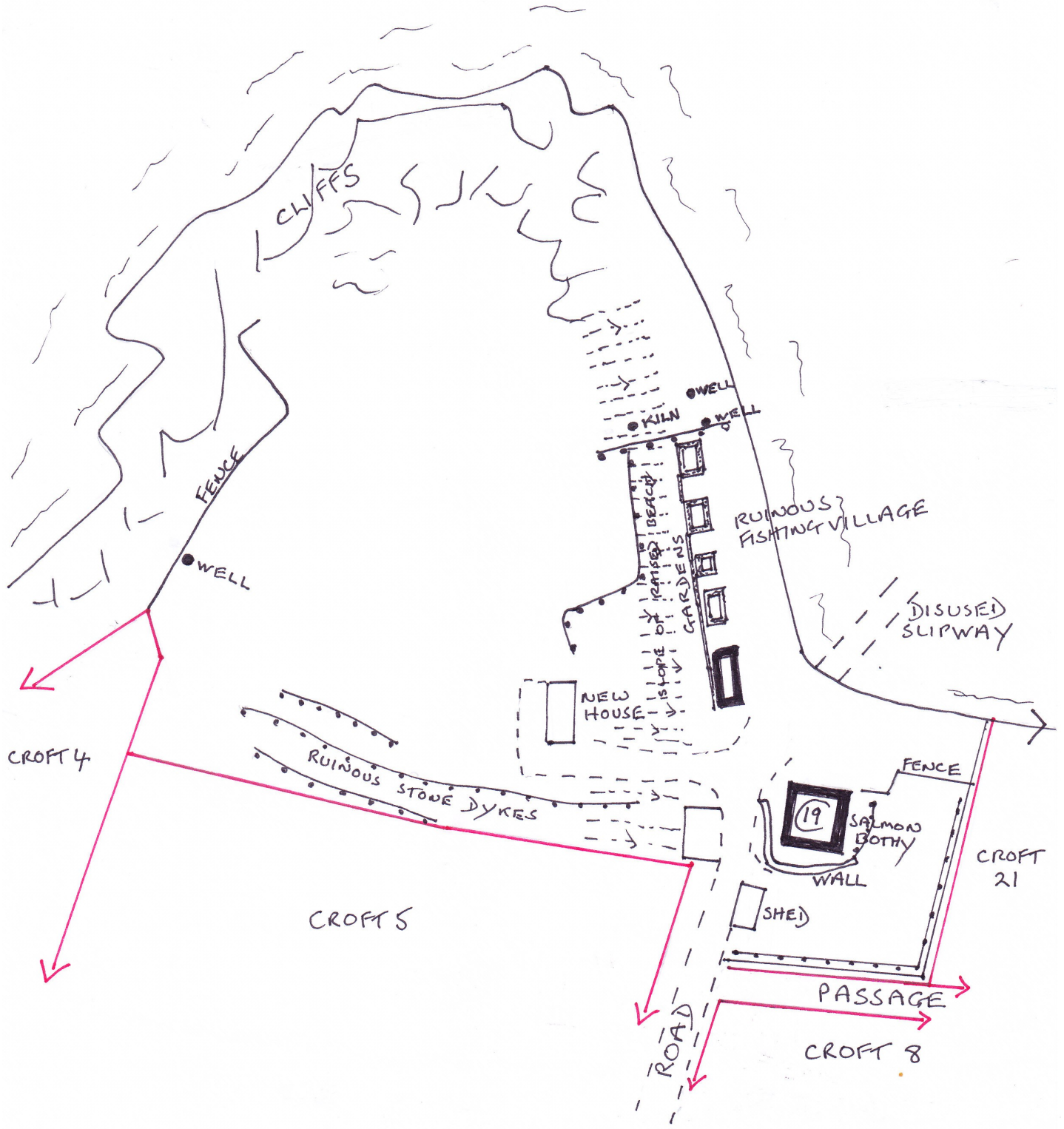
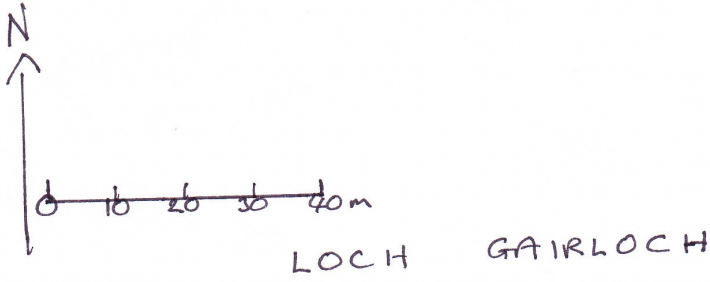

An Sguman, Port Henderson.

This peninsula jutting northwards into Loch Gairloch is considered to be an integral part of Port Henderson. The ground is of poor quality and the coastline steep and rocky. Although the 1845 estate map has the name Ann Mackenzie written over the area it was never included as a croft. The area was retained by the Laird as there was a salmon fishing station here and he rented out the rights for this. Eventually he sold the peninsula and it remains in private ownership.

On the E side of the peninsula at the foot of the steep slope of the raised beach lies part of the ruined fishing village established in 1815. (see separate description) Behind the ruins are the gardens of the ruins and in front the rocky shoreline.

The 1st OS shows the fishing village, and the 2nd OS has the additional building known as the salmon bothy. This bothy has been extensively modernised and is now let as a holiday home. The fishing village is mostly ruinous but some buildings have been roofed as sheds, and some removed when the new house was built further up the slope.

There is the main slipway of the township known as Port An Sguman on the shore in front of the bothy, but due to shoreline alterations this can no longer be accessed.

Several ruined stone dykes can be seen on the peninsula and one runs down the slope of the raised beach on the E side.

To the N of this wall are two wells at the foot of the slope, one being the main well that never ran dry and had the clearest water.

There are also two ruined kilns (see separate descriptions) the northern one being older and ruined by a landslip of the steep slope. The larger one is contained within the fishing village ruins.



Looking W towards the E side of An Sguman. The new house can be seen on the skyline, with the modernised salmon bothy and reroofed buildings of the fishing village by the shore.

An Sguman, Port Henderson.



Looking down the slope of the raised beach onto the gardens and ruined fishing village. The disused slipway can be seen and the modernised salmon bothy.



The salmon bothy in the 1970's. The slipway is still in use.

Kiln Structure NG 74879 73799 GPS Elevation 12m. An Sguman Port Henderson.

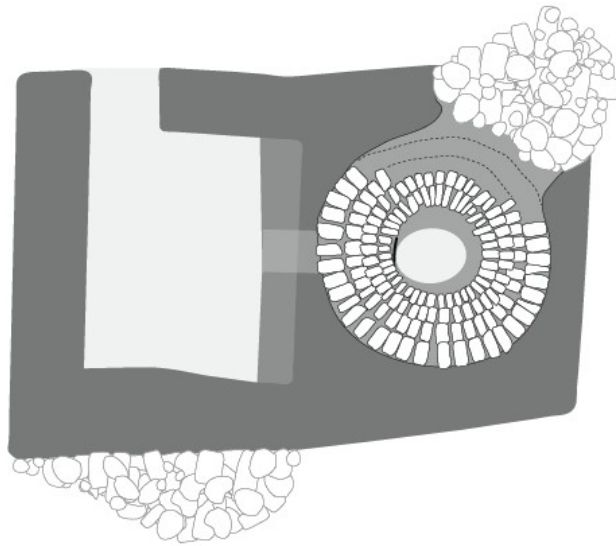

This kiln structure, one of 4 found in Port Henderson, is the least ruinous, with its kiln bowl mostly intact. It was surveyed by the plane table method.

40 m to the N is an older kiln(see separate description) that was ruined by landslip from the raised beach slope. This newer kiln is built further away from the steep raised beach, but still has its W wall dug into the slope running down to the shoreline 10m to the E.

The kiln is within the ruins of the fishing village which predate the crofting township. However it is likely that the existing structures were modified and rebuilt to create the kiln.

The structure itself is mostly intact with some tumble on the W and E sides, and unroofed.

The stone is dressed, layered, with infill and some snecking. The walls of the kiln barn average 1m thick, but around the bowl and joining wall, the thickness varies. The bowl is 2.8m high at its highest point. The flue has a lip at the bowl end to stop ash from the peat fire mixing with any fallen grain. In the kiln barn a shelf on the dividing wall allows easy access to the top of the bowl where the grain was dried.

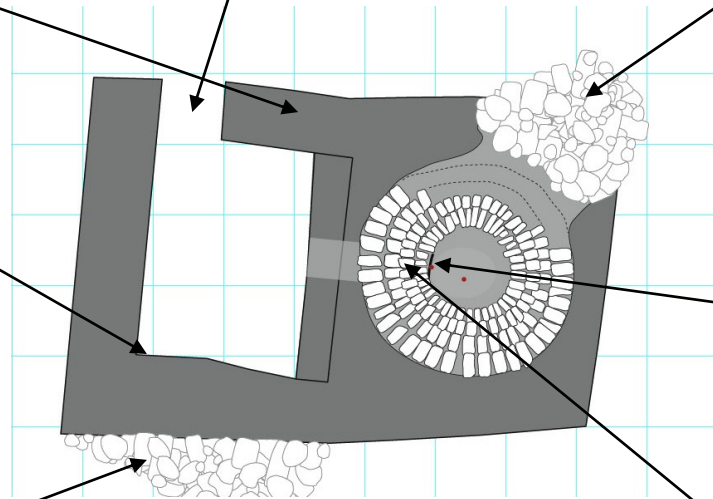

Features of kiln structure, NG 74879
73799 GPS. An Sguman

INTERPRETATION OF PLANE TABLE SURVEY OF KILN SITUATED ON AN SGUMAN PORT HENDERSON. Ng 74861 73836 GPS
ELEVATION 2m. SURVEYED 09-06-10

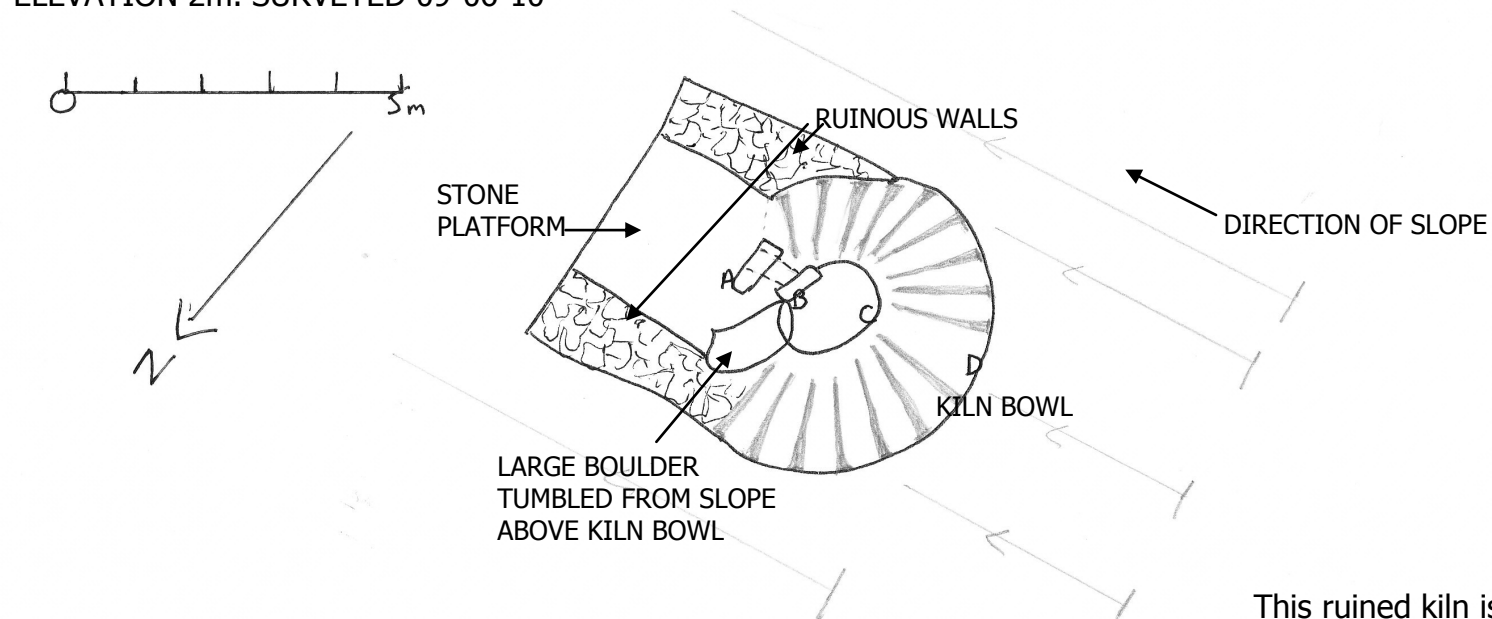

- A OUTER EDGE OF FLUE
- B INNER EDGE OF FLUE
- C INNER/LOWER LIMIT OF KILN BOWL
- D OUTER/UPPER LIMIT OF KILN BOWL

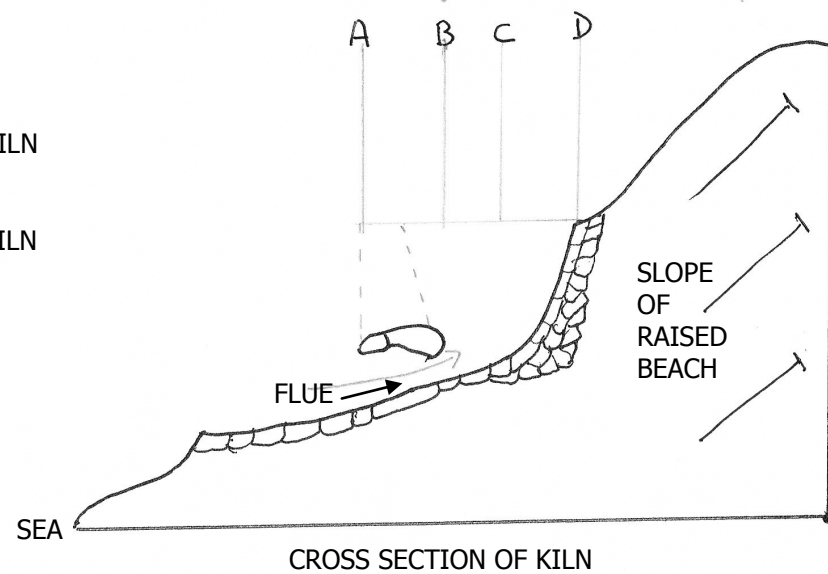

This ruined kiln is set into the slope of the raised beach, that runs around the edge of the bay at Port Henderson. It has been partially covered by debris and a large boulder from the slope, and probably predates the large kiln that is situated further S on An Sguman. An Sguman means 'stack of corn' from the OS name books.

The bowl of the kiln is well made, with a single flue leading into it. The height of the remaining bowl wall set into the hillside is 1.60m, with the flue having a height of 0.50m. The flue has a length of 1.0m. Extending beyond the bowl is a stone platform measuring 2.0 x 2.5m with ruinous walls on each side to a height of 1.0m.

This may indicate the remains of a kiln barn or some form of shelter for fuel and grain.

The slope runs steeply downhill in an easterly direction from the platform to the sea.

KILN SITUATED ON AN SGUMAN PORT HENDERSON. NG 74861 73836 GPS.



LOOKING AT KILN BOWL, WITH FLUE ENTRANCE, AND LARGE BOULDER OVERLYING PART OF KILN



LOOKING SE ACROSS KILN SHOWING ANGLE OF SLOPE, PROXIMITY TO SEA, AND LARGE BOULDER



LOOKING N ACROSS KILN BOWL SHOWING BOWL BUILT INTO SLOPE.