

# Plan of Croft 3, Port Henderson. Centred on NGR NG 7466 7359



0 10 20 30 40 m

CROFT 4

CROFT 2

CROFT 6

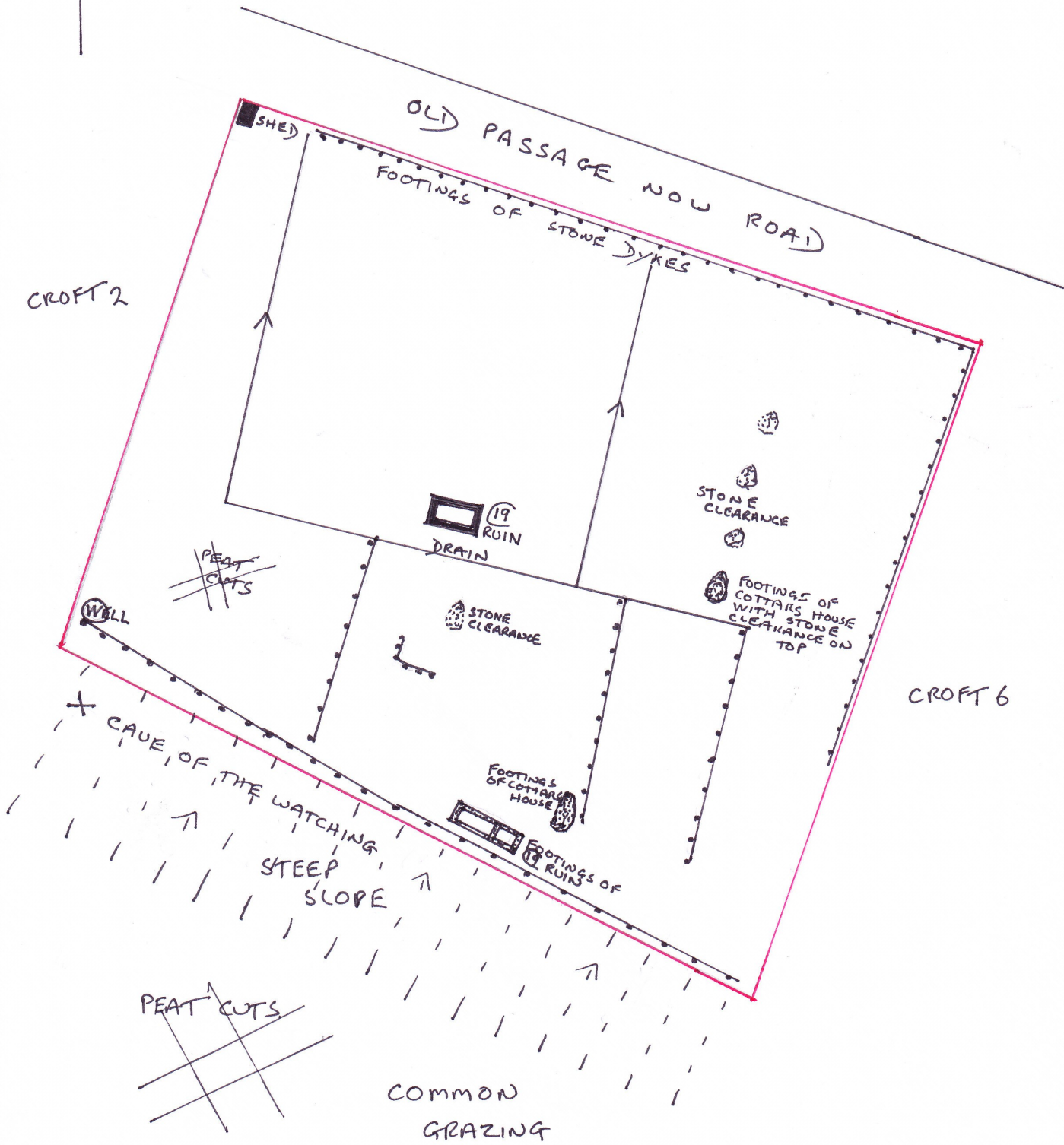

## Croft 3, Port Henderson.

This croft is shown from the records to have been associated with croft 4. Today the two crofts are owned by the same people. It is blanketed by thick moss and heather.

The estate map of 1845 gives the croft an acreage of 4.20.

On the croft there are the ruins of two houses with attached barns, (see separate descriptions) which are shown on both the 1st and 2nd OS.

There are numerous ruined stone dykes, stone clearance, and drainage ditches on the croft.

Footings of cottars houses with more stone clearance piled on top are sited at NG 74669 73533 GPS (4x2m) and 74688 73574 GPS (3x2m).

There has been some peat cutting in the SW of the croft and a ruined well lies at the SW corner.

A ruined stone dyke marks some of the old boundaries of the croft now demarcated by a post and wire fence.



Footings of cottars house on croft 3 Port Henderson covered with later stone clearance.

# Croft 3, Port Henderson.



Footings of, and heather covered stone dykes on croft 3.



The ruined stone dyke running along the S edge of croft 3. This wall extends along the S edge of crofts 2,3,6, and 7 continuing SE across the common grazing to the road.

## Croft 3, Port Henderson.

Overlooking the croft from the steep slope to the S is 'The cave of the Watching' which lies below the site of a possible Dun ( see Dixon's Gairloch) This was supposed to have been the last stronghold of the MacLeods of Gairloch.



Cave of the Watching NGR NG 7457 7356



Looking SE along the possible wall of the Dun?

RUIN OF HOUSE WITH ATTACHED SHED AND FOOTINGS OF BARN OR ENCLOSURE ON CROFT 3 PORT HENDERSON.  
NG 74640 73581 GPS. ELEVATION 21m. SURVEYED ON 22-03-10.

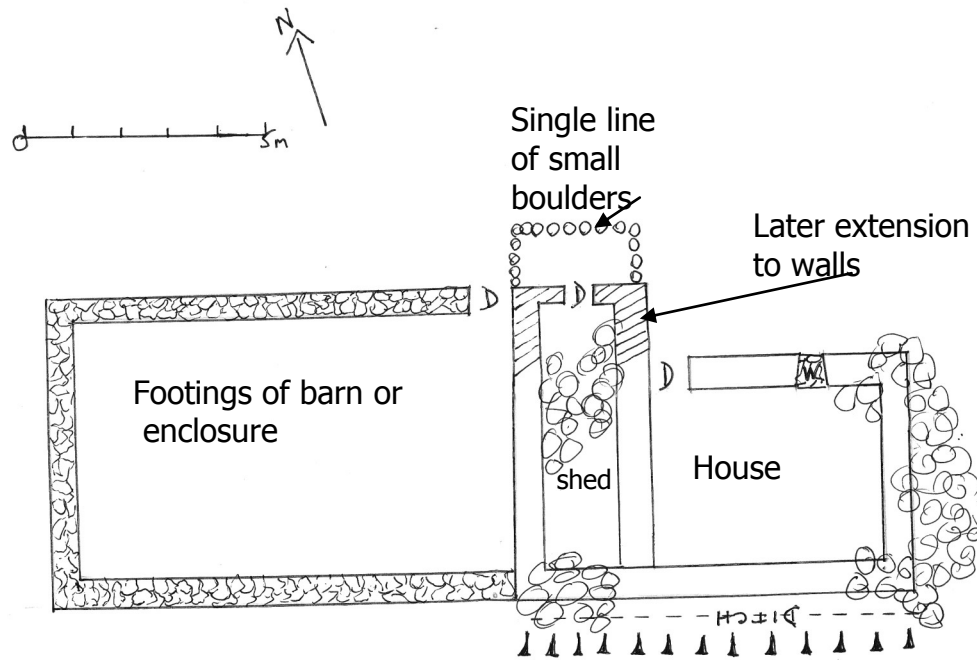

## RUIN OF HOUSE WITH ATTACHED SHED AND FOOTINGS OF BARN OR ENCLOSURE ON CROFT 3 PORT HENDERSON.

This ruin is shown as partially roofed on the 1st OS and unroofed on the 2nd OS. It is not shown at all on the modern OS. Local knowledge says that a retired doctor lived in the house, and it had a thatched roof and hanging lum. The Aerial Photo's suggest a roof in the 40's and 50's.

The footings to the W of the house and shed, are filled with a lot of tumbled stone and a thick depth of moss so it is not possible to decide just what its function was. Local knowledge says that the family who had this croft and croft 4 were very involved with the fishing and that there were large barns for storing the fishing gear .There is one other site on the S edge of this croft of a possible large barn but definite function is unknown.



AREA OF FOOTINGS OF BARN OR ENCLOSURE

The ruin of the house and shed are constructed of local sandstone, with chosen and dressed stone and some boulders. There is layering of the stones with some snecking to fill the gaps. An inserted wall divides the house from the shed, and both this and the W wall of the house have been extended. Although there is a lot of tumble 3 doorways can be seen and the remains of a window in the house. No chimney, but see reference to hanging lum in earlier text. The walls range in height from 0.3m to 1.2m and have an average thickness of 0.60m.

Behind the ruin there is a ditch, the croft is very boggy.

Water would have been carried from the well on the S boundary of the croft.

RUIN OF HOUSE WITH ATTACHED SHED AND FOOTINGS OF BARN OR ENCLOSURE ON CROFT 3 PORT HENDERSON.

LOOKING W OVER RUIN OF HOUSE AND SHED



SHED AREA OF RUIN

LOOKING AT S EXTERNAL WALL STONEMWORK



LOOKING W ALONG S WALL OF HOUSE

FOOTINGS OF TWO RUINS CROFT 3 PORT HENDERSON.NG 74650 73523 GPS. ELEVATION 32m.SURVEYED 02-03-10

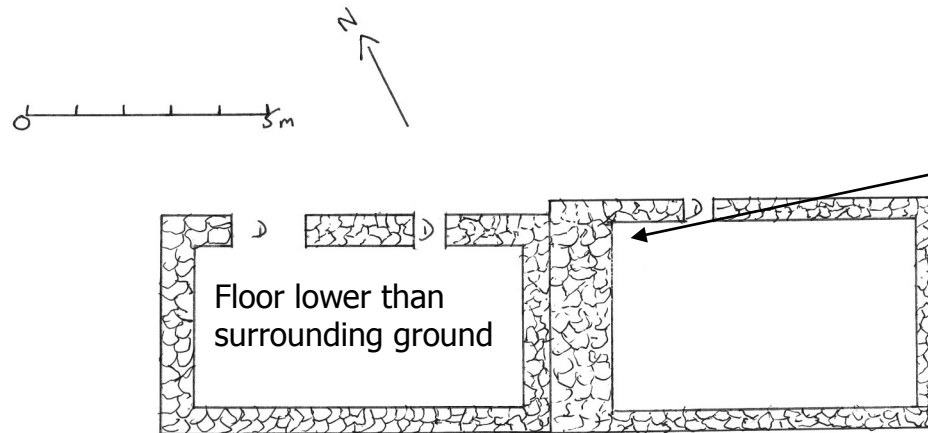

These footings show two buildings adjoining each other with distinct separating walls. Their height averages 0.3m, and the stones are mainly boulders with a few selected stones situated at corners and doorways. The width of the footings is 0.6m except for the W wall of the E building which is 1.2m. The floor is lower than the surrounding ground in the W building. The function of these buildings is unknown, but may possibly be a byre/barn (two doors on W side) and house. A single long building is shown as partially roofed on the 1st OS. Nothing is shown on the 2nd OS. A single unroofed building is shown on the modern OS. The footings show up on the 1964 Aerial Photo.

