

Plan of Croft 8, known as 'Lota Neilie Mhorto'
Port Henderson
Centred on NGR NG 7493 7365

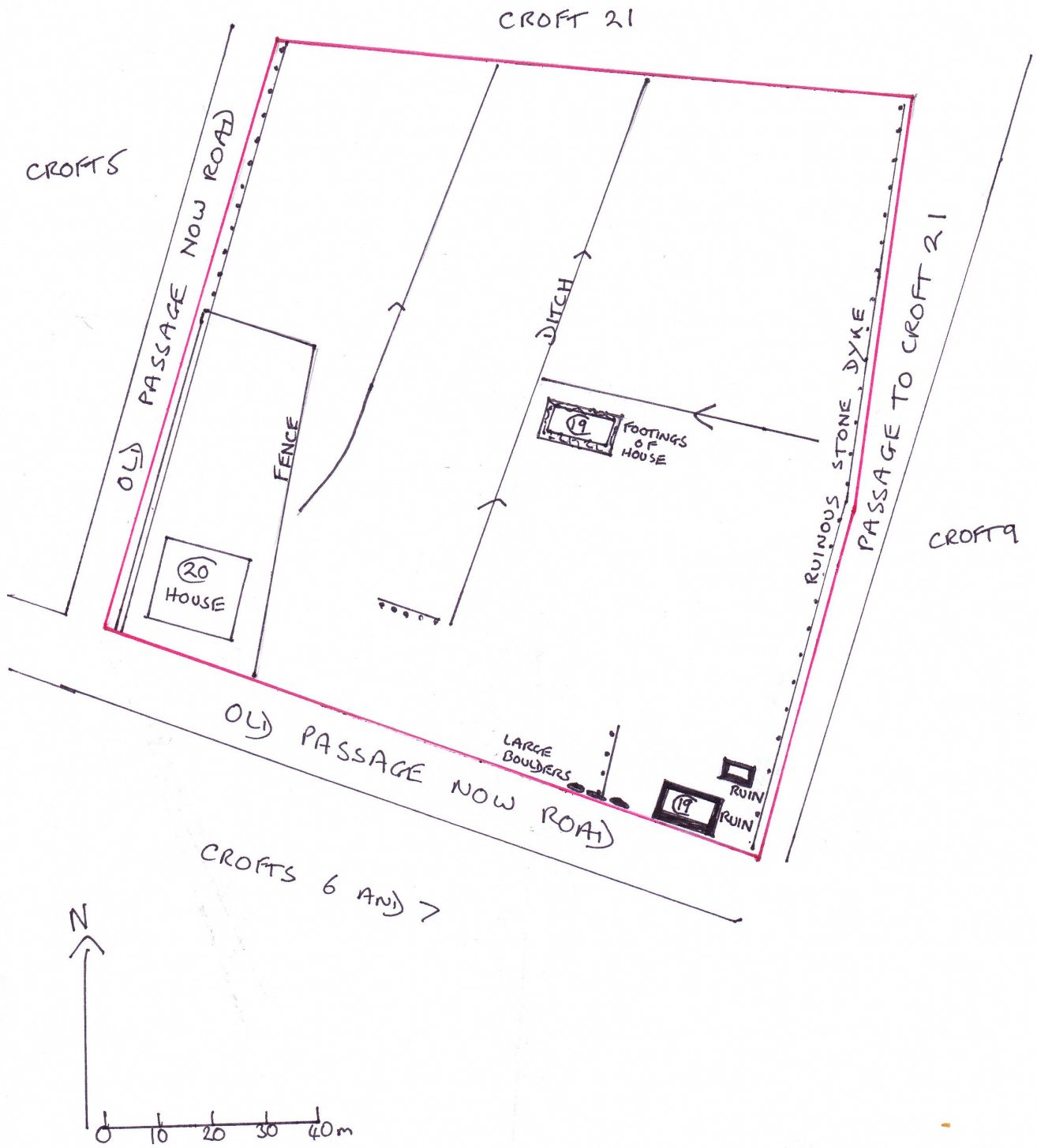

Croft 8, Port Henderson.

This croft is not used for arable cultivation or pasture today, but has good gently sloping ground running from S to N. On the 1845 estate map although the croft is shown, no figures for acreage are given.

On the 1st OS two roofed buildings are shown in the centre of the croft, but by the time of the 2nd OS these have gone and there are two roofed buildings shown closer to the track.

The footings of one of the 1st OS buildings was found(see separate description), and the ruin of the house and footings of the barn and enclosure are also visible(see separate description).

The footings of several stone dykes can be seen especially to the E of the croft running S to N down the edge of the wide passage leading to croft 21.

A modern house with garden is found in the SW corner of the croft.

The boundaries of the croft are marked with post and wire fencing.



Looking N over the footings of barn to croft 8 with wide passage leading to croft 21 in the background.



Looking N through the Ruined house over croft 8

RUIN SITUATED IN CENTER OF CROFT 8 PORT HENDERSON.NG 74959 73567 GPS.ELEVATION 18m.SURVEYED ON 18-02-10.

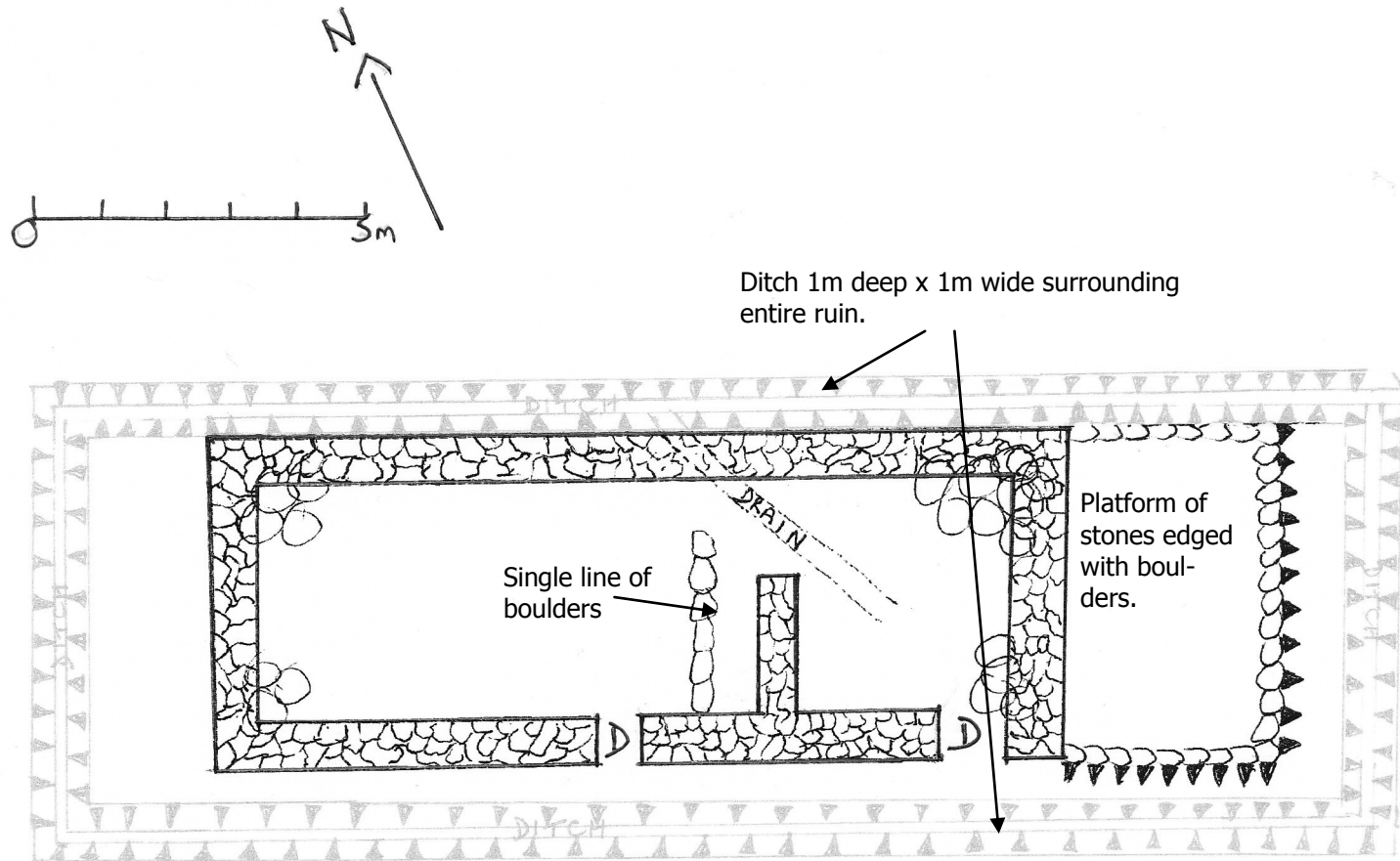

All that remains of this building shown on as roofed on the 1st OS are footings up to 0.5m high and averaging 0.75m in width. They show a two compartment building with a probable door in each part, with evidence of a drain(now partially covered by tumble) in the E side, and a platform of stones adjacent to the E end of the building. The footings show a double stone wall filled with smaller infill made with chosen and dressed stone. The whole ruin is surrounded by a deep ditch that has probably been improved at a later date to assist drainage as the whole croft is very boggy and has numerous ditches. The floor of the ruin on both sides is lower than the surrounding ground, and there is a line of single boulders in the W side. The function of this building was probably a house/ byre dwelling. The 1st OS shows a roofed building of similar size to the east of this ruin also on croft 8, but there is no evidence of this now. The 2nd OS does not show either building but another roofed building has appeared beside the track on croft 8. The stone was probably reused for this newer building.

RUIN SITUATED IN CENTER OF CROFT 8 PORT HENDERSON



Looking W along N wall



Looking W along S wall

FOOTINGS OF RUIN



Looking E along S wall

FOOTINGS OF WHOLE RUIN



Looking SE at ruin



Looking S through Eastern doorway.



Looking W at ruin

RUINS OF HOUSE AND BARN/BYRE ON CROFT 8 PORT HENDERSON. HOUSE NG 74959 73567 GPS ELEVATION 18m
BARN/BYRE NG 74966 73571 GPS ELEVATION 15m. SURVEYED 22-02-10

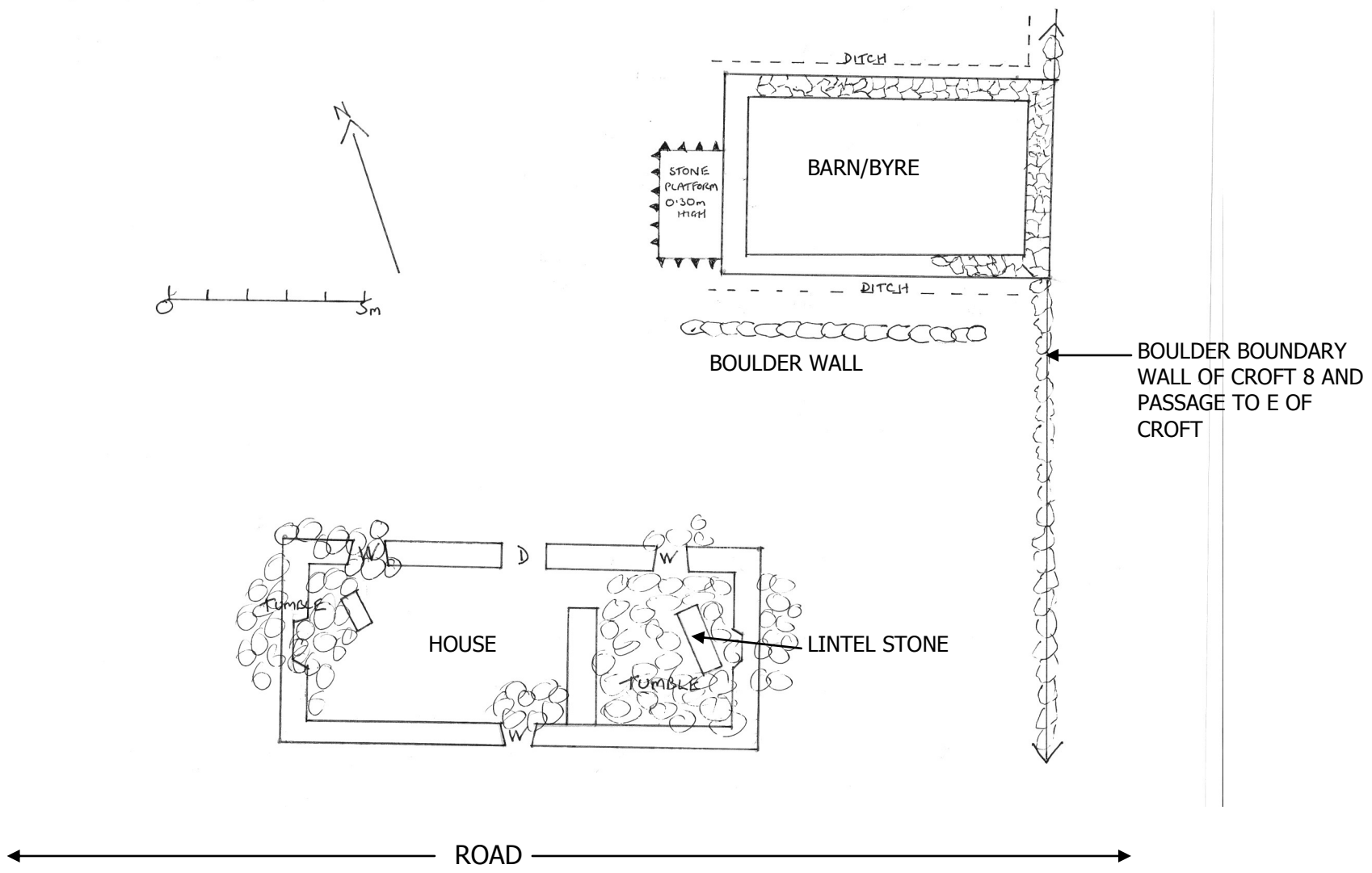

RUIN OF HOUSE ON CROFT 8 PORT HENDERSON NG 74959 73567 GPS.



LOOKING S AT N (FRONT) OF HOUSE

This substantial ruin is situated beside the road at the S edge of croft 8. It is first shown on the 2nd OS as roofed, and aerial photos show it as roofed in 1954 but unroofed by 1964. Local knowledge remembers the last family 'the Beasleys' living there until the 40's. The walls average thickness is 0.60m and their height ranges from 0.50m to 2.4m. They are made with chosen and dressed stone that is layered with snecking in between. The external walls have been harled with a lime mortar that is still evident in places. Although there is a lot of tumble in the ruin, two windows and a door can be seen in the N wall and one window in the S wall. There is a chimney at either end with substantial lintel stones. The W lintel measures 1.2m x 0.5m and is in situ, and the E lintel measures 1.7m x 0.5m and lies amongst the tumble. There is also a smaller lintel stone lying close to the W window on the N side of the ruin.

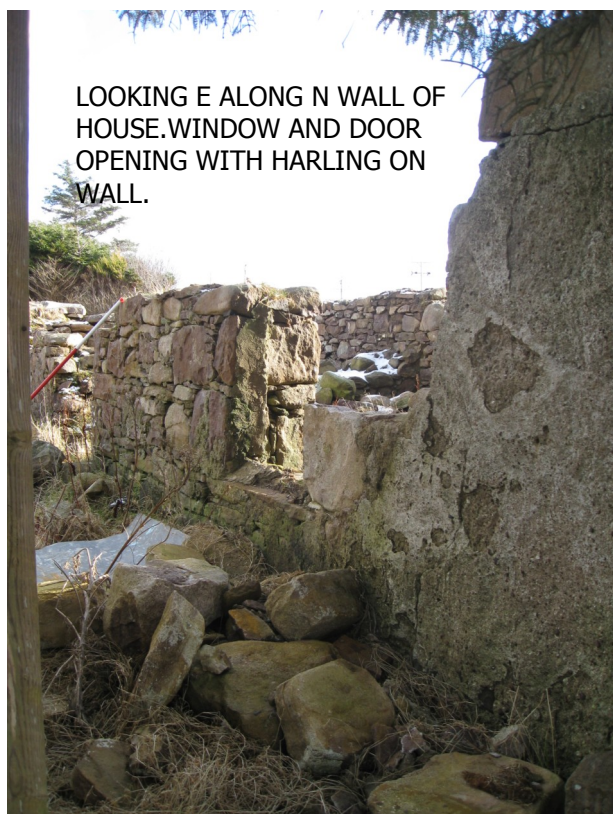

LOOKING E ALONG N WALL OF HOUSE. WINDOW AND DOOR OPENING WITH HARLING ON WALL.



LOOKING E TO W INSIDE HOUSE SHOWING TUMBLE

RUIN OF HOUSE ON CROFT 8 PORT HENDERSON NG 74959 73567 GPS

SHOWING TUMBLE
AND LARGE LINTEL
STONE AT W END OF
RUIN. SMALLER
WINDOW LINTEL LIES
AMONGST THE
TUMBLE



Inside the ruin towards the E
end is a wall inserted at a later
date as it butts onto the internal
S wall.

To the N of the ruin lies the ruin
of a barn/byre (see separate
description).



RUIN OF BARN/BYRE CROFT 8 PORT HENDERSON NG 74966 73571 GPS

This ruin lies just NE of the ruined house on the S edge of croft 8. It remains as footings up to a height of 0.6m with an average width of 0.5m, with the highest point being on the W side. There are some chosen and dressed stones in the footings. There is a small stone platform attached to the external W wall at this point. No doors or windows can be seen in the ruins. There is no evidence of any internal divisions. There are ditches to the N and S of the ruin. The E footings merge into the boulder wall that divides the croft from the passage that runs N to S on the E edge of the croft. There is another boulder wall to the S of the ruin.

