

Plan of Croft 11 known as 'Lota Sheorais'  
Port Henderson  
Centred on NGR NG 7573 7381

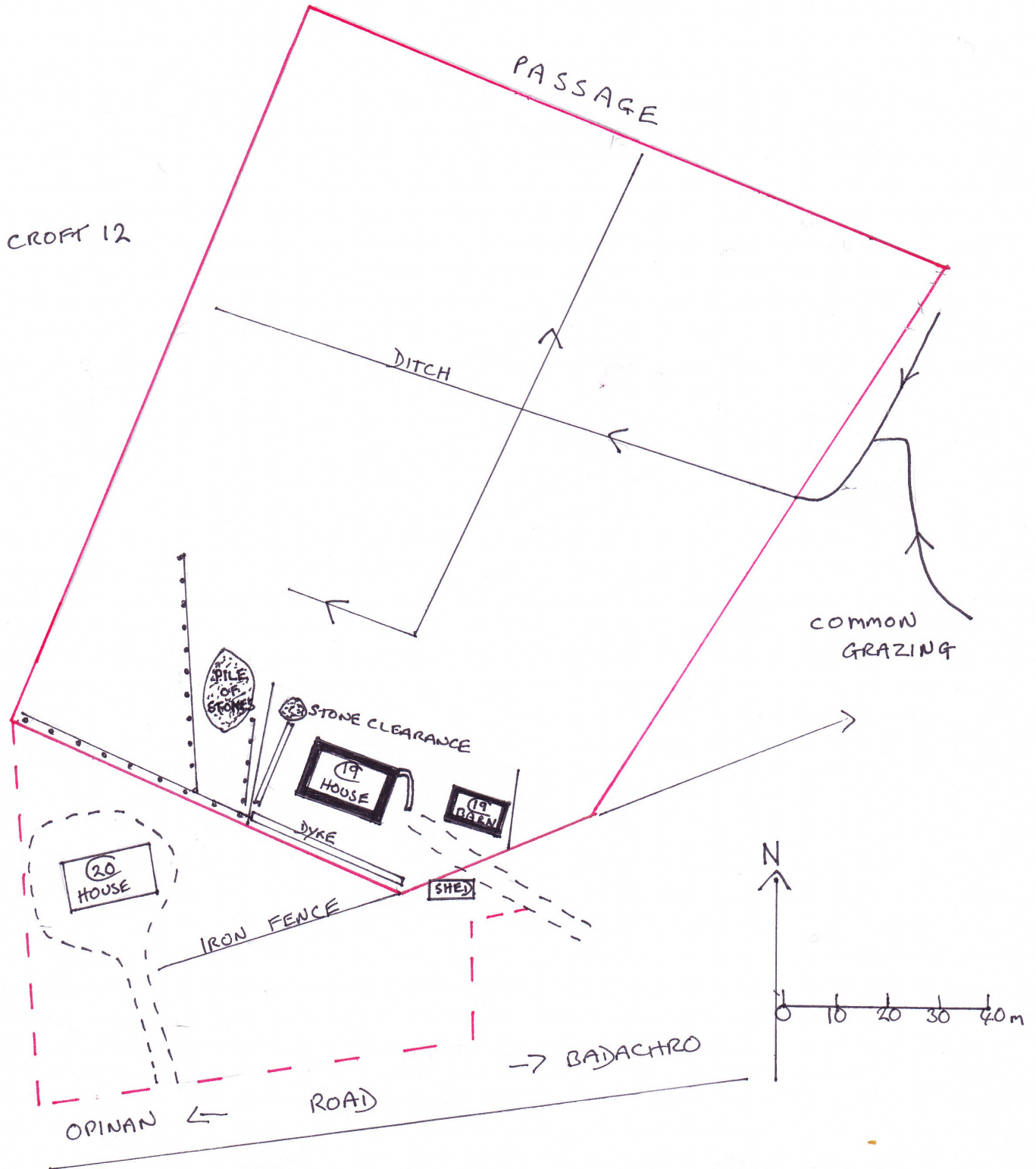

## Croft 11, Port Henderson.

This croft situated on the eastern side of Port Henderson is unused today. The estate map of 1845 gave an acreage of 4.5. The ground slopes very gently from SE to NW and is very wet although large drainage ditches cut across it.

On an apportionment to the S of the croft a modern bungalow has been built.

The first OS shows three roofed buildings, and the 2nd OS adds a fourth lying beside a track running S of crofts 11 and 12. To the N of this, one of the original buildings seems to be shown as a stackyard/small enclosure. Today the main house is still lived in and has an extension built on its W side which apparently was built over an old shop known as 'Lizzies Shop'. The stones were used to build a dyke. This house was known as the 'Ceilidh House'.

The barn is still roofed and used, but no other buildings remain. A large pile of stones in the area where buildings were shown has some dressed stone in it so may be the rubble from these buildings.

There is still some evidence of a track and adjacent dykes amongst the woodland on the croft. There are ruined stone dykes and a pile of stone clearance.

The estate iron fence continues along the SW boundary of the croft but the main fence is post and wire now.



Looking S over Croft 11 towards the main house with extension. The Barn can be seen on the left through the trees

# Croft 11, Port Henderson.



The old barn

One of the older walls



Part of the wall alongside the old track