

Plan of croft 14 known as 'Lota Dhomhnaill Long'
Port Henderson
Centred on NGR NG 7568 7396

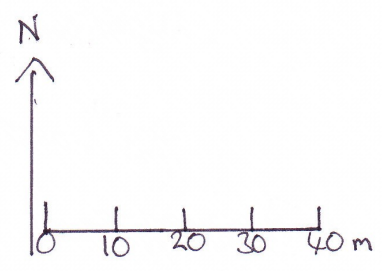
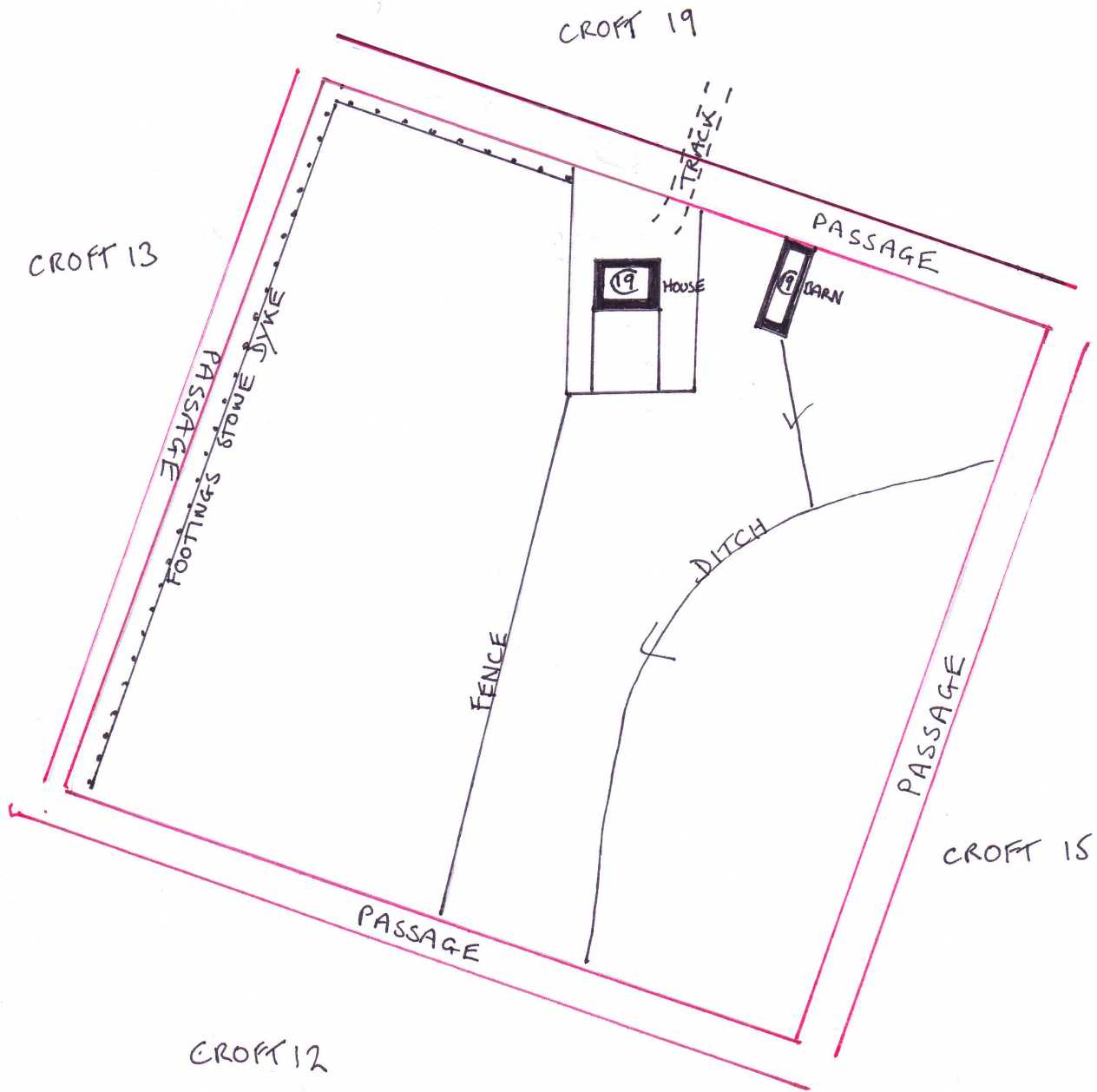

Croft 14, Port Henderson.

The ground on this croft slopes from N to S, with drainage ditches enabling improved soil for pasture and some arable cultivation.

The 1845 estate map gives an acreage of 2.5 but today some apportionments of the common grazing have increased the land available to the tenant.

The 1st OS shows two roofed buildings, a house and barn/byre, which are both still in use today. The house used as a holiday house.

As the croft lies at the centre of the E side of Port Henderson it is surrounded on all sides by a 'passage' or right of way. These used to be the main access routes through the township. The passage to the S of the croft was the main route into the township before the new road was built. Now most of the 'pasaidean' are overgrown and unusable.

On the W and N boundaries of the croft are some footings of stone dykes but the boundaries are now marked with post and wire fencing.



Looking N over Croft 14 showing improved ground, the house and byre.

Croft 14, Port Henderson.



The ruined passage S of croft 14 that was once the main access into the E side of the township.