

**CFA ARCHAEOLOGY LTD**

August 2006

*Commissioned by Chrichton, Lang, Willis and Galloway on behalf of The  
Congregational Board of Duddingston Kirk*

This document has been prepared in accordance with CFA standard operating procedures.

Author:	Date
Approved by:	Date
Draft/Final Report Stage:	Final

**Author: Magnus Kirby MA FSA Scot AIFA**  
Illustrations: Ross White BSc AIFA  
Editor: Bruce Glendinning BSc PgDip MIFA

CFA ARCHAEOLOGY LTD  
The Old Engine House  
Eskmills Business Park  
Musselburgh EH21 7PQ

Tel: 0131-273-4380  
Fax: 0131-273-4381  
email: [cfa@cfa-archaeology.co.uk](mailto:cfa@cfa-archaeology.co.uk)

**Duddingston Church Hall  
Duddingston Village  
Edinburgh**

**Archaeological Watching Brief**

**Report No. 1227**

## **CONTENTS**

1.	Introduction	3
2.	Working Methods	4
3.	Archaeological Results	4
4.	Summary	5

## **Appendices**

1.	Photographic Register	6
2.	DES entry	6

## **Illustrations**

Fig. 1	Site Location	7
Fig. 2	Plan of church hall and extension	8

## **1. INTRODUCTION**

### **1.1 General**

1.1.1 This report presents the results of an archaeological watching brief undertaken by CFA Archaeology Ltd (CFA) in August 2006 at Duddingston Church Hall, Duddingston Village, Edinburgh (NGR: NT 2852 7266) (Fig.1). The work was commissioned by Chrichton, Lang, Willis and Galloway on behalf of The Congregational Board of Duddingston Kirk.

1.1.2 A Written Scheme of Investigations (WSI) for the watching brief was produced by CFA, based on documents provided by Chrichton, Lang, Willis and Galloway (Architects). The WSI was designed to fulfil the requirements of the City of Edinburgh Council Archaeological Service (CECAS).

### **1.2 Background**

1.2.1 Planning permission has been granted by the City of Edinburgh Council (Ref. No. 03/03116/FUL) for the construction of a replacement extension to Duddingston Church Hall (Fig. 2), and the construction of a meeting place in the adjacent walled garden, subject to a condition requiring an archaeological watching brief on all groundbreaking works. This report covers only the extension to the church hall; the construction of the meeting place will form part of a later, separate project. The proposed extension will be roughly L-shaped and will conjoin the northern and western walls of the existing building.

1.2.2 Prior to any groundbreaking works taking place, the proposed development area was occupied by an existing extension to the church hall. Part of the programme of works involved the demolition of this structure.

1.2.3 Duddingston Church Hall dates to the mid-20<sup>th</sup> century and is recorded by the National Monuments Record of Scotland (NMRS No. NT27SE 198.01). It is located within the grounds of the historic church manse attached to the medieval Duddingston church and is believed to occupy a position within the heart of the historic medieval village of (Wester) Duddingston. Place name evidence indicates that the settlement and church are likely to date back to the early-Christian period with the settlement first recorded under the name of Treverlan.

1.2.4 Duddingston Village lies just outwith the Scheduled area associated with Holyrood Park (SAM No. 90131). This area appears to have been an important focus for settlement since the early prehistoric period. Prior to 1860, a Neolithic stone axe (NMRS No. NT27SE 114) was discovered near the current gate of Duddingston Kirk. Consequently, the proposed development area was considered to be of high archaeological potential, relating to both the medieval and prehistoric period.

1.2.5 No previous invasive archaeological fieldwork is known to have taken place within the proposed development area prior to this watching brief.

### **1.3 Objectives**

- 1.3.1 The aims of the monitoring were excavate and record any features or objects of archaeological importance that may survive within the development area, and which may be damaged or destroyed by this development.

## **2. WORKING METHODS**

- 2.1 CFA Archaeology Ltd follows the Institute of Field Archaeologists' (IFA) Code of Conduct, Standards and Guidance.
- 2.2 Partial removal of the overburden/topsoil and the partial excavation of the foundation trenches were largely carried out prior to CFA arriving on site and were not monitored.
- 2.3 The partially exposed subsoil across the site was cleared of spoil-heaps and overburden under archaeological supervision and examined for archaeological features/deposits. This operation was carried out using a JCB equipped with a smooth bladed ditching bucket, with the final cleaning being carried out by a member of CFA field staff using hand tools.
- 2.4 The sections of the open foundation trenches were cleaned and checked for archaeological features and deposits.
- 2.5 All excavation and on-site recording was carried out according to standard CFA procedures, principally by drawing, by photography and by completing standard CFA record forms.

## **3. ARCHAEOLOGICAL RESULTS (Fig 2)**

- 3.1 The area cleared for the new extension to Duddingston Church Hall was roughly L-shaped, measuring c.30m by 20m overall. The overburden consisted of building rubble associated with the demolished original extension and up to c.0.3m of dark brown silt topsoil overlying reddish brown sandy clay natural subsoil.
- 3.3 The foundation trenches measured c.0.8m wide and were cut into the subsoil to a depth of 0.6m.
- 3.4 No features or deposits of archaeological significance were uncovered during the course of the watching brief, and there was no evidence that the unmonitored works had damaged archaeological remains.

#### **4. SUMMARY**

- 4.1 A watching brief was carried out during groundbreaking works for an extension to Duddingston Church Hall.
- 4.2 There were no features or deposits of archaeological significance identified during this watching brief.
- 4.3 The project archive, comprising all CFA record sheets, maps and reports, will be deposited with the National Monuments Record of Scotland (NMRS) and copies of the report will be lodged with the City of Edinburgh Council Sites and Monuments Record.
- 4.4 A summary statement of the results of this watching brief, submitted for publication in *Discovery and Excavation in Scotland*, will be sufficient to disseminate the results of this work.

## APPENDIX 1

### Photographic Register

*Colour Slide: Film 1*

Shot	Description	Taken from	Conditions
1-12	General post-excavation shots of foundation trench	Various	Rain
13-18	General shots of site with spoil heaps removed	Various	Sun

## APPENDIX 2

### DES Entry

<b>LOCAL AUTHORITY:</b>	City of Edinburgh Council
<b>PROJECT TITLE/SITE NAME:</b>	Duddingston Church Hall, Duddingston Village, Edinburgh
<b>PROJECT CODE:</b>	DUDD
<b>PARISH:</b>	City of Edinburgh
<b>NAME OF CONTRIBUTOR:</b>	Magnus Kirby
<b>NAME OF ORGANISATION:</b>	CFA Archaeology Ltd
<b>TYPE(S) OF PROJECT:</b>	Watching Brief
<b>NMRS NO(S):</b>	NT27SE 198.01
<b>SITE/MONUMENT TYPE(S):</b>	Church Hall
<b>SIGNIFICANT FINDS:</b>	N/A
<b>NGR (2 letters, 6 figures)</b>	NT 2852 7266
<b>START DATE (this season)</b>	August 2006
<b>END DATE (this season)</b>	August 2006
<b>PREVIOUS WORK (incl. DES ref.)</b>	N/A
<b>MAIN (NARRATIVE) DESCRIPTION:</b> (May include information from other fields)	An archaeological watching brief was carried out during ground-works for an extension to Duddingston Church Hall. There were no features or deposits of archaeological significance uncovered.
<b>PROPOSED FUTURE WORK:</b>	None
<b>CAPTION(S) FOR ILLUSTRS:</b>	N/A
<b>SPONSOR OR FUNDING BODY:</b>	The Congregational Board of Duddingston Kirk
<b>ADDRESS OF MAIN CONTRIBUTOR:</b>	The Old Engine House, Eskmills Park, Musselburgh, East Lothian, EH21 7PQ
<b>EMAIL ADDRESS:</b>	cfa@cfa-archaeology.co.uk
<b>ARCHIVE LOCATION (intended/deposited)</b>	The National Monuments Record of Scotland and the City of Edinburgh Council Sites and Monuments Record



Development area

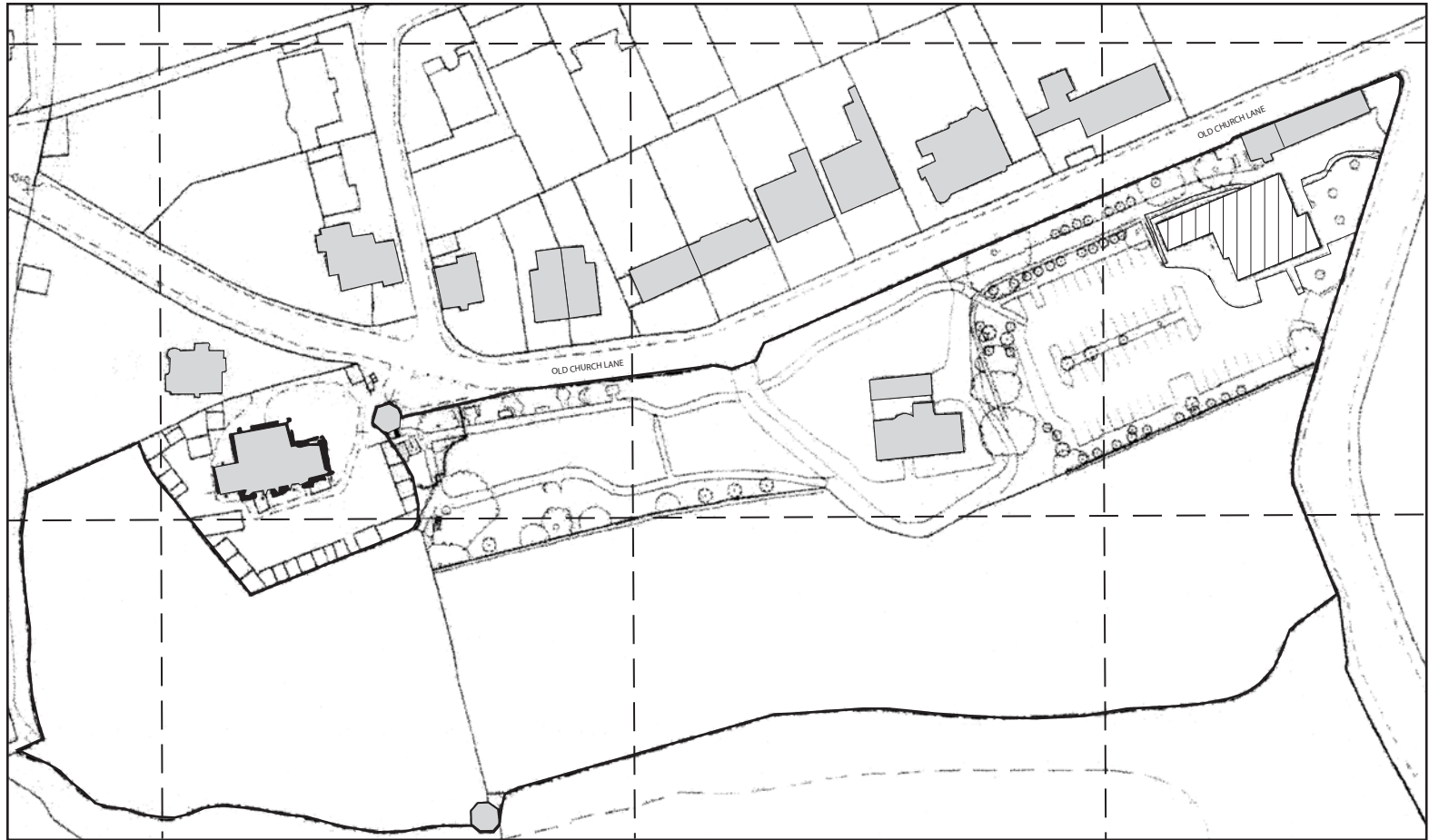



-  Development area
-  Buildings



Fig. 1 - Site location.

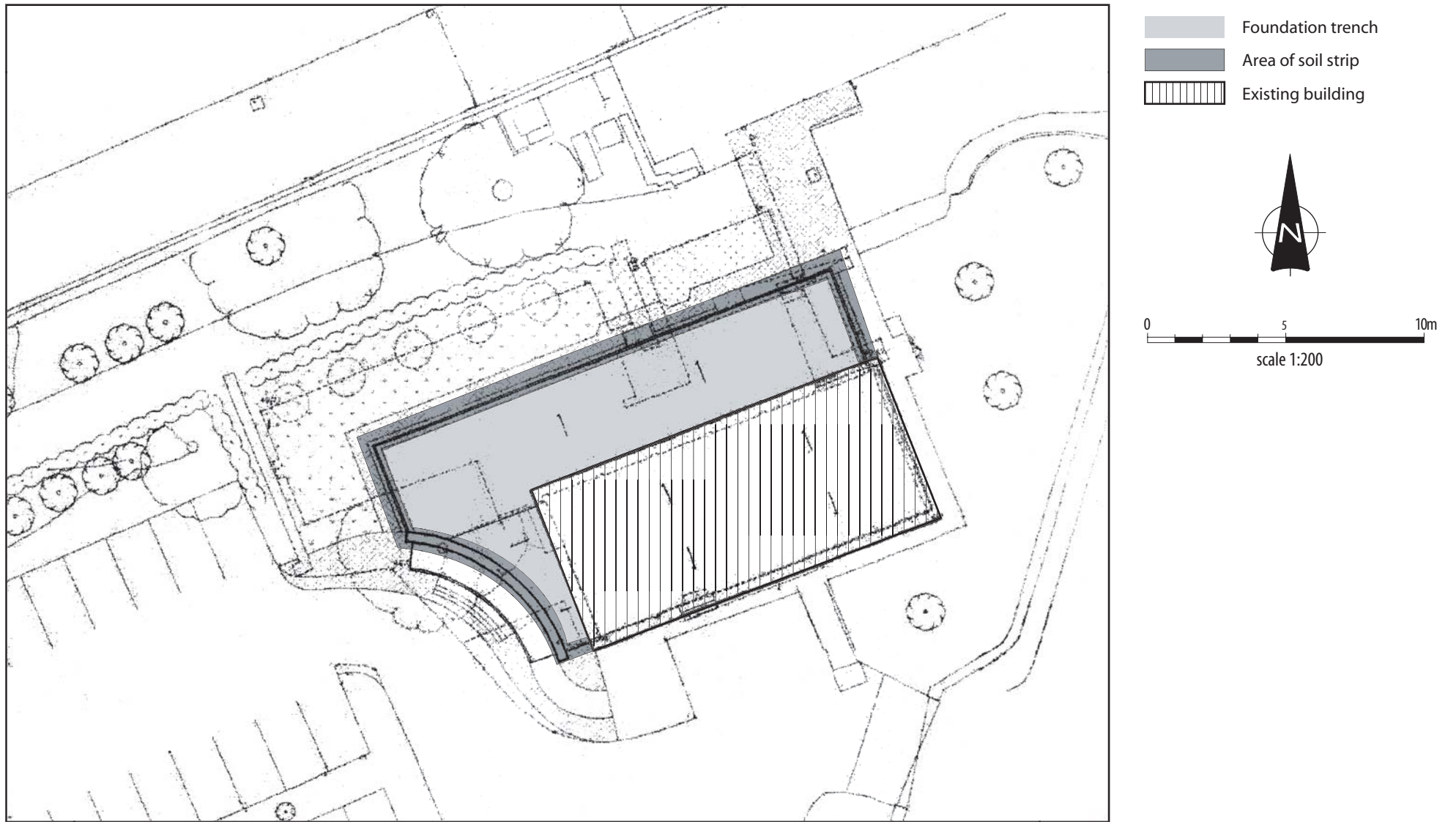

Fig. 2 - Plan of church hall and extension.