

**Report of Archaeological Recording
September 3rd – November 24th 2003
West Torbreck, Inverness
NH 6433 / 4034 (centred)**

Client: Mr. N Sutherland

Planning Application No: 03/00540/FULIN

**By
Stuart Farrell
B.A A.I.F.A F.S.A.Scot.
December 2003**

Contents

1. Introduction
 2. Acknowledgements
 3. Background
 4. Objectives
 5. Method
 6. Results of Evaluation and Watching Brief
 7. Conclusions
 8. Recommendations
 9. Archive
 10. Discovery and Excavation
 11. References
- Appendix 1 – Photographic Register
2 – Context Register
3 – Flint Catalogue

Non-Technical Summary

Stuart Farrell was commissioned by Mr. N Sutherland in August 2003 to undertake an archaeological evaluation and watching brief at West Torbreck (NH 6433/4034) as part of a house development. Highland Council Archaeology Unit produced a specification for this work.

Work was sited close to the stone circle of Torbreck. Trial trenching revealed four small pits, of which one contained flint including a scrapper and sherds of late Neolithic pottery. One other pit which contained flint was partly damaged by ploughing whilst the two others contained stones. No other features of interest were revealed when larger areas were opened up for house plots, etc or when watching briefs were conducted.

No recommendations are to be made for further work.

1. Introduction

This report is for an archaeological evaluation and watching brief conducted on behalf of Mr. N Sutherland by the author for a house plot, associated access and features relating to a small farmstead at West Torbreck, Inverness. This work is for planning application 03/00540/FULIN.

The fieldwork was conducted between September 3rd and November 24th 2003.

2. Acknowledgements

I would like to thank the following for their help during the work:

- Mr. N Sutherland;
- Mr. J Hepburn-Wright of Adrem Cartographic Services Ltd for site survey work;
- Mr, J Welsh for onsite help;
- Staff of Angus Fraser Contractors for onsite work;
- Staff of Highland Council Archaeology Unit;
- Staff of the RCAHMS;
- Staff of the NMRS;
- Staff of Highland Council Archives
- Dr. T B Ballin for post-excavation analysis of the flint;
- Dr. A MacSween for post-excavation analysis of the pottery;
- Mrs S Stevenson for illustration of finds.

Stuart Farrell
39a Park Street
Nairn
Highland
IV12 4PP

Figure 1 – General Location 1: 50,000

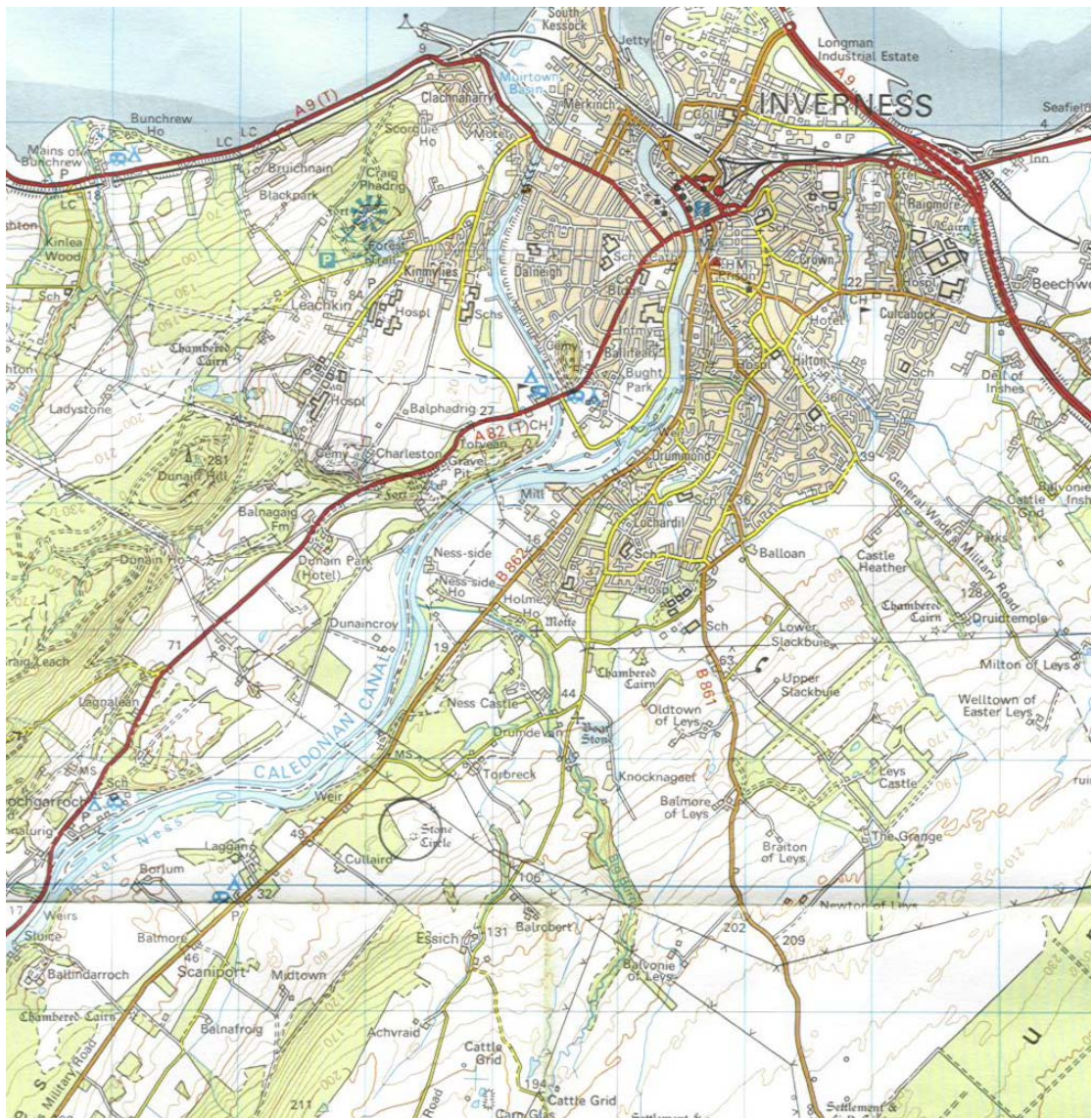

Neil Sutherland Archi

Figure 3 – 1st edition Ordnance Survey Map of 1871 1: 2500
Development Area outlined in Red

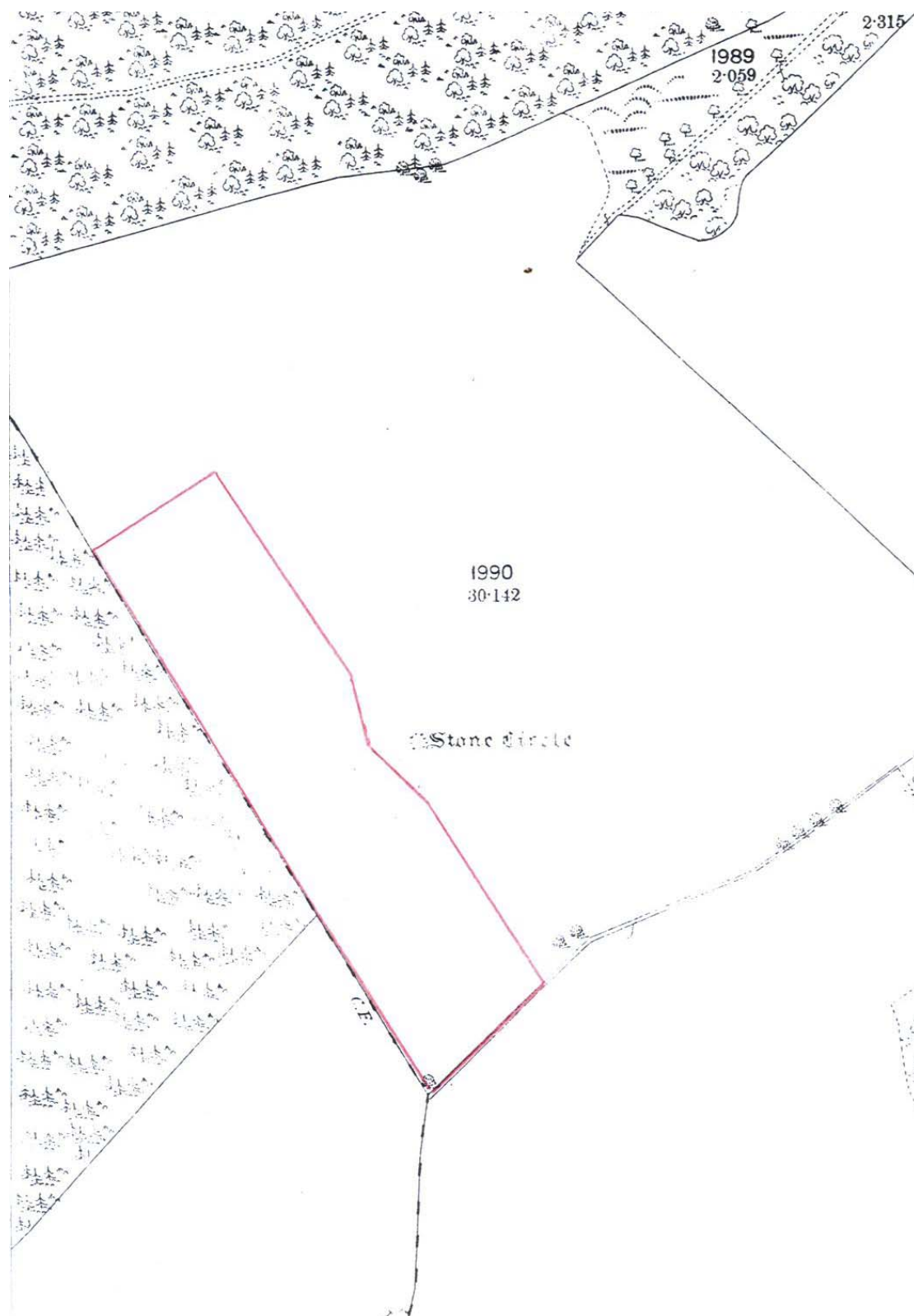

Figure 4 – 2nd edition Ordnance Survey Map of 1904 1: 2500
Development Area outlined in Red

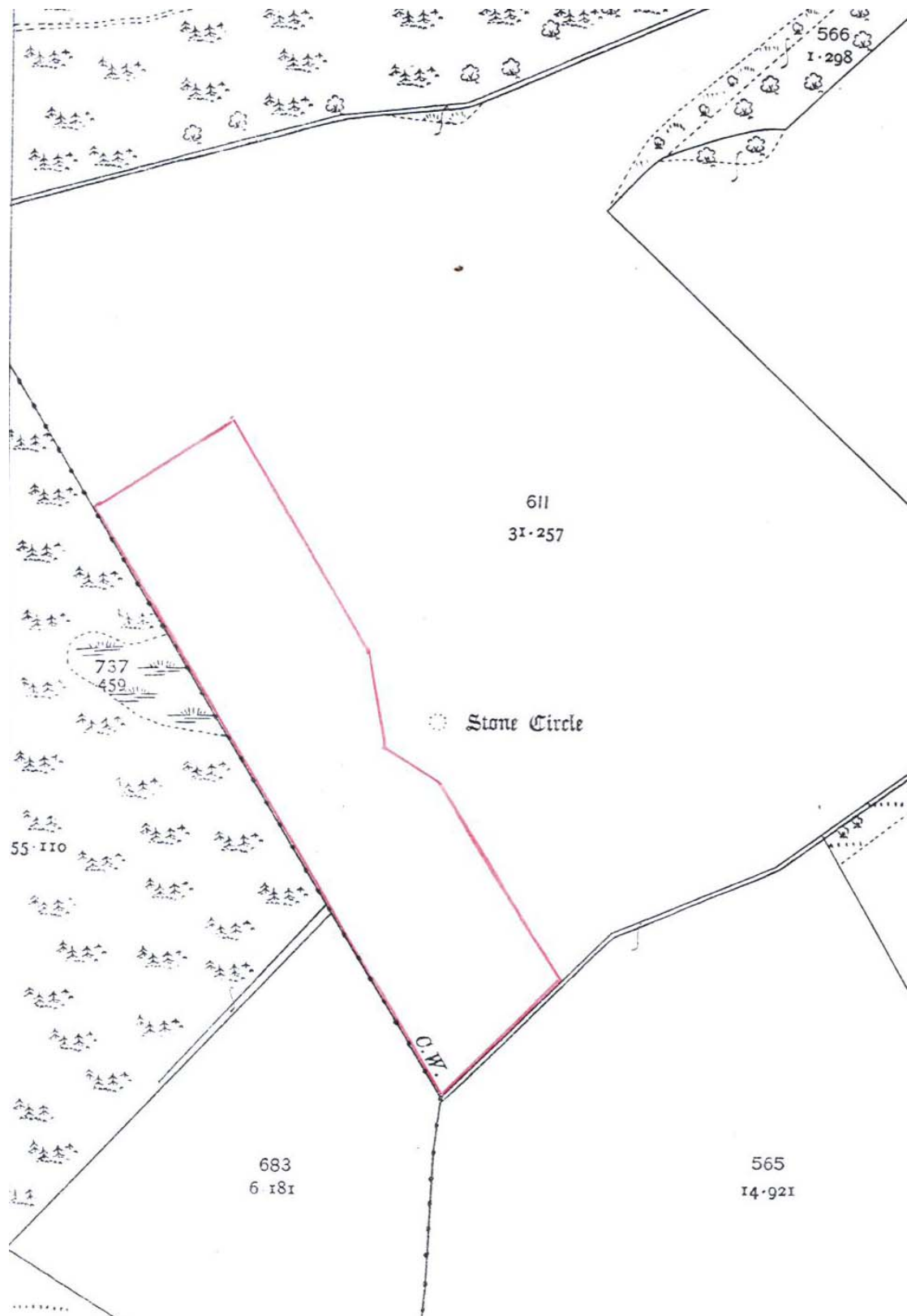

Figure 5 – Plan of Torbreck Stone Circle by J Hunter

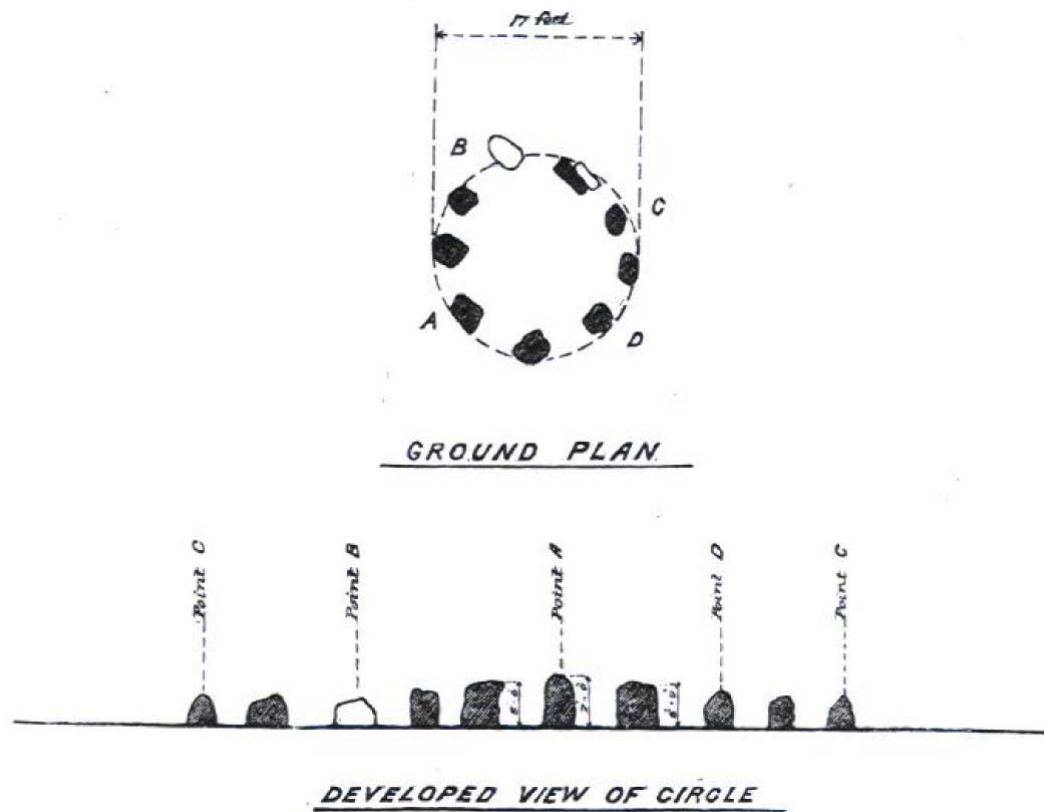

Figure 7 – Areas of Watching brief – (Marked in Yellow) 1: 2000

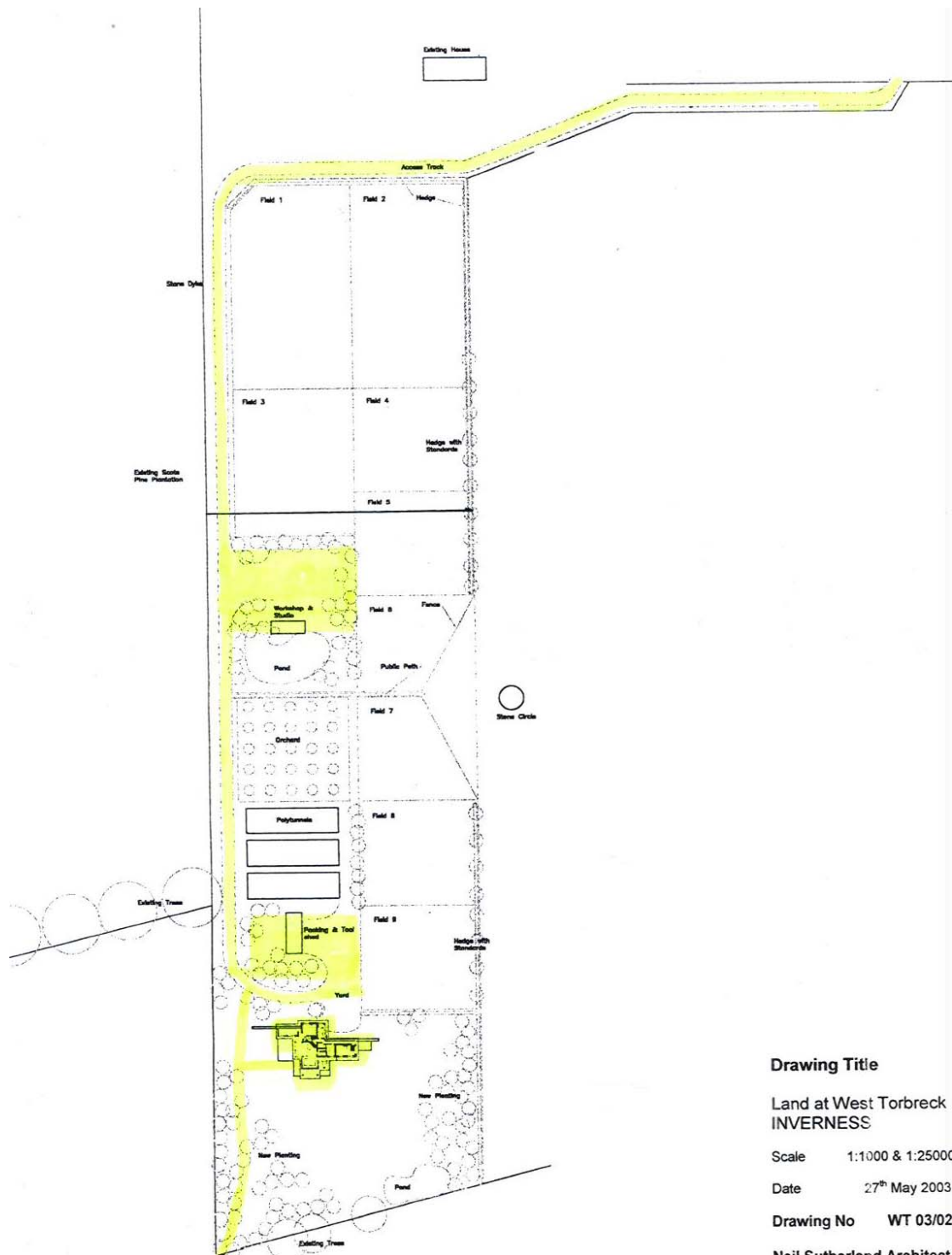

Figure 8 – RAF Aerial Photograph of 1946 1:5000



3. Historical Background

The proposed house plot and associated buildings lies close to the following archaeological site:

Torbreck

HSMR – NH64SW 1

NMRS – NH64SW 1

Grid Ref – NH 6437/4037

Type – Stone Circle

Noted in Highland Sites and Monuments Record and the National Monuments Record of Scotland CANMORE database of:

‘A complete circle consisting of nine stones, at a short distance from which are two other stones, supposed to be the remains of an outer Circle’. (Ordnance Survey Name Book 1868) Noted by James Fraser (1884) that ‘The circle at Torbreck seems to have been interfered with in improving the field in which it stands. At one time three concentric circles, with a passage connecting the outer and inner rings were visible.’ Noted by Henshall (1963, 385) in 1957 that ‘Fraser’s plan shows a circular setting of nine evenly spaced upright stones with an external diameter of 17ft. It does not appear to be part of a chambered cairn; Fraser suggested the stones had been moved but it seems more likely that it is a stone circle.

Site visited by Ordnance Survey again in 1962 and recorded as ‘A stone circle of 9 almost evenly spaced monoliths (maximum height 1.2m) with an overall diameter of 7.8m. A quantity of small stones lies upon the site, but these appear to be the result of field clearance. The site lies within a cultivated field. There are no traces of an outer circle’.

James Fraser (1883) believed that a number of stones had been removed from the circle with ‘the large stones in it appear to belong to an outer ring obliterated’. His plan of the circle (see figure 5) includes 2 stones that may have been moved (stones not shaded). Possibly these are the two stones noted by the Ordnance Survey in 1868.

Site is a Scheduled Ancient Monument protected since 1971. Visit by Historic Scotland’s Monument Warden in 1991 noted that there was 2 small heaps of field clearance to the edge of the stones. Site is not noted by Burl (2000) other than to appear in his gazetteer of sites.

Past archaeological work has been limited to the area around the stone circle. A watching brief was conducted by the author to the north edge of the development area (NH 64301/40577) that revealed no archaeological features or deposits though the site was on a north-facing slope. (Farrell, 2002a) Further to the east at Torbreck there has been the find of Neolithic pits including cremated animal bone of a Neolithic date (Farrell, 2002b).

Nothing is marked to the development location except the stone circle on the 1st or 2nd edition Ordnance Survey Maps of 1874 and 1906 respectively (see figures 3 and 4). Field was recorded as being planted with arable by the Ordnance Survey in 1870. (OS, 1870) The field is recorded as Clachandreggie (Stoneyfield) in farm documents of Torbreck Farm dating to 1831 (HC Archives) (This name is still known locally at Torbreck Farm – information from Mr. N Sutherland).

A study of aerial photographs held in the Royal Commission on the Ancient and Historic Monuments of Scotland, Edinburgh revealed only one visible feature of a possible field boundary running NW-SE to the north of the stone circle with the rest of the field having evidence of being heavily ploughed (see figure 8). This boundary was partly visible on photographs to 1953. Aerial photograph coverage

was limited to Royal Air Force photographs from the period 1946 to 1953 with the latest coverage of 1988 being at too large a scale for any details to be identified.

4. Objectives

To conduct an evaluation to 10% of the development area and to follow that with a watching brief on the excavation of the development to record those features revealed by excavation work. A copy of the specification provided by Highland Council Archaeology Unit is enclosed.

5. Methodology

Trenches were located in relation to proposed buildings, roads and parking, poly-tunnels and proposed ponds and services. A monitoring was made of the removal of topsoil and subsoil's to an average depth of 350mm for the development area for 17 trenches to an area of 654m². A back-acting machine with a straight edged bucket cleared the site with possible archaeological features being cleaned by hand.

Weather on the days of work (September 3rd – November 24th 2003) was generally clear and sunny.

6. Results of Evaluation and Watching Brief

The evaluation and watching brief was carried out in accordance with accepted professional archaeological standards as published by the Institute of Field Archaeologists (IFA 1999). Over the construction period a suitably qualified archaeologist was on site to carry out observations and assessment of the area affected by the excavation works.

Site Location

The site lies to the west of Torbreck stone circle in an area of current grass pasture. The field is partly on a partial south-facing slope with an underlying natural of gravels and sand.

Evaluation Results

Trenches were placed at random, as no potential archaeological features were revealed in the desktop survey, being placed in relation to the proposed house, road, workshop, poly tunnels, orchard, pond and studio. Excavation of the 17 trenches made, all 1.6m wide (see figure 6) revealed the following:

1 – 17.8m E-W in area of house plot. One small shallow round pit was revealed to the E end of the trench containing pottery (identified as late Neolithic) and flint including half of a small scrapper. (See specialist reports below). Fill deemed not suitable for sampling by excavator.

Top: Section 1:10.
 Below left: Plan of pit 1:20.
 Below right: View of pit facing E – scale 0.5m.

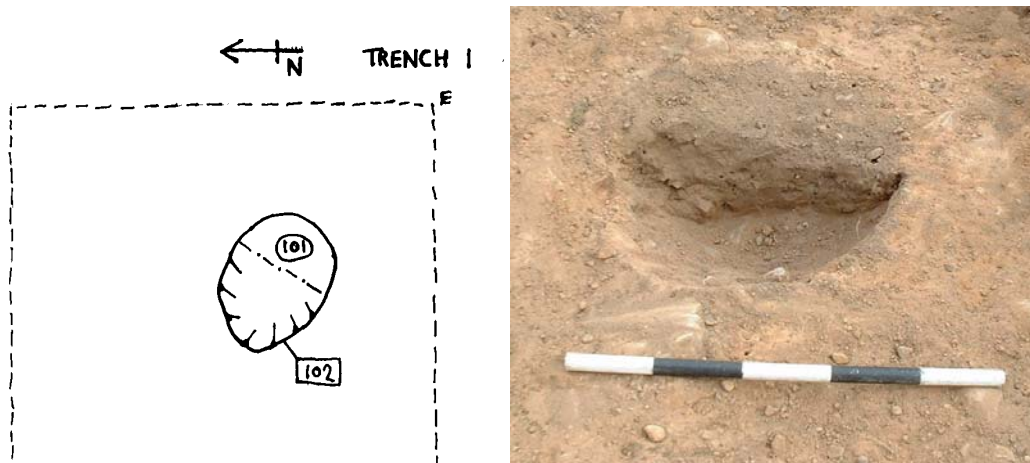
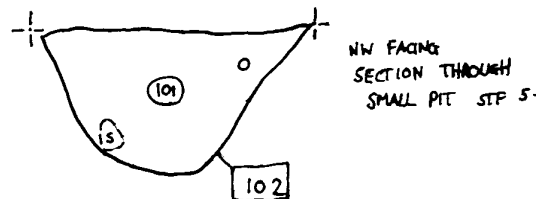

2 – 27.8m EW in area of house plot. One small shallow truncated round pit was revealed to the centre of the trench containing flint (See specialist report below). Fill deemed not suitable for sampling by excavator due to extensive damage by ploughing. Plough scaring also visible running N-S in trench.

Top: Section 1:10, plan 1:20.
 Over: View of pit facing W – scale 0.5m.

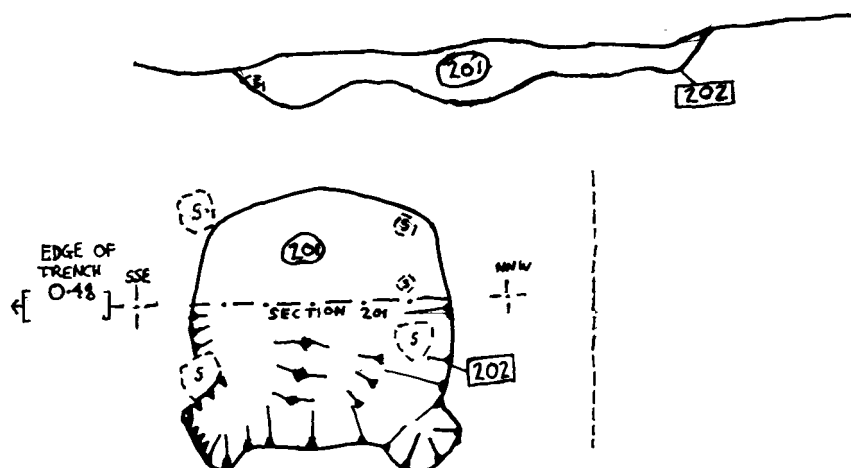



3 – 10.6m EW in area of road. No archaeological features or deposits were revealed.

4 – 19.2m EW in area of workshop. No archaeological features or deposits were revealed.

5 – 18m EW in area of workshop. No archaeological features or deposits were revealed.

6 – 27.7m EW in area of poly tunnels. One medium sized but shallow pit was revealed to the E end of the trench. Heavily filled with round medium to large stones (making for a very difficult section) and little fill. No finds were made or dateable material. Possible stone hole (?). Fill deemed not suitable for sampling by excavator due to stones.

Top right: Plan 1:20.

Top left: section 1:10.

Over: View facing SE – scales 1m.

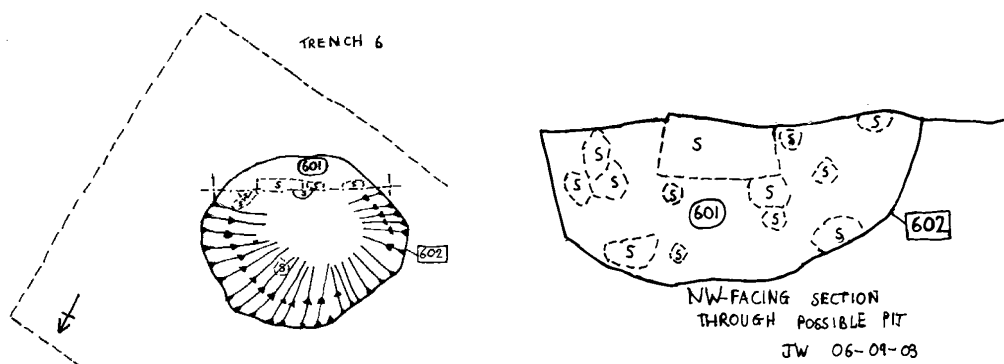



7 – 27m EW in area of poly tunnels. No archaeological features or deposits were revealed. One possible feature to the centre of the trench was revealed but deemed upon $\frac{1}{2}$ sectioning to be a tree bole due it being very irregular in plan and cut.

Below: View of tree bole facing E – scales 1m.



8 – 27.6m EW in area of poly tunnels. No archaeological features or deposits were revealed.

9 – 28m EW in area of poly tunnels. One irregular shaped pit was revealed to the centre of the trench. Heavily filled with medium to large round stones with some fill. No finds were made, though 2 fragments of burnt hazelnut shell were recovered and will be submitted for C14 dating. Fill deemed not suitable for sampling by excavator due to large amount of stones.

Top: Plan 1:20.
Middle: Section 1:10.
Below: View of cut facing SW – scales 1m.

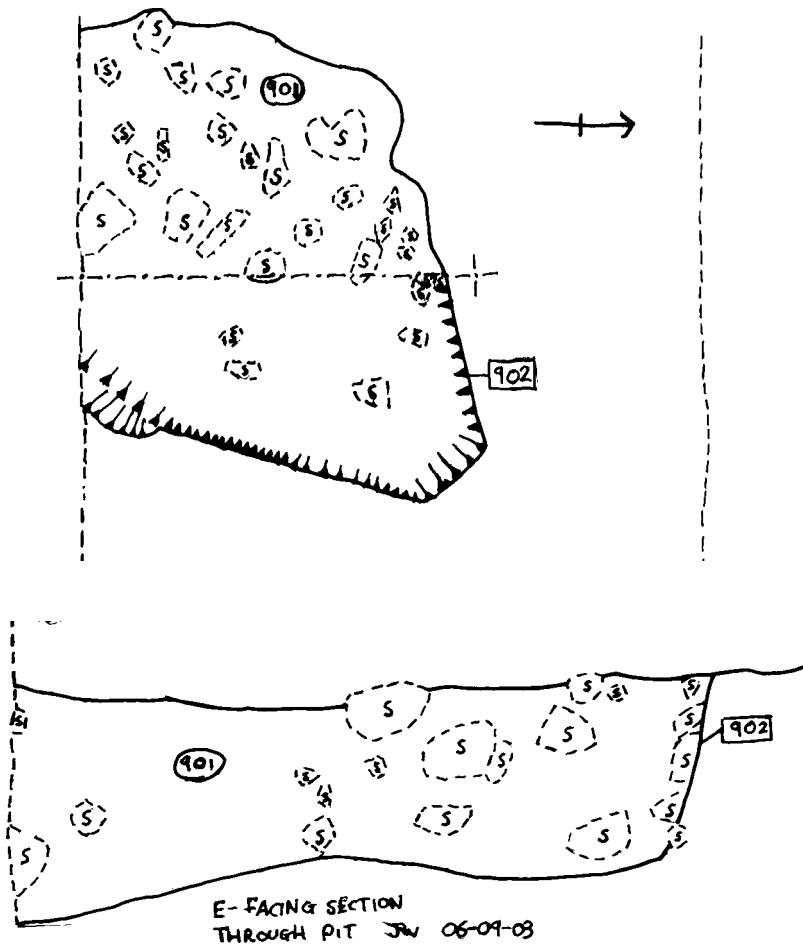

10 – 28.2m EW in area of poly tunnels. No archaeological features or deposits were revealed. One small infilled hollow of medium to large rounded stones relating to agricultural improvement was revealed to centre of trench.

11 – 29m EW in area of pond and studio. No archaeological features or deposits were revealed.

12 – 29.7m EW in area of pond and studio. No archaeological features or deposits were revealed. Large infilled hollow 5.5m wide to centre of trench of medium to large rounded stones, excavation (by machine) revealed depth of 0.8m in an area of wet silts.

13 – 29.3m EW in area of pond and studio. No archaeological features or deposits were revealed. A modern drainage ditch was revealed at the W end of the trench running NW-SE for 3.2m and 0.3m wide and 0.25m deep infilled with small rounded stones.

14 – 29.6m EW in area of pond and studio. No archaeological features or deposits were revealed. 1 possible feature was revealed upon excavation to a natural depression.

15 – 29.9m EW in area of pond and studio. No archaeological features or deposits were revealed.

16 – 15.5 NE-SW. No archaeological features or deposits were revealed. Evidence of plough scaring running N-S in natural.

17 – 13.8 NE-SW. No archaeological features or deposits were revealed. Evidence of plough scaring running N-S in natural.

The Flint by Dr. Torben B Ballin

During recent excavations at West Torbreck (Torbreck Farm), c. 3 km SW of Inverness, 15 lithic artefacts were recovered. All artefacts were found in connection with two pits, contexts 101 and 201. Pit 101 contained pottery sherds of a Late Neolithic date. The present site is situated near a stone circle (NGR: NH 6437 4037), and along the Torbreck Burn many, particularly late prehistoric, monuments have been found (eg, burnt mounds, hut circles and enclosures). The aim of the present report is to characterize, catalogue and – if possible – date the lithic finds.

Assemblage

From the excavation at the West Torbreck site the following artefacts were retrieved:

Table I. General artefact list.

	<i>Numbers</i>
Chips	1
Platform flakes	8
Bipolar flakes	4
Scraper-edge fragments	1
Flakes with retouch notch(es)	1
TOTAL	15

The definitions of the main lithic categories are as follows:

Chips: All flakes and indeterminate pieces the greatest dimension (GD) of which is ≤ 10 mm.

Flakes: All lithic artefacts with one identifiable ventral (positive or convex) surface, $GD > 10$ mm and $L < 2W$ (L = length; W = width).

Indeterminate pieces: Lithic artefacts which cannot be unequivocally identified as either flakes or cores. Generally the problem of identification is due to irregular breaks, frost-shattering or fire-crazing. *Chunks* are larger indeterminate pieces, and in, for example, the case of quartz, the problem of identification usually originates from a piece flaking along natural planes of weakness rather than flaking in the usual conchoidal way.

Blades and microblades: Flakes where $L \geq 2B$. In the case of blades $W > 8$ mm, in the case of microblades $W \leq 8$ mm.

Cores: Artefacts with only dorsal (negative or concave) surfaces – if three or more flakes have been detached, the piece is a core, if fewer than three flakes have been detached, the piece is a split or flaked pebble.

Tools: Artefacts with secondary retouch (modification).

Raw materials

The small assemblage consists entirely of good quality flint. Most of the flints have a honey-brown colour, but one piece is marbled dark/light grey [CAT 1], whereas two pieces are light olive-green [CAT 3, 4]. The presence of differently coloured flints suggests the reduction of at least three nodules at the site. Six of the artefacts are corticated, and the fact that this cortex is heavily abraded indicates the collection of raw material at a pebble source. Most likely, flint was acquired from beach deposits along the shores of the Moray Firth (cf. Fig 1 – off-shore Cretaceous flint deposits – Saville 1994, 58). None of the artefacts has been affected by fire.

Debitage

The majority of the artefacts (13 pieces or 87%) aredebitage, with one piece being a chip and 12 being flakes; no blades were found. Eight blanks are platform flakes (average dimensions: 17 x 15 x 4 mm), and seven of these were unequivocally identified as hard-hammer flakes; it was not possible to determine the type of percussion applied to detach platform flake CAT 11. Four of the blanks are bipolar ('hammer-and-anvil') flakes (av. dim: 30 x 17 x 8 mm). No primary flakes were recovered, with five being secondary and seven tertiary. Five of the platform flakes, or approximately two-thirds, have trimmed platform-edges. Flakes CAT 3 and 6 have macroscopic lateral use-wear indicating use as unmodified knives.

Illus 1. Dimensions of all flakes: red dots = platform flakes; blue dots = bipolar flakes.

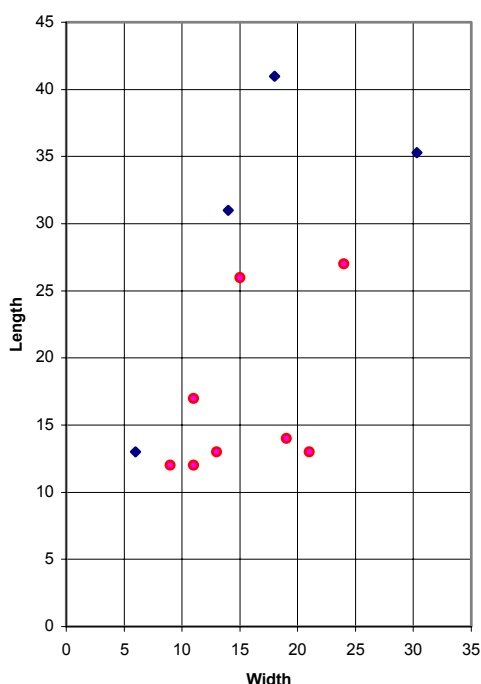

Tools

Only two tools were retrieved during the excavation, namely a scraper-edge-fragment [CAT 1] and a notched piece [CAT 7]. CAT 1 is the broken-off corner of a relatively large (30 x 12 x 5 mm), probably approximately oval, end-scraper on a platform flake. The retouch is regular, convex and steep, and after fragmentation the piece was blunted along the sharp dorsal edge of the break to allow continued use, now in the form of an elongated side-scraper. CAT 7 is a small platform flake (26 x 17 x 9 mm) with a shallow distal notch (chord = c. 5 mm). In magnification it is possible to identify fine retouch to the right of this notch, and it is likely that this piece is either a damaged end-scraper or a re-functioned end-scraper. Neither of the two lateral sides is regular or acute enough to make the implement an effective knife.

Technology

The industry responsible for the West Torbreck assemblage obviously represents a mixed platform/bipolar technology. Due to the size of the assemblage, it is not possible to say how the two approaches were combined, that is, whether platform technique and bipolar technique represent a sequence (for example, with bipolar technique applied to totally exhaust abandoned platform cores), or two parallel approaches (for example, with bipolar technique applied to reduce smaller nodules, and platform technique to reduce larger nodules), or both.

As mentioned above, the raw material is pebble flint, most likely collected along the beaches of nearby Moray Firth. The fact that no primary flakes, or cores, are present suggests that decortication and blank production may have taken place elsewhere. No core preparation flakes were found, but the widespread use of delicate trimming defines the technology as relatively sophisticated. The dorsal face of CAT 7 is characterized by the remains of an old platform-edge. This indicates that the blank was detached from either a core with two platforms at an angle or an irregular (multi-platform) core.

The platform flakes were generally manufactured by the application of hard direct percussion (pronounced bulbs), and three flakes [CAT 4, 8, 13] have multiple

bulbs due to the use of insufficient force. Other attributes indicative of hard percussion are circular impact scars [CAT 9], cracked platform remnants [CAT 4, 10], and large bulbar scars [CAT 6, 7]. Several flakes [CAT 4, 6, 9, 12] are characterized by distal hinge fractures, suggesting the use of insufficient force. Three of the eight platform flakes [CAT 7, 9, 12] have a faceted platform remnant, which is either indicative of the detachment of partial core tablets, or the re-orientation of the core during blank production. In the latter case, the faceting represents the flake scars of a prior flaking front and suggests re-orientation of the core, an option supported by the dorsal crest of CAT 7 (an old platform-edge). In summary, the flint artefacts from West Torbreck are the products of a flake industry, including the application of bipolar technique and hard percussion. Some elements, such as the consistent use of trimming, define the industry as relatively sophisticated, whereas other elements, such as multiple bulbs and hinge fractures, suggest lack of control.

Dating

The assemblage includes no diagnostic types, but the association of the flints with diagnostic pottery suggests a Late Neolithic date. A late prehistoric date is supported by several technological attributes, such as the absence of blades and the relative crudeness of the industry (pronounced and multiple bulbs, circular impact scars, hinge fractures, etc.). The consistent use of trimming as a form of core preparation speaks against a *post* Neolithic date (Ballin 2003; forthcoming). The proximity of pits 101 and 201 to the above-mentioned stone circle also supports a Late Neolithic date though, admittedly, the pits have not been proven to form part of this monument.

Discussion

Despite the fact that the association of pits 101 and 201 with the nearby stone circle has not been proven, it is quite likely that the probably Late Neolithic pits formed part of the almost certainly Late Neolithic monument. The fact that the small assemblage includes no primary material or cores suggests that the flints were produced and carefully selected at some presently unknown location for deposition in the pits. Several of the blanks have worn lateral edges, demonstrating that the artefacts were not manufactured for the occasion – unless the tasks producing this macroscopic use-wear were ritual activities associated with the deposition in pits at the periphery of the stone circle.

Though in some cases, worked lithics from late prehistoric ritual sites are found sparsely scattered throughout the site (eg, Beckton farm; Pollard 1997, 99), the deposition of lithics in late prehistoric pits is known (eg, Raigmore; Simpson 1996, 74). The Raigmore site is located not far from West Torbreck, on the east side of Inverness, and though this material may be roughly contemporary with the assemblage from West Torbreck, it seems to represent general settlement debris (charcoal, pottery and flints; *ibid*, 61), in contrast to the carefully selected material from pits 101 and 201.

Below: Scraper from pit in trench 1. Scale 2:1.

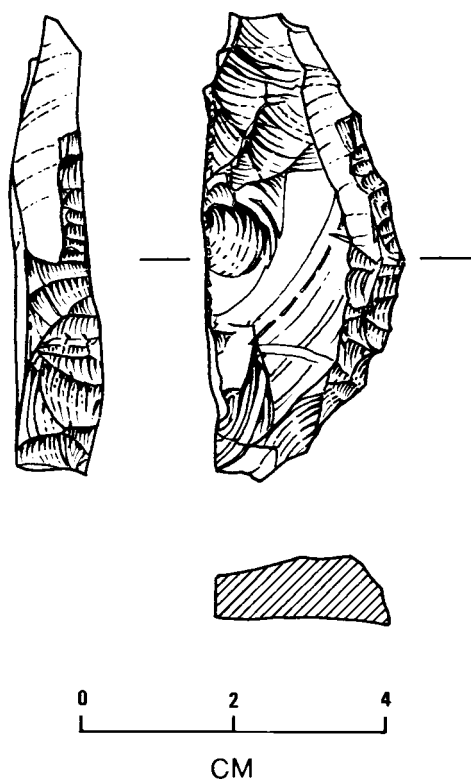

The Prehistoric Pottery by Dr Ann MacSween

The pottery recovered forms part of 2 vessels. One represented by a carinated rim sherd and a body sherd broken into 2. The surface has been finished by a wet hand to a smooth finish. Fabric is fine clay with about 50% rock fragments (black & white) that is fired hard and red/brown in colour.

The second vessel is represented by 1 sherd and 1 abraded fragment. The fabric is fine clay with about 70% mixed rock inclusions that has fired hard and is red in colour. Both are possibly late Neolithic in date.

Below: Pottery from pit in trench 1 – scale 1:1. Both possible variations to form are given.

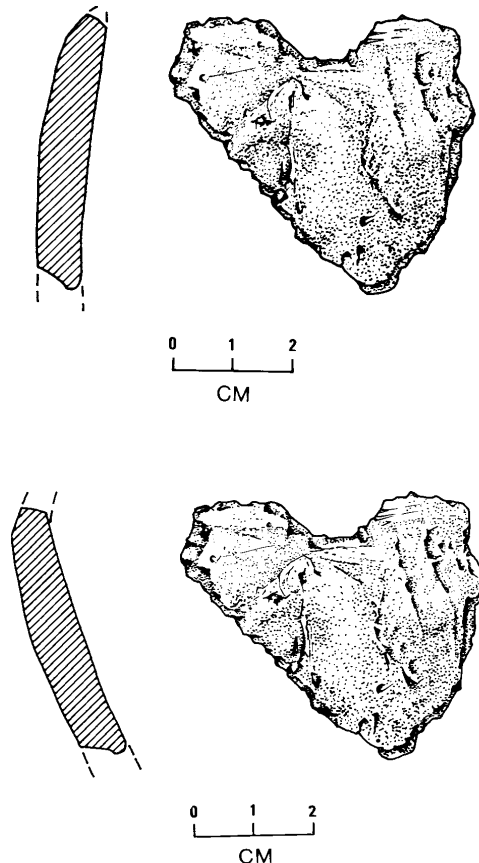

Watching Brief Results

A watching brief was maintained on the excavation for the road (the width of 5m to encompass a drainage ditch and the water supply trench), excavation of the areas for the house, workshop and studio and areas of parking (of 3 area's totalling 600m²) and the electricity supply trench from the SW corner of the site north and branching E to the house and to the road (1.2m wide for a total length of 87m; this last section of watching brief was conducted on the 24th November).

The watching brief on these areas did not reveal any additional archaeological features or deposits. One possible feature was revealed during the excavation of the electricity supply trench but upon investigation was revealed to be a tree-bole.

7. Conclusions

The two pits found to the SW of the stone circle were the only two pits out of the four revealed that produced any finds. As both of these features were cut into yellow sand rather than the orange-brown stony gravel to the north it is possible that other features lie to the edge of the existing burn to the south and south-east area of the development area. Unfortunately none of the fills of the pits revealed were substantial or contained organic material for sampling. Part of the pottery and the hazelnut shells will be submitted for C14 dating.

The finds of the Neolithic pottery and flint is further evidence of a wider Neolithic settlement in this valley especially in relation to the finds made at Torbreck to the east, though further study in the wider area will be required to try and understand the overall settlement pattern.

The field overall has seen signs of agricultural improvement with infilled hollows, a drainage ditch and tree-boles (possible forming part of smaller fields), also evident was modern plough scarring over parts of the site. This later ploughing had damaged the feature found in trench 2 (context 202) and may have caused damage or loss to other archaeological features in the field.

8. Recommendations

No recommendations with regard any further fieldwork for this project is to be proposed due to no further fieldwork being required, though any further development to this site should have an archaeological investigation.

Part of the pottery and hazelnut shells recovered will be submitted for C14 dating and a report on their results be made at a later date.

9. Archive

The following is to be deposited in the National Monuments Record in Edinburgh:

- Notebook of results
- Black and white photographs
- Plan and section drawings
- Context sheets
- Photographic record sheets
- Colour chart
- Copy of this report

A set of black & white photographs of the features excavated and colour slides showing the progress of the work has been deposited with Highland Council Sites and Monuments Record. Digital images used in this report have been deposited with HSMR on disc as well as a copy of this report as a PDF file.

10. Discovery & Excavation in Scotland

A short summary of the results of this project will be submitted to the Council for Scottish Archaeology's publication *Discovery & Excavation in Scotland*.

11. References

- Ballin, T.B (2003) Later Bronze Age Flint Technology: A presentation and discussion of post-barrow debitage from monuments in the Raunds area, Northamptonshire. *Lithics* 23, 2002, 3-28.
- Ballin, T.B. forthcoming: The Lithic Assemblage. In A. Cameron: Excavations at the Green, Aberdeen: a medieval Carmelite House revealed. *Internet Archaeology*.
- Burl, A (2000) *The Stone Circles of Britain, Ireland and Brittany*. Yale University Press. New Haven.
- Farrell, S (2002a) Report of Archaeological Watching Brief 12th November 2002 Wester Torbreck, Highland - NH 64301 / 40577. Unpublished report – copy held by HSMR.
- Farrell, S (2002b) Final Report of Archaeological Watching Brief September 2002 Torbreck, Highland. Unpublished report – copy held by HSMR.
- Fraser, J (1883) Descriptive notes on the stone circles of Strathnairn and neighbourhood of Inverness. *Transactions of the Inverness Scientific Society and Field Club* 2, 360-79.
- Fraser, J (1884) Descriptive Notes on the Stone Circles of Strathnairn and neighbourhood of Inverness, with plans, etc. *Proceedings of the Society of Antiquaries of Scotland* 18, 328-362.
- Henshall, A (1963) *The Chambered Tombs of Scotland*. Volume 1. Edinburgh University Press. Edinburgh.
- Highland Council Archives – D299 Records of Torbreck Farm.
- Highland Council Sites and Monuments Record for NH64SW 1.
- IFA (1999) *By-laws, Standards and Policy Statements of the Institute of Field Archaeologists*. Reading.
- National Monuments Record of Scotland CANMORE database entry for NH64SW 1.
- Ordnance Survey Name Book 1868 parish of Inverness book 31 page 72.
- Ordnance Survey (1870) *Book of Reference to the Plan of the Parish of Inverness and Bona in the County of Inverness*. HMSO.
- Pitts, M.W., & Jacobi, R.M (1979) Some Aspects of Change in Flaked Stone Industries of the Mesolithic and Neolithic in Southern Britain. *Journal of Archaeological Science* 6, 163-177.
- Pollard, T (1997) Excavation of a Neolithic settlement and ritual complex at Beckton Farm, Lockerbie, Dumfries & Galloway. *Proceedings of the Society of Antiquaries of Scotland* 127, 69-121.
- Saville, A (1994) Exploitation of Lithic Resources for Stone Tools in Earlier Prehistoric Scotland. In N. Ashton, & A. David (Eds.): *Stories in Stone*. Lithic Studies Society, Occasional Paper 4, 57-70. London: Lithic Studies Society.
- Simpson, D.D.A. 1996: Excavation of a kerbed funerary monument at Stoneyfield, Raigmore, Inverness, Highland, 1972-3. *Proceedings of the Society of Antiquaries of Scotland* 126, 53-86.

Maps Consulted

Ordnance Survey 1st edition 1:2500 sheet 12.13 Inverness-shire of 1871 surveyed 1867-71.

Ordnance Survey 2nd edition 1:2500 sheet 12.13 Inverness-shire of 1904 revised 1904.

Ordnance Survey 1:10,000 NH64SW 1968.

Aerial Photographs Consulted

RAF 106G/Uk 1320	5141-5143	28-3-1946	1:5000
RAF CPE/Scot/UK252	3091-3090	9-8-1947	1:10,000
RAF 541/A/435	4075-4074	27-7-1948	1:10,000
RAF 58/RAF/1116	F21: 4-5	5-5-1953	1:10,000
OS 61188	55-54	14-5-1988	1:24,000

Appendix 1 – Details of Black & White Photographs and Colour Slides

Film 1

- 1 – View of stone circle facing SE.
- 2 – View of site of house plot before excavation facing E.
- 3 – View of site of access road facing W.
- 4 – View of site facing N.
- 5 – View of site facing S.
- 6 – View of clearance cairn to SW corner of field.
- 7 – Detail of pit in trench 2 before excavation facing W – scale 1m.
- 8 – Detail of pit in trench 2 upon ½ section facing W – scale 1m.
- 9 – Detail of pit in trench 2 upon ½ section facing W – scale 0.5m.
- 10 – View of N section of access road after stripping of topsoil facing W.
- 11 – Ibid to NW corner facing W.
- 12 – View of trench 1 upon excavation facing W – scales 1m.
- 13 – View of trench 1 upon excavation facing E – scales 1m.
- 14 – Detail of pit in trench 1 upon ½ section facing E – scale 0.5m.
- 15 – View of trench 2 upon excavation facing W – scales 1m.
- 16 – View of trench 2 upon excavation facing E – scales 1m.
- 17 – View of trench 3 upon excavation facing W – scales 1m.
- 18 – View of trench 4 upon excavation facing E – scales 1m.
- 19 – View of trench 5 upon excavation facing E – scales 1m.
- 20 – View of trench 15 upon excavation facing W – scales 1m.
- 21 – View of trench 15 upon excavation facing E – scales 1m.
- 22 – View of trench 14 upon excavation facing W – scales 1m.
- 23 – View of trench 14 upon excavation facing E – scales 1m.
- 24 – View of trenches 1-15 facing S.
- 25 – Ibid.
- 26 – View of excavation for house plot facing E.
- 27 – Detail of modern drainage ditch in trench 13 facing SE – scale 1m.
- 28 – View of trench 13 upon excavation facing W – scales 1m.
- 29 – View of trench 13 upon excavation facing E – scales 1m.
- 30 – View of trench 12 upon excavation facing W – scales 1m.
- 31 – View of trench 12 upon excavation facing E – scales 1m.
- 32 – Detail of infilled hollow with stones in trench 12 facing NE – scales 1m.
- 33 – View of excavation of hollow facing W.
- 34 – View of trench 11 upon excavation facing W – scales 1m.
- 35 – View of trench 11 upon excavation facing E – scales 1m.
- 36 – View of trench 10 upon excavation facing W – scales 1m.

Film 2

- 1 – View of trench 10 upon excavation facing E – scales 1m.
- 2 – Detail of small infilled hollow in trench 10 facing N – scales 1m.
- 3 – View of excavation for house plot facing S.
- 4 – View of excavation for workshop facing E scales 1m.
- 5 – View of excavation for workshop facing SE – scales 1m.
- 6 – View of excavation for house plot facing S – scales 1m.
- 7 – View of excavation for house plot facing N – scales 1m.
- 8 – View of excavation for rear of house plot facing E – scales 1m.
- 9 – View of excavation for front of house plot facing W – scales 1m.
- 10 – View of trench 9 upon excavation facing W – scales 1m.
- 11 – View of trench 9 upon excavation facing E – scales 1m.
- 12 – Detail of ½ section of pit in trench 9 facing W – scales 1m.
- 13 – Ibid.
- 14 – View of trench 8 upon excavation facing W – scales 1m.
- 15 – View of trench 8 upon excavation facing E – scales 1m.
- 16 – View of trench 7 upon excavation facing W – scales 1m.
- 17 – View of trench 7 upon excavation facing E – scales 1m.
- 18 – View of trench 6 upon excavation facing W – scales 1m.
- 19 – View of trench 6 upon excavation facing E – scales 1m.
- 20 – Detail of ½ section of tree bole in trench 7 facing E – scales 1m.
- 21 – Ibid.
- 22 – Detail of section through pit in trench 6 facing SE – scales 1m.
- 23 – View of trench 16 upon excavation facing NE – scales 1m.
- 24 – View of trench 16 upon excavation facing SW – scales 1m.
- 25 – View of trench 17 upon excavation facing NE – scales 1m.
- 26 – View of trench 17 upon excavation facing SW – scales 1m.

Slides only – WB

- 27 – View of access road facing S upon excavation.
- 28 – View of access road facing N upon excavation.
- 29 – View of area excavation for studio facing W upon excavation.
- 30 – View of site of electricity trench facing S.
- 31 – View of SE corner.
- 32 – View of trench upon excavation facing S.
- 33 – View of trench upon excavation facing N – scales 1m.
- 34 – Detail of tree-bole upon excavation facing N – scale 1m.
- 35 – View of trench upon excavation facing N – scales 1m.
- 36 – View of electricity trench for house upon excavation facing W.

Appendix 2 – Context Register

- 100 – Light brown sandy topsoil
- 101 – Grey-green brown fill of pit
- 102 – Cut of small pit
- 200 - Light brown sandy topsoil
- 201 – light yellow brown fill of cut
- 202 – irregular shaped cut
- 600 - Light brown sandy topsoil
- 601 – Stone filled round pit with light brown fill
- 602 – Cut of possible pit
- 900 - Light brown sandy topsoil
- 901 – Stone filled pit
- 902 – cut of pit

Appendix 3 – Flint Catalogue

Context 101 (pit)

CAT 1) Uncorticated scraper-edge fragment, marbled light/dark grey flint. The piece has fine dorsal retouch along the break suggesting use after fragmentation. 30 x 12 x 5 mm.

CAT 2) Tertiary bipolar flake, honey-brown flint. 31 x 14 x 8 mm.

Context 201 (pit)

CAT 3) Secondary bipolar flake with bilateral use-wear, light olive-green flint. 35 x 30 x 11 mm.

CAT 4) Trimmed, tertiary hard-hammer flake, light olive-green flint. 14 x 19 x 3 mm.

CAT 5) Tertiary bipolar flake, honey-brown flint. 41 x 18 x 13 mm.

CAT 6) Trimmed, tertiary hard-hammer flake with use-wear on right lateral side, honey-brown flint. 27 x 24 x 8 mm.

CAT 7) Untrimmed, tertiary hard-hammer flake with distal notch, honey-brown flint. 26 x 17 x 9 mm.

CAT 8) Untrimmed, secondary hard-hammer flake, honey-brown flint. 26 x 15 x 6 mm.

CAT 9) Trimmed, tertiary hard-hammer flake, honey-brown flint. Left lateral side broken off. 13 x 21 x 5 mm.

CAT 10) Untrimmed, secondary hard-hammer flake, honey-brown flint. Distal end broken off. 17 x 11 x 3 mm.

CAT 11) Trimmed, secondary indeterminate platform flake, honey-brown flint. 12 x 11 x 5 mm.

CAT 12) Untrimmed, tertiary hard-hammer flake, honey-brown flint. 13 x 13 x 3 mm.

CAT 13) Trimmed, secondary hard-hammer flake, honey-brown flint. 12 x 9 x 2 mm.

CAT 14) Tertiary bipolar flake, honey-brown flint. 13 x 6 x 1 mm.

CAT 15) Corticated chip, detached by the application of platform technique, honey-brown flint. Greatest dimension ≤ 10 mm.