

61 West High Street, Inverurie, Aberdeenshire, AB51 3QQ
Report on a Watching Brief
Cameron Archaeology CA347-2017



Dr Robert Lenfert
Cameron Archaeology
24-05-17

CONTENTS

1	BACKGROUND	3
2	ARCHAEOLOGICAL BACKGROUND	4
3	THE WATCHING BRIEF.....	5
4	CONCLUSIONS.....	5
5	REFERENCES.....	7
6	ACKNOWLEDGEMENTS	7
	APPENDIX 1 ARCHAEOLOGICAL SITES WITHIN 1KM	8
	APPENDIX 2 MAPS.....	12
	APPENDIX 3 PHOTOS.....	14

ILLUSTRATIONS

COVER: general view of the site facing NE

Illus 1	Location plan.....	3
Illus 2	Site plan showing proposed development.....	4
Illus 3	Stratigraphy along eastern boundary of groundworks.....	5
Illus 4	Site plan showing proposed development.....	6
Illus 5	First Edition OS map showing site outline in red.....	12
Illus 6	Second Edition OS map showing site outline in red.....	13
Illus 7	Third Edition OS map showing site outline in red.....	14

SUMMARY

On May 22nd and 23rd, 2017, a watching brief took place at 61 West High Street, Inverurie, Aberdeenshire in advance of construction of a retail and residential structure on an undeveloped lot. No archaeological finds or features were noted and it is therefore recommended that no further archaeological work is required during the current planning application.

1 BACKGROUND

- 1.1 The site (Illus 1, 2) is located on the south side of West High St (B9170) between Victoria St and Chelsea Rd. It is centred on NGR NJ77247 21623, at 55-60m OD in the parish of Inverurie.
- 1.2 The work was commissioned by Emma McIntosh, R&B Joinery. An application 2016/1372 to Aberdeenshire Council for erection of a café bar and 4 flats was passed on 7 April 2017 with an archaeology condition (condition 1) and a requirement for a watching brief during all ground disturbance.
- 1.3 All the archaeological work was carried out in the context of Scottish Planning Policy (SPP) Planning Advice Note (PAN 2/2011) and Historic Environment Scotland's Policy Statement (HESPS) which state that archaeological remains should be regarded as part of the environment to be protected and managed.

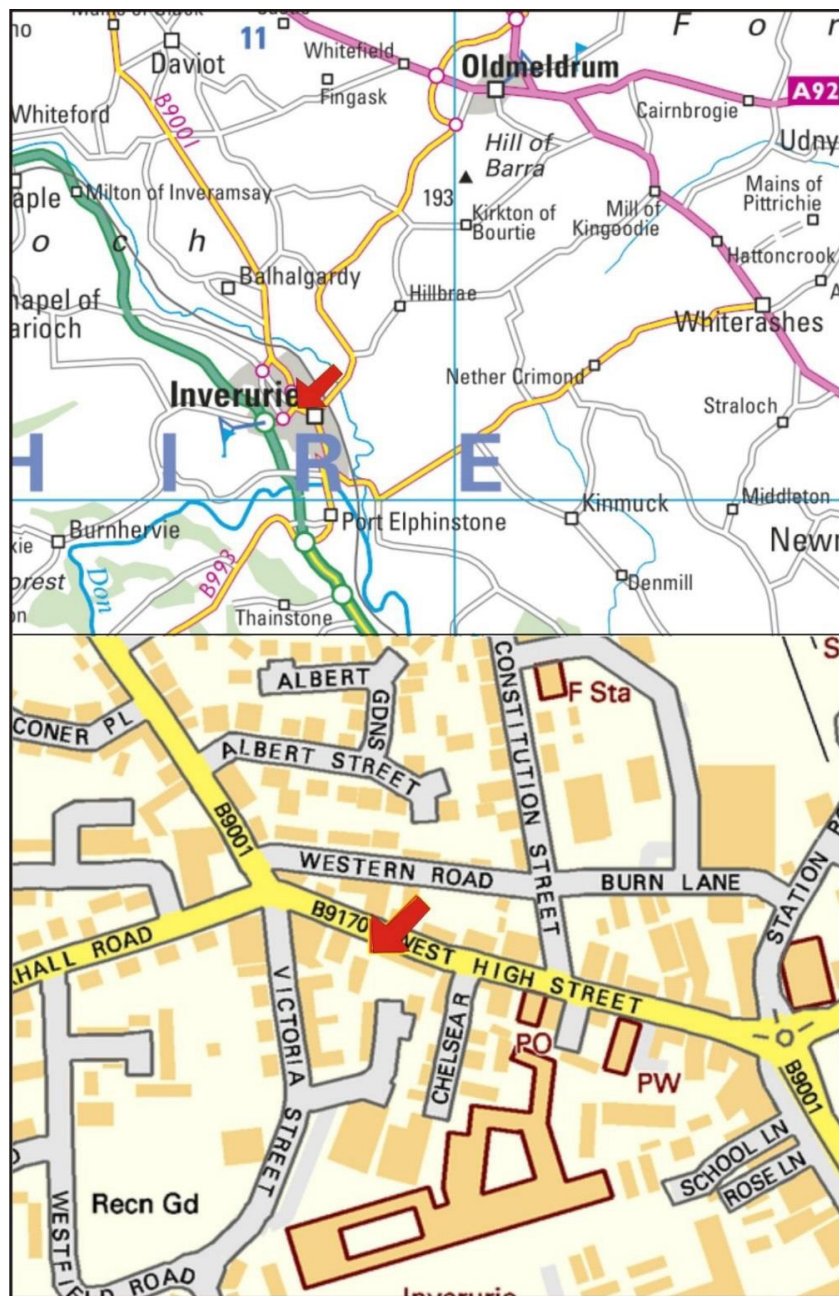

Illus 3 Location plan (Contains Ordnance Survey data © Crown copyright and database right 2017)

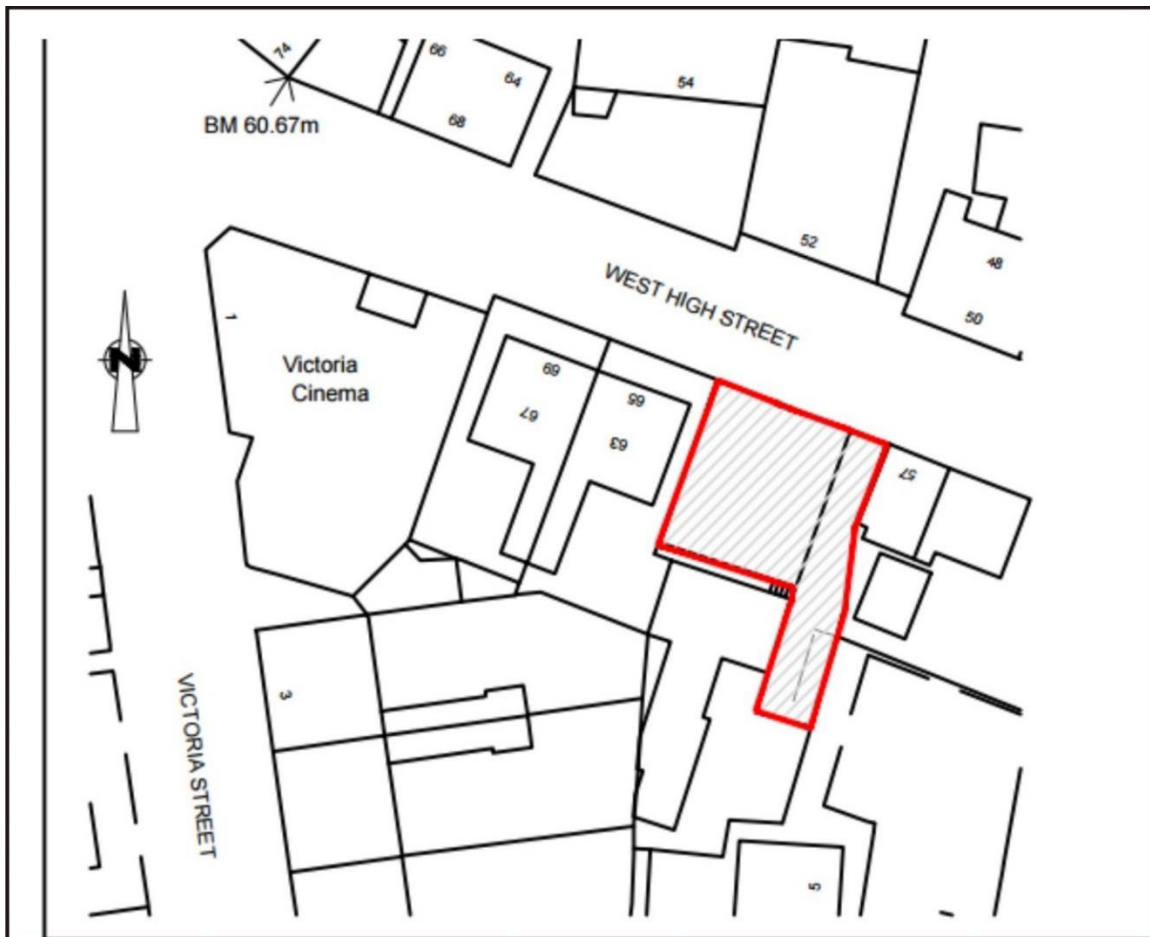

Illus 4 Site plan showing proposed development (*copyright wcp architects*)

2 ARCHAEOLOGICAL BACKGROUND

- 2.1 There are no Scheduled Monuments within 1km of, and no archaeological or historic sites within, the boundary of the proposed development. The site has formed the front garden of Broomfield Cottage on the First Edition OS map (Illus 4) and remains a garden or open undeveloped sites until the present maps (Illus 5-6).
- 2.2 Inverurie is a 'lang toon' squeezed between the meanders of the Urie as it nears its confluence with the Don and the low, rolling hills of the Garioch (in the words of the 'Inverurie Poet', William Thom, ... 'whaur creepin Ury greets its mountain cousin Don'). It began as a swampy medieval caput, its motte-and-bailey castle now split and tonsured in the cemetery. Across the Don, Port Elphinstone (named after Robert Elphinstone of Logie) was the terminus of the Aberdeen Canal (1807-54) and saw the real lift-off of Inverurie. It is an entrepot and banking centre for the agricultural expansion of the Garioch, the grain giral of Aberdeenshire, an important stop on the new turnpike, communications became enshrined in its now defunct railway works, which are still visible (Harlaw Road). It is now a thriving, bustling market town of some 19th-century grace at its centre and considerable oil-related expansion to the north. The main industries are farming, industry and oil, a blend which epitomises eastern Aberdeenshire life at the beginning of the 21st century (Shepherd 2006).
- 2.3 100m to the south of the proposed development human remains were found in this area prior to 1866 by workmen while carting sand (HER NJ72SE0031). They were thought to be remains of an executed criminal (OSNB 1866, No42, 73). There have been no recent finds in area.

- 2.4 The area of the proposed development is occupied by 19th to 20th-century buildings including the Post office at 33 West High St (HES NJ72SE 208), the west Parish Church (HES NJ72SE 143), the Gordon Arms Hotel (HES NJ72SE 335), Northburn House (HES NJ72SE 185) and the War Memorial (HES NJ72SE 289).

3 THE WATCHING BRIEF

On May 22nd and 23rd, 2017 a watching brief took place during groundworks in advance of a proposed development (Illus 3) at 61 West High Street, Inverurie. The lot measures approximately 10x14m and has remained undeveloped since at least the 1st edition OS map in 1869 (Illus 4). Soil stripping was carried out with a 6-ton excavator using a bladed bucket. Despite the parcel of land being undeveloped, the topsoil layer was extremely thin throughout, (less than 10cm average) with a considerable component of imported fine gravels (c. 30%). Below the topsoil layer, a clean fine yellowish-brown sandy subsoil was present throughout, within isolated areas of reddish-brown sandy-silt lenses. Very few stones or gravels were present in the subsoil, which remained homogenous throughout the maximum depths encountered (0.5m to 0.8m).

4 CONCLUSIONS

Although the lot has remained undeveloped for at least 150 years, while also being located within the historical 'lang toon' of Inverurie, the subsoil was remarkably sterile with no traces of any human activity or artefactual deposition. One modern sherd of unmarked white ceramic was noted in the topsoil/subsoil interface, while no other archaeological finds or features were noted. and it is therefore recommended that no further archaeological work is required during the current planning application.



Illus 3 Stratigraphy along eastern boundary of groundworks.

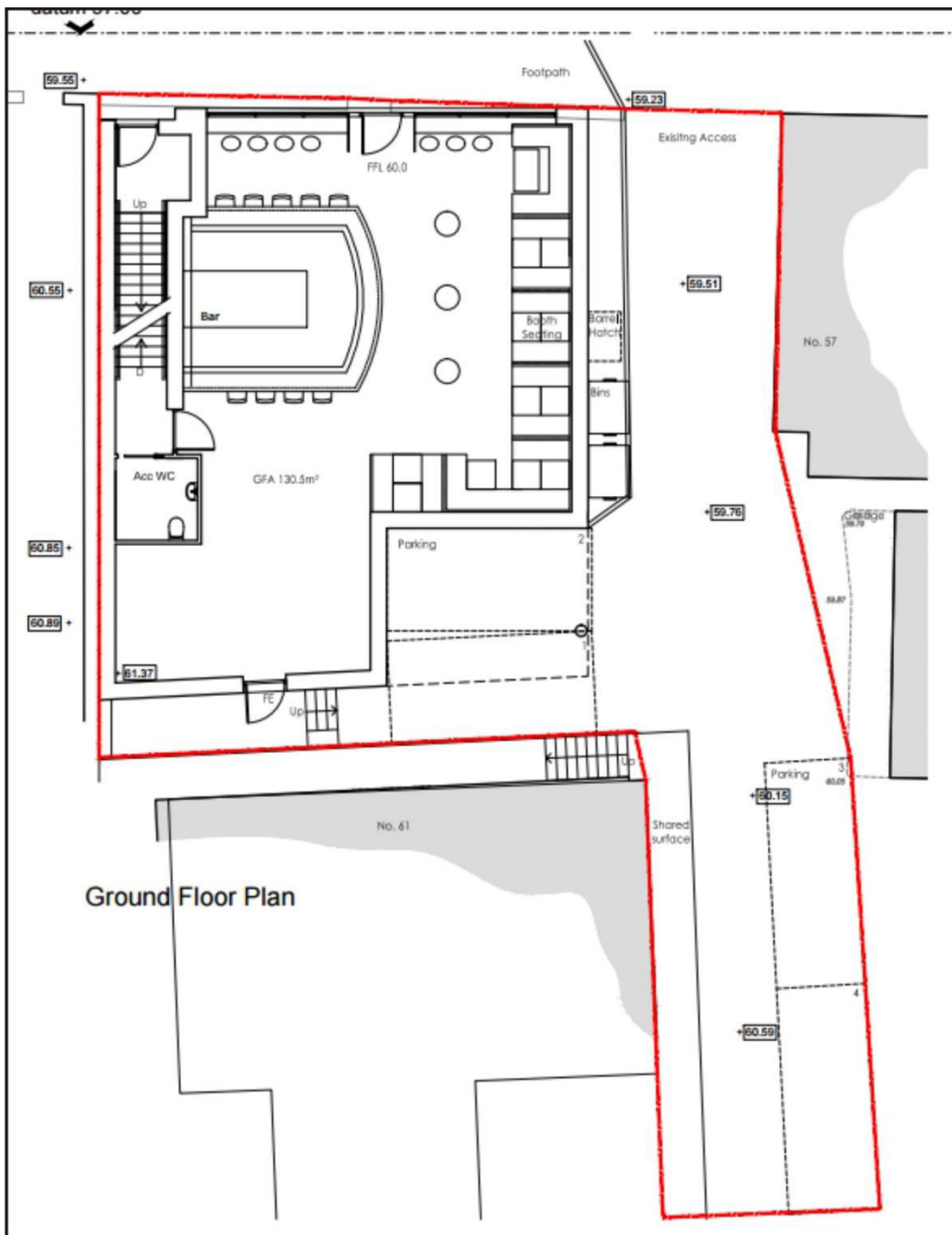

Illus 4 Site plan showing proposed development (copyright wcp architects)

5 REFERENCES

Ordnance Survey (Name Book. *Object Name Books of the Ordnance Survey (6 inch and 1/2500 scale)*).

Shepherd, IAS, 2006. "Aberdeenshire: Donside and Strathbogie - An Illustrated Architectural Guide".

6 ACKNOWLEDGEMENTS

Thanks to Emma McIntosh R&B Joinery (Grampian) Ltd for initiating this project and to Claire Herbert, Aberdeenshire Council Archaeology Service for her advice during this work.

APPENDIX 1

Archaeological and historical sites within 1km of the proposed site (HES and Aberdeenshire HER online)

Dataset	Dataset UID	Name	Details
RCAHMS	NJ 77500 21200	INVERURIE, 31-35 HIGH STREET	NO CLASS (EVENT)
RCAHMS	NJ 77410 21569	INVERURIE, WEST HIGH STREET, WEST PARISH CHURCH	CHURCH (PERIOD UNASSIGNED). ALTNAME = FREE CHURCH, WEST KIRK
RCAHMS	NJ 77578 21796	INVERURIE, STATION ROAD, INVERURIE RAILWAY STATION	RAILWAY STATION (19-20TH CENTURY)
RCAHMS	NJ 77700 21200	INVERURIE, HIGH STREET, MONUMENTAL SCULPTOR'S YARD	CRANE (PERIOD UNASSIGNED), WORKSHOP (PERIOD UNASSIGNED)
RCAHMS	NJ 78200 21850	KEITH HALL	ENCLOSURE (PERIOD UNASSIGNED). ALTNAME = KEITH HALL POLICIES, KEITHALL, SOUTERFORD
RCAHMS	NJ 77568 21394	INVERURIE, 1 HIGH STREET, CLYDESDALE BANK	BANK (FINANCIAL) (PERIOD UNASSIGNED). ALTNAME = NORTH OF SCOTLAND BANK
RCAHMS	NJ 77567 21540	INVERURIE, MARKET PLACE, 1-4 CROSSLETT COURT	HOUSE (18TH CENTURY). ALTNAME = 30, 32 MARKET PLACE
RCAHMS	NJ 77583 21607	INVERURIE, PORT ROAD, NORTHBURN	HOUSE (19TH CENTURY)
RCAHMS	NJ 77391 21612	INVERURIE, 26 WEST HIGH STREET, CLYDESDALE BANK	BANK (FINANCIAL) (PERIOD UNASSIGNED). ALTNAME = 1 CONSTITUTION STREET
RCAHMS	NJ 77700 21200	INVERURIE, JOINER'S SHOP	JOINERS SHOP (PERIOD UNASSIGNED)
RCAHMS	NJ 77350 21590	INVERURIE, 33 WEST HIGH STREET, POST OFFICE	POST OFFICE (19-20TH CENTURY)
RCAHMS	NJ 76430 21770	MIDDLEMUIR	COTTAGE (PERIOD UNASSIGNED), CROFT (PERIOD UNASSIGNED). ALTNAME = INVERURIE
RCAHMS	NJ 76580 21400	NETHER DAVO	COTTAGE (PERIOD UNASSIGNED), CROFT (PERIOD UNASSIGNED). ALTNAME = INVERURIE
RCAHMS	NJ 77980 21480	INVERURIE	BOUNDARY STONE (PERIOD UNASSIGNED)
RCAHMS	NJ 77990 21430	INVERURIE	BOUNDARY STONE (PERIOD UNASSIGNED)
RCAHMS	NJ 77930 21830	INVERURIE	SAND AND GRAVEL WORKINGS (PERIOD UNASSIGNED). ALTNAME = RIVER URIE
RCAHMS	NJ 77520 21850	INVERURIE, OLD MANSE	MANSE (PERIOD UNASSIGNED)

RCAHMS	NJ 77625 21337	INVERURIE, 24 HIGH STREET, MASONIC HALL	MASONIC HALL (PERIOD UNASSIGNED). ALTNAMES = FREEMASON'S HALL
RCAHMS	NJ 77540 21570	INVERURIE, MARKET PLACE, GENERAL	GENERAL VIEW
RCAHMS	NJ 77545 21531	INVERURIE, MARKET PLACE, WAR MEMORIAL	WAR MEMORIAL (20TH CENTURY)
RCAHMS	NJ 77467 21582	INVERURIE, 4-10 WEST HIGH STREET	TERM PENDING
RCAHMS	NJ 77568 21545	INVERURIE, 30 MARKET PLACE	TERM PENDING
RCAHMS	NJ 77579 21500	INVERURIE, 42 MARKET PLACE	TERM PENDING
RCAHMS	NJ 76500 22000	INVERURIE, OLD CHAPEL ROAD	POLISHED AXEHEAD (STONE)
RCAHMS	NJ 78000 22000	LOFTHILLOCK	FOOD VESSEL. ALTNAMES = LOFTHILLOCK, HILL OF SELBIE
RCAHMS	NJ 77380 21570	INVERURIE, GENERAL	BURGH (MEDIÆVAL), TOWN (PERIOD UNASSIGNED)
RCAHMS	NJ 77700 21680	INVERURIE, SOUTERFORD ROAD, GASWORKS	GAS WORKS (19-20TH CENTURY). ALTNAMES = INVERURIE GASWORKS
RCAHMS	NJ 77520 21600	INVERURIE MUSEUM	MUSEUM (19-20TH CENTURY)
RCAHMS	NJ 77740 21820	INVERURIE, SOUTERFORD ROAD, HAND CRANE	CRANE (PERIOD UNASSIGNED)
RCAHMS	NJ 77610 21340	INVERURIE, 24 HIGH STREET, FREEMASONS' HALL, SCULPTURED STONE	CROSS INCISED STONE (EARLY MEDIÆVAL)
RCAHMS	NJ 76740 21420	INVERURIE, BLACKHALL ROAD	POLISHED AXEHEAD (STONE)
RCAHMS	NJ 77250 21510	INVERURIE, VICTORIA STREET	HUMAN REMAINS (PERIOD UNASSIGNED)
RCAHMS	NJ 78000 22000	LOFTHILLOCK	BARBED AND TANGED ARROWHEAD(S) (FLINT). ALTNAMES = LOFTHILLOCK, INVERURIE, LOFTHILL, KEITHHALL
RCAHMS	NJ 78000 22000	LOFTHILLOCK	AXEHEAD (FLINT)
RCAHMS	NJ 76550 21770	INVERURIE, 'PARADISE COTTAGE'	AXEHEAD (STONE)
RCAHMS	NJ 78000 22000	LOFTHILLOCK	SPINDLE WHORL(S)
RCAHMS	NJ 78000 22000	LOFTHILLOCK	ARROWHEAD (FLINT), LEAF ARROWHEAD(S) (FLINT)
RCAHMS	NJ 76600 21600	INVERURIE, RUTHERFORD FOLDS	TERM PENDING. ALTNAMES = KINTORE ESTATES

RCAHMS	NJ 76880 21340	INVERURIE, SAND PIT	SAND AND GRAVEL WORKINGS (PERIOD UNASSIGNED). ALTNAME = FIRHOLME PLACE
RCAHMS	NJ 77540 21500	INVERURIE, 64 MARKET PLACE, MCCOMBIE AND MENNIE ARCHITECTS	TERM PENDING
RCAHMS	NJ 77575 21526	INVERURIE, MARKET PLACE, 5, 6, 9, 10 CROSSLETT COURT	HOUSE (18TH CENTURY). ALTNAME = 34, 36 MARKET PLACE
RCAHMS	NJ 77578 21512	INVERURIE, MARKET PLACE, 7, 8, 11, 12 CROSSLETT COURT	HOUSE (18TH CENTURY). ALTNAME = 38, 40 MARKET PLACE
RCAHMS	NJ 77347 22020	INVERURIE, HARLAW ROAD, GREAT NORTH OF SCOTLAND LOCOMOTIVE WORKS, WORKS BUILDING WITH SMITHY, FURNACE AND FOUNDRY	FOUNDRY (PERIOD UNASSIGNED), FURNACE (PERIOD UNASSIGNED), SMITHY (PERIOD UNASSIGNED)
RCAHMS	NJ 77250 21979	INVERURIE, HARLAW ROAD, GREAT NORTH OF SCOTLAND LOCOMOTIVE WORKS, MANAGER'S DRAWING OFFICE	OFFICE (PERIOD UNASSIGNED). ALTNAME = WORKS MANAGER'S OFFICE
RCAHMS	NJ 77265 22025	INVERURIE, HARLAW ROAD, GREAT NORTH OF SCOTLAND LOCOMOTIVE WORKS, WORKSHOP	WORKSHOP (PERIOD UNASSIGNED)
RCAHMS	NJ 77491 21524	INVERURIE, 21 MARKET PLACE, ROYAL BANK OF SCOTLAND	BANK (FINANCIAL) (PERIOD UNASSIGNED)
RCAHMS	NJ 77588 21458	INVERURIE, 54-58 MARKET PLACE	COMMERCIAL PREMISES (19TH CENTURY). ALTNAME = 56 MARKET PLACE
RCAHMS	NJ 77597 21401	INVERURIE, 2-6 HIGH STREET	COMMERCIAL PREMISES (19TH CENTURY). ALTNAME = 4 HIGH STREET, STRONACHS
RCAHMS	NJ 77489 21583	INVERURIE, MARKET PLACE, GORDON ARMS HOTEL	HOTEL (PERIOD UNASSIGNED). ALTNAME = 2 WEST HIGH STREET
RCAHMS	NJ 77617 21432	INVERURIE, 1-3 WALLACE ROAD	SHELTERED HOUSING (MODERN). ALTNAME = SHELTERED HOUSING
RCAHMS	NJ 77391 21581	INVERURIE, 17-25 WEST HIGH STREET	SHOP(S) (19TH CENTURY)
RCAHMS	NJ 77345 21626	INVERURIE, 30 WEST HIGH STREET, JOHNSTON AND CARMICHAEL'S OFFICES	COMMERCIAL OFFICE (PERIOD UNASSIGNED). ALTNAME = CONSTITUTION STREET
RCAHMS	NJ 76601 21480	INVERURIE, BLACKHALL ROAD, GORDON HOUSE, GORDON DISTRICT COUNCIL H.Q.	LOCAL GOVERNMENT OFFICE (20TH CENTURY)
RCAHMS	NJ 77633 21447	INVERURIE, 5, 7, 9, 11 WALLACE ROAD	SHELTERED HOUSING (MODERN). ALTNAME = SHELTERED HOUSING
RCAHMS	NJ 77451 21875	INVERURIE, CONSITUTION STREET, INVERURIE DELIVERY OFFICE	POST OFFICE (19-20TH CENTURY). ALTNAME = ROYAL MAIL LETTER-DELIVERY OFFICE

RCAHMS	NJ 77150 21627	INVERURIE, 7, 9, 11 BLACKHALL ROAD	HOUSE(S) (20TH CENTURY), HOUSING ESTATE (20TH CENTURY)
RCAHMS	NJ 77120 21619	INVERURIE, 13, 15, 17 BLACKHALL ROAD	HOUSE(S) (20TH CENTURY), HOUSING ESTATE (20TH CENTURY)
RCAHMS	NJ 77097 21613	INVERURIE, 19, 21, 23 BLACKHALL ROAD	HOUSE(S) (20TH CENTURY), HOUSING ESTATE (20TH CENTURY)
RCAHMS	NJ 77077 21604	INVERURIE, 25, 27, 29 BLACKHALL ROAD	HOUSE(S) (20TH CENTURY), HOUSING ESTATE (20TH CENTURY)
RCAHMS	NJ 77030 21631	INVERURIE, 20, 22, 24 BLACKHALL ROAD	HOUSE(S) (20TH CENTURY), HOUSING ESTATE (20TH CENTURY)
RCAHMS	NJ 77006 21622	INVERURIE, 26, 28, 30 BLACKHALL ROAD	HOUSE(S) (20TH CENTURY), HOUSING ESTATE (20TH CENTURY)
RCAHMS	NJ 77296 21711	INVERURIE, ALBERT STREET, GARIOCH COURT HOUSING	HOUSE(S) (20TH CENTURY). ALTNAME = 22-32
RCAHMS	NJ 77827 21894	INVERURIE, OLDMELDRUM ROAD, 1 AND 3 BUSINESS PARK	OFFICE (20TH CENTURY), TIMBER PRODUCT SITE (20TH CENTURY)
RCAHMS	NJ 77533 21566	INVERURIE, MARKET PLACE, FOUNTAIN	FOUNTAIN (PERIOD UNASSIGNED). ALTNAME = THE SQUARE
RCAHMS	NJ 77500 21325	INVERURIE, JACKSON STREET, WYNESS HALL	DRILL HALL (20TH CENTURY), DRILL HALL (FIRST WORLD WAR). ALTNAME = DRILL HALL
RCAHMS	NJ 77600 21500	INVERURIE, 63 MARKET PLACE	NO CLASS (EVENT)
HERABER	NJ72SE0059	LOFTYHILLOCK	
HERABER	NJ72SE0070	LOFTYHILLOCK	
HERABER	NJ72SE0081	LOFTHILLOCK	
HERABER	NJ72SE0103	RAILWAY WORKS, INVERURIE	
HERABER	NJ72SE0104	INVERURIE STATION	
HERABER	NJ72SE0111	LOFTHILLOCK	
HERABER	NJ72SE0114	KEITH HALL	
HERABER	NJ72SE0160	INVERURIE TOWN HALL	
HERABER	NJ72SE0162	SOUTERFORD ROAD, INVERURIE	
HERABER	NJ72SE0188	WEST PARISH CHURCH, WEST HI...	
HERABER	NJ72SE0206	SOUTERFORD	
HERABER	NJ72SE0212	KEITH HALL	
HERABER	NJ72SE0225	URYSIDE	
HERABER	NJ72SE0016	FREEMAN'S HALL	
HERABER	NJ72SE0026	BLACKHALL ROAD	
HERABER	NJ72SE0031	INVERURIE	
HERABER	NJ72SE0107	INVERURIE	
HERABER	NJ72SE0128	INVERURIE WAR MEMORIAL	
HERABER	NJ72SE0196	HIGH STREET, INVERURIE	
HERABER	NJ72SE0159	INVERURIE	

HERABER	NJ72SE0161	61 HIGH STREET, INVERURIE	
HERABER	NJ72SE0176	63 MARKET PLACE	
HERABER	NJ72SE0177	HARLAW ROAD	
HERABER	NJ72SE0182	31-35 HIGH STREET	
HERABER	NJ72SE0153	OLD CHAPEL ROAD, INVERURIE	
HERABER	NJ72SE0305	WYNESS HALL, INVERURIE	
HERABER	NJ72SE0307	GORDON HOUSE, INVERURIE	
HERABER	NJ72SE0301	INVERURIE GOLF CLUB	

APPENDIX 2 MAPS

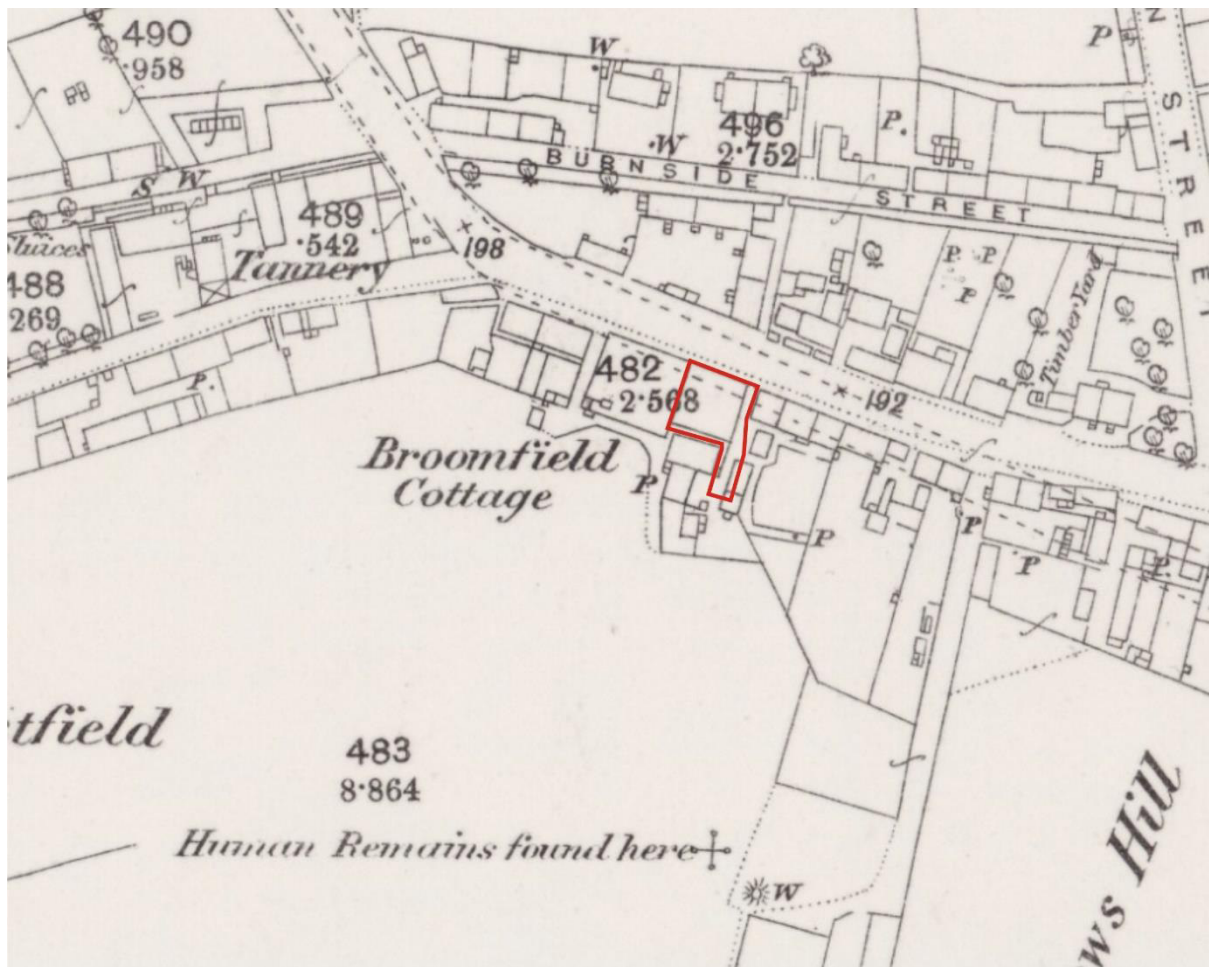

Illus 5 First Edition OS map showing site outline in red (*copyright National Library of Scotland*) Aberdeen Sheet LIV.8 (Combined) Survey date: 1867 Publication date: 1869

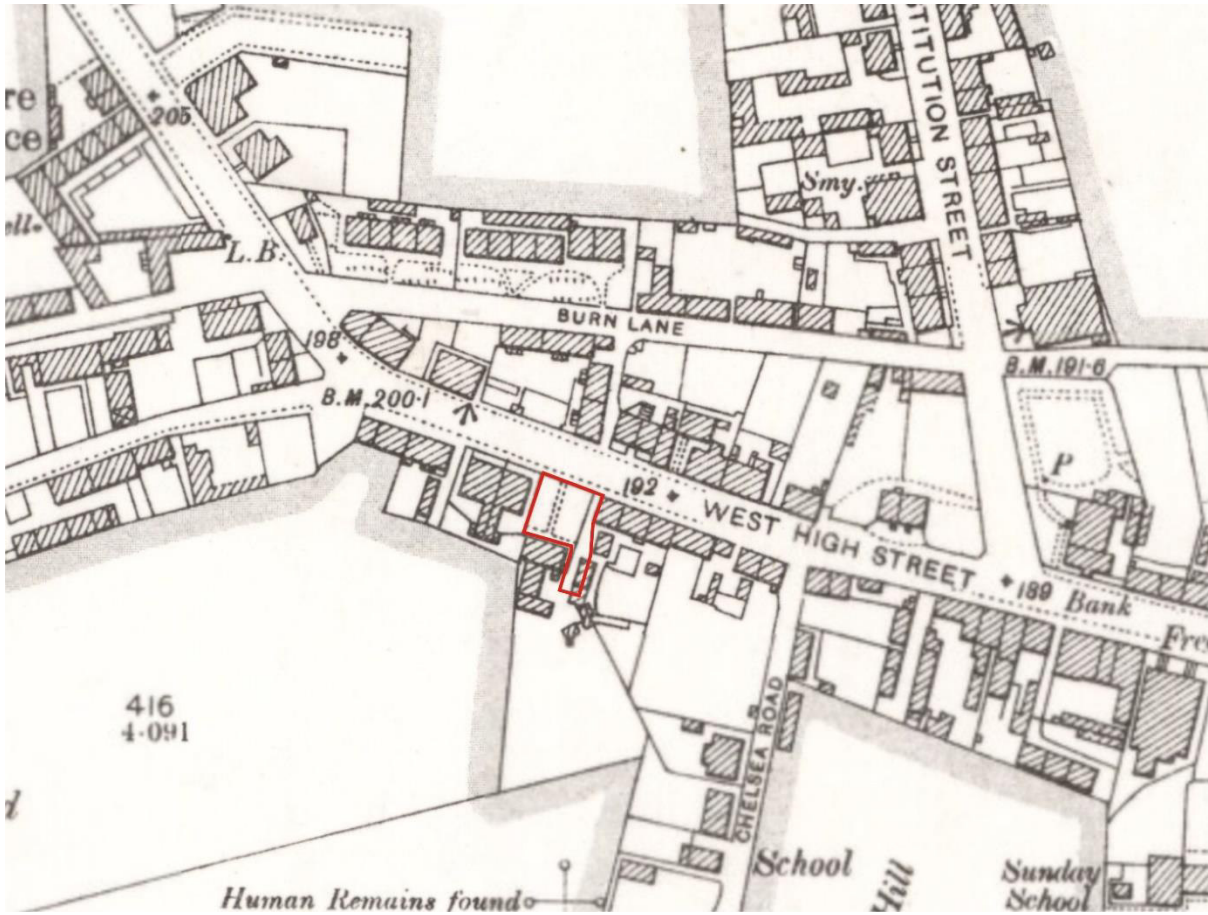

Illus 6 Second Edition OS map showing site outline in red (copyright National Library of Scotland) Aberdeenshire 054.08 (includes: Inverurie) Publication date: 1900 Revised: 1899

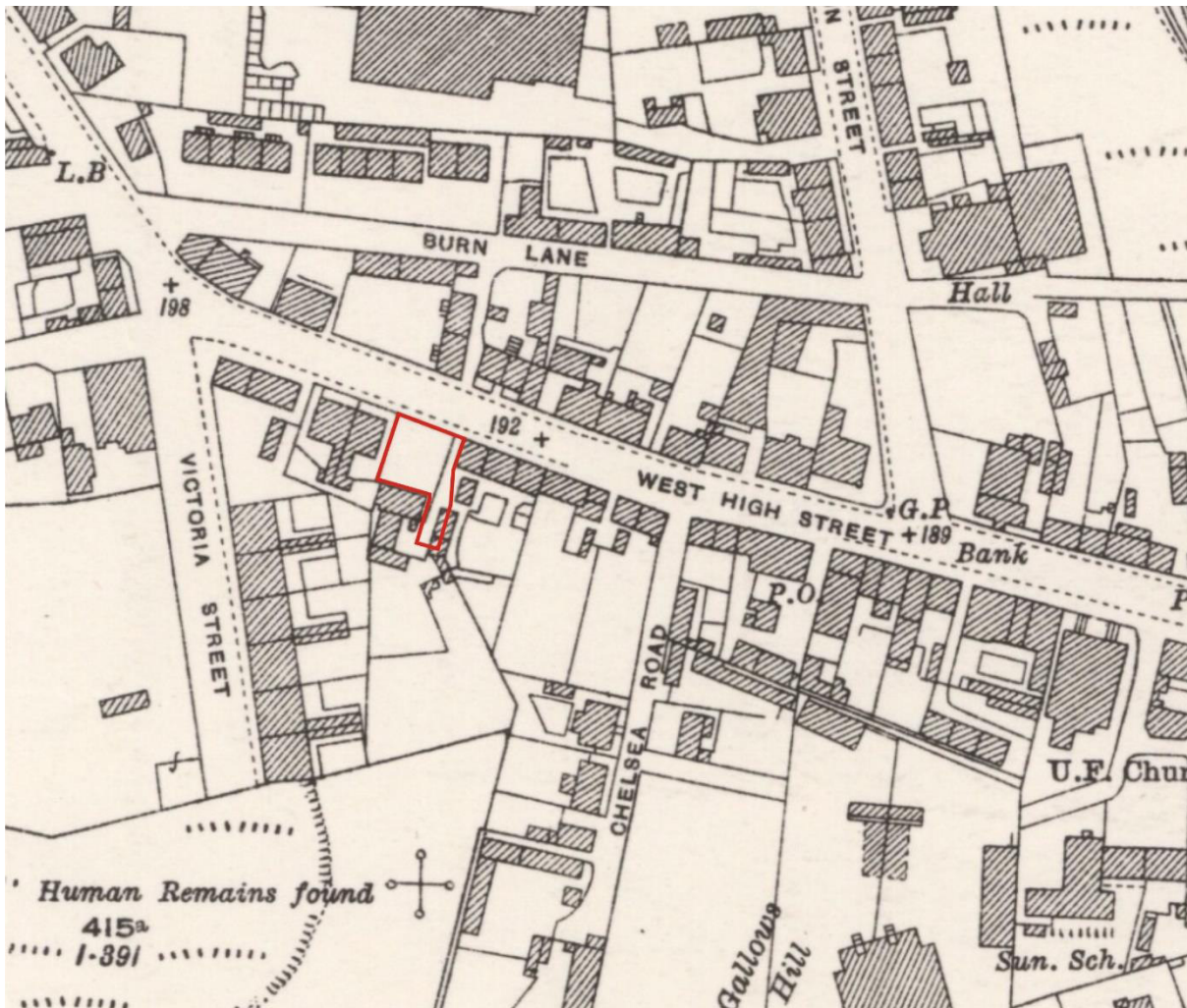

Illus 7 Third Edition OS map showing site outline in red (*copyright National Library of Scotland*) Aberdeenshire 054.08 (includes: Inverurie) Publication date: 1926 Revised: 1924 Levelled: 1899

APPENDIX 3 PHOTOS

Photo ID	Direction Facing	Comments
DSC2030	SW	Soil strip underway
DSC2032	WNW	Soil strip in relation to retaining wall on W side of development
DSC2033	S	Mid-brown sandy-silt lens with subsoils
DSC2037	ESE	Soil strip along front of lot underway
DSC2040	NNE	Soil strip underway
DSC2041	NE	General view of site
DSC2043	W	NW corner of site during groundworks
DSC2045	NW	NW corner of site during groundworks
DSC2046	N	NW corner of site during groundworks
DSC2047	S	SW corner of site during groundworks
DSC2048	SW	Remaining spoil before loading onto dumper truck.
DSC2059	E	View of stratigraphy along E edge of site
DSC2061	N	Site during removal of spoil heap, nearing completion. Note thin lens of topsoil overlain by imported gravels.



_DSC2030.JPG



_DSC2032.JPG



_DSC2033.JPG



_DSC2037.JPG



_DSC2040.JPG



_DSC2041.JPG



_DSC2043.JPG



_DSC2045.JPG



_DSC2046.JPG



_DSC2047.JPG



_DSC2048.JPG



_DSC2059.JPG



_DSC2061.JPG